

No. 889,658.

PATENTED JUNE 2, 1908.

S. L. BURNAUGH, JR.

FOLDING GUN REST.

APPLICATION FILED MAY 28, 1907.

2 SHEETS—SHEET 1.

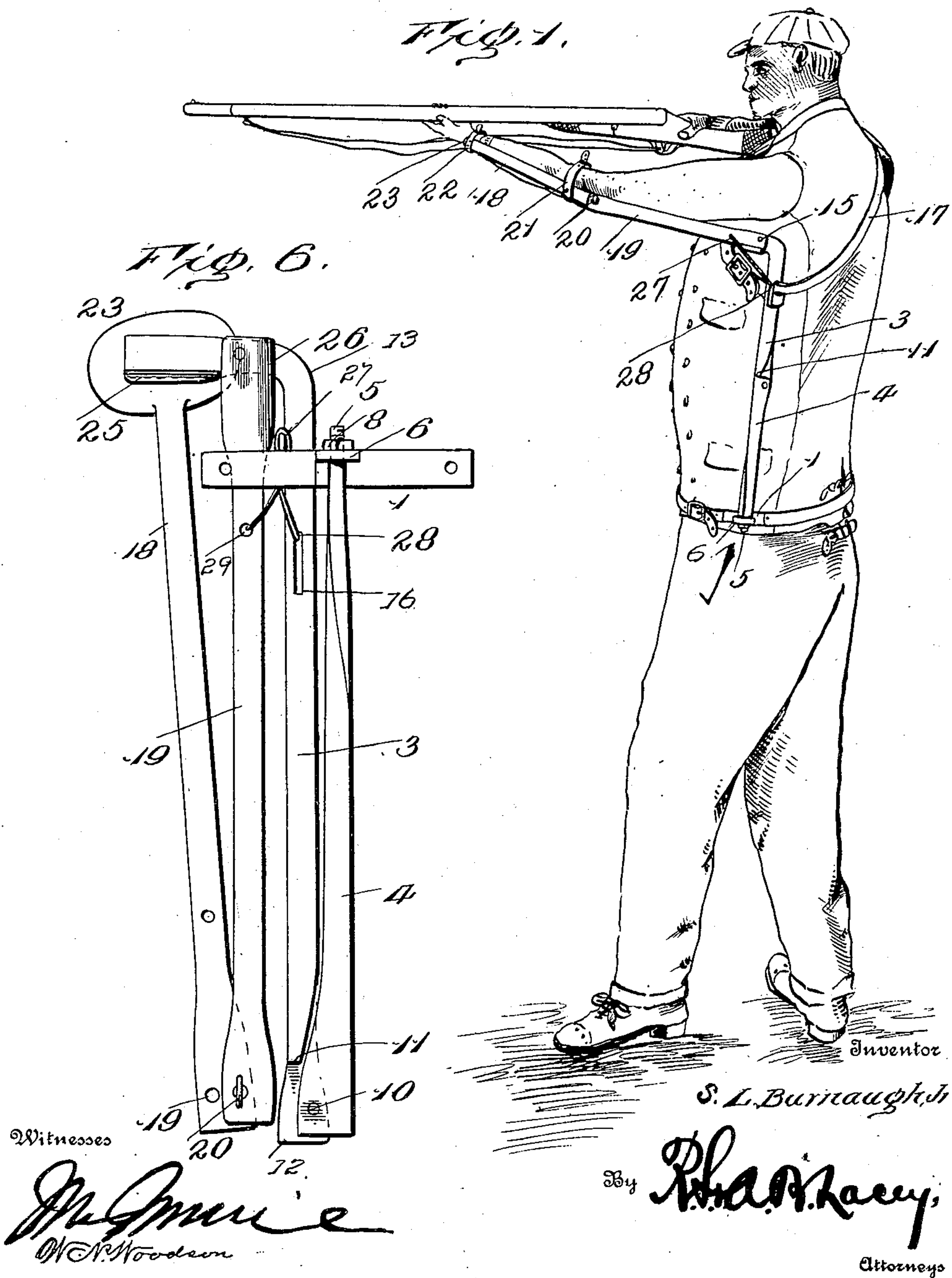

No. 889,658.

PATENTED JUNE 2, 1908.

S. L. BURNAUGH, JR.

FOLDING GUN REST.

APPLICATION FILED MAY 28, 1907.

2 SHEETS—SHEET 2.

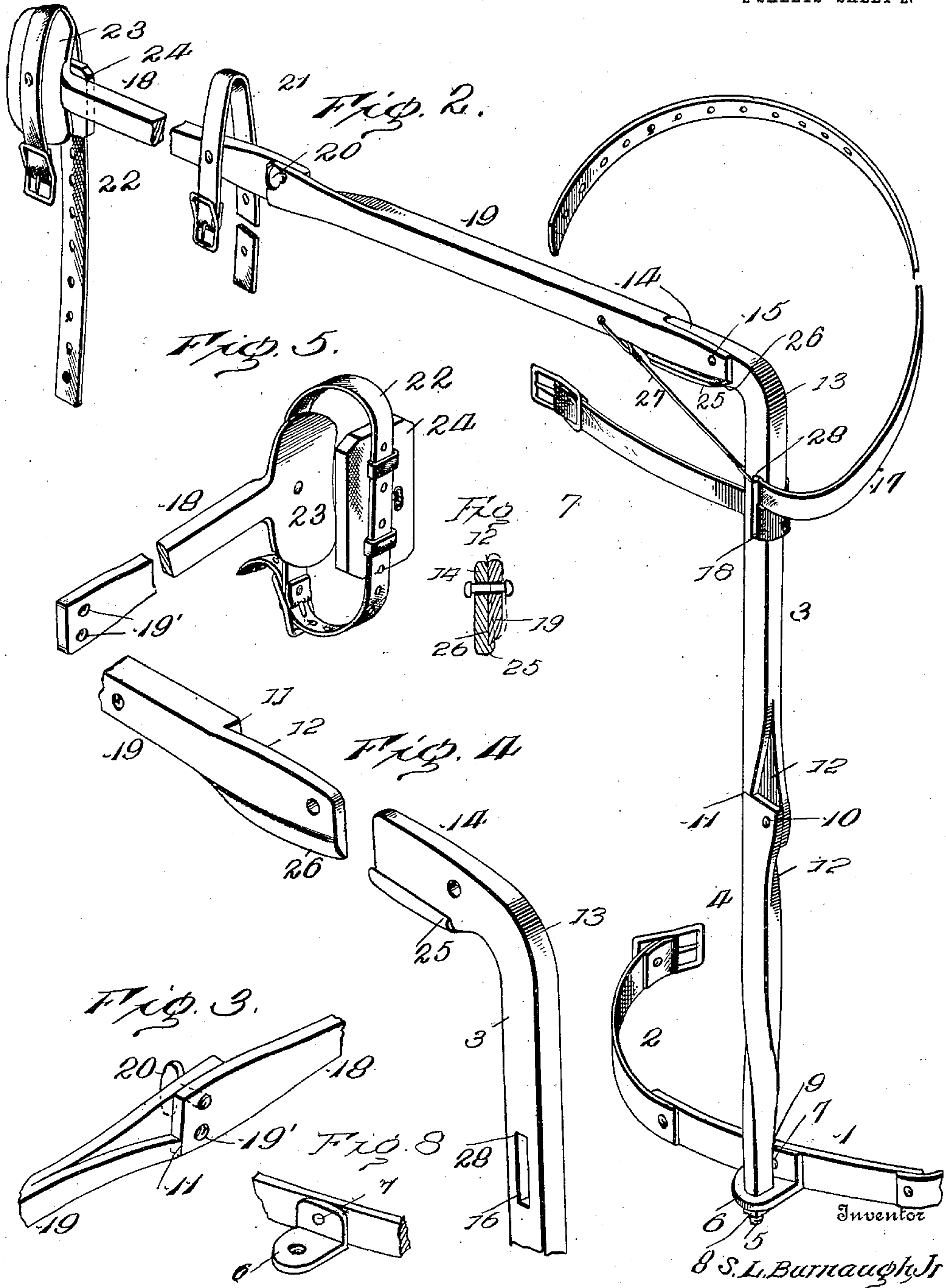

Witnesses

W. J. Woodson

By

R. H. R. R. R.

Attorneys

UNITED STATES PATENT OFFICE.

SAMUEL L. BURNAUGH, JR., OF ENTERPRISE, OREGON.

FOLDING GUN-REST.

No. 889,658.

Specification of Letters Patent.

Patented June 2, 1908.

Application filed May 28, 1907. Serial No. 376,185.

To all whom it may concern:

Be it known that I, SAMUEL L. BURNAUGH, Jr., a citizen of the United States, residing at Enterprise, in the county of Wallowa and State of Oregon, have invented certain new and useful Improvements in Folding Gun-Rests, of which the following is a specification.

This invention provides novel means to be attached to the body for supporting and steadying a fire arm when taking aim, thereby materially assisting in hitting the mark, since the gun may be held in firing position for a longer time without producing fatigue or nervousness which would tend to prevent accurate aim.

The invention has for its object to produce a rest or support of the character aforesaid which may be readily secured to the person without interfering with the free movements of the arm and body and which when not required for immediate use may be folded into compact form for convenience of handling or storing so as to occupy a minimum amount of space.

For a full description of the invention and the merits thereof and also to acquire a knowledge of the details of construction and the means for effecting the result, reference is to be had to the following description and accompanying drawings.

While the invention may be adapted to different forms and conditions by changes in the structure and minor details without departing from the spirit or essential features thereof, still the preferred embodiment is shown in the accompanying drawings, in which:

Figure 1 is a perspective view showing the application of the invention. Fig. 2 is a perspective view of the device extended and as it will appear when arranged for service. Fig. 3 is a detail view of the joint between the members of the arm sections. Fig. 4 is a detail view of the joint between the arm and body sections. Fig. 5 is a detail perspective view of the outer member of the arm section. Fig. 6 is a detail view showing the appliance folded, the several straps being omitted to avoid confusion. Fig. 7 is a detail section of the joint formed between the arm and body sections, the dotted lines showing the lateral movement of the arm section to disengage its pivot end from the supporting and interlock-

ing lip of the body section. Fig. 8 is a detail view showing more clearly the connecting means between the body and hip sections.

Corresponding and like parts are referred to in the following description and indicated in all the views of the drawings by the same reference characters.

The rest or support comprises a hip section 1 which consists of a plate or strip adapted to engage the body at a point over the hip and which is secured in place by means of a waist strap 2. This hip section may be padded, if desired, so as to obviate injurious pressure upon the body. The body section comprises an upper member 3 and a lower member 4, the two members being jointed and limited in their movement when extended. The lower member 4 is connected with the hip section by means of a swivel joint and for this purpose its lower end is reduced as shown at 5 and passes through a lug 6 pivotally connected at 7 to the hip section, the lower end of the reduced part 5 projecting below the lug and threaded to receive a nut 8. The shoulder 9 formed at the base of the reduced part 5 is adapted to engage with the upper edge of the hip section and sustain the weight of the rest and limit its downward movement with reference to the hip section. The lug 6 is of bracket formation and comprises right angularly disposed wings, one of the wings being placed against the hip section 1 and secured thereto by a pivot fastening 7 and the other wing projecting outward from the hip section and apertured to receive the reduced end 5 of the lower body member 4.

The body section is adapted to turn to accommodate itself to the position of the arm according as the latter may be swung to the right or to the left, said section turning about the reduced part 5 as an axis. The body section in addition to its adaptability to turn is free to swing from right to left about the pivot fastening 7, thereby providing for a variety of movements so as not to inconvenience the gunner or limit the range of movement of the arm when handling the gun. The two members 3 and 4 are jointed and their end portions overlap and are connected by a pivot fastening 10 which may consist of a rivet, bolt or the like. The members are connected by a rule joint, whereby their opening movement is limited.

Each section is provided with a shoulder 11 which abuts against the terminal of the adjacent section and limits the opening movement of the sections.

5 The pivot fastening 10 is located near one edge of the members remote from the edge provided with shoulders 11 and each section is cut away as shown at 12, the edge corresponding with the pivot fastening 10 to admit of the members 3 and 4 folding close. 10 The upper end of the member 3 is bent to provide an elbow 13 and a short member 14 approximately at a right-angle to the member 3 and to which the arm section is pivoted at 15 15. A slot 16 is formed in the member 3 near its upper end to receive a strap 17 which is passed therethrough a number of times to prevent slipping, said strap being adapted to pass around the body and over the shoulder 20 opposite the side of the body to which the support is fitted. The strap 17 passes under one arm and over the opposite shoulder as indicated most clearly in Fig. 1, thereby securing the upper portion of the body section 25 to the trunk.

The arm section comprises members 18 and 19 which are connected by a rule joint in substantially the same manner as the body members 3 and 4. The outer member 18 is 30 reversible, thereby adapting the device to a right or a left-handed person. For this purpose, the member 18 is provided in its flattened end with two threaded openings 19, either one adapted to receive the pivot fastening which in this instance consists of a thumb screw 20. In all other respects, the joint is substantially the same as the joint 35 formed between the members 3 and 4, the members 18 and 19 being held in alinement when extended by their extremities abutting against the shoulders 11. The outer or forearm member 18 is secured to the forearm by means of straps 21 and 22, the strap 21 passing around the forearm and the strap 22 being buckled about the wrist. The outer end 45 of the member 18 is flattened and widened as shown at 23 to engage with the wrist and obviate injurious or annoying pressure thereon. A pad 24 is fitted to the wrist strap 22 to engage with the back of the wrist to relieve the 50 same of annoying and inconvenient pressure.

The arm section is pivoted to the body section by means of a fastening 15 which may consist of a rivet or analogous securing means. 55 The overlapped portions of the articulating members are widened and of such linear extent as to insure a firm and substantial joint. A lip 25 is provided at the lower edge of the member 14 and forms a shoulder to engage 60 the lower edge of the member 19 and hold the same in approximately horizontal position. The lip 25 is undercut slightly to prevent casual disengagement of the cooperating lower edge of the member 19. The lower edge of 65 the overlapped end portion of the member 19

is sharpened as shown at 26 to snugly fit the undercut portion of the lip 25 to hold the two parts in position. To engage, or disengage, the parts 26 and 25, it is necessary to elevate the member 19 a short distance to cause the 70 part 26 to clear the outer upper edge of the lip 25. The member 19 in addition to its pivotal movement is adapted to have a limited lateral play on the pivot fastening 15 to admit of the part 26 clearing the lip 25 when 75 it is required to fold the arm section upon the body section. This result is affected in practice by giving the wrist or hand a partial turn after the arm section has been raised to cause the part 26 to clear the lip 25. To prevent 80 the clothing interfering with the free operation of the parts 25 and 26, a guard 27 is provided and extends across the elbow, or angle formed between the arm and body sections. This guard 27 may consist of a cord or other 85 flexible connection, one end being secured to the body section at 28, and the other end secured to the arm section at 29 by being passed through suitable openings formed therein. 90

The several sections of the device are preferably formed of metal such as steel to insure lightness, strength and durability, the support may be fitted to either side of the 95 body according as the gunner is right-handed or left-handed, the reversibility of the outer arm section 18 admitting of such adaptation.

When the device is in position, the section 1 engages over the hip upon one side of the 100 body and the body strap 2 engages over the hip upon the opposite side. The strap 17 secures the upper portion of the body section to the trunk in the manner stated. The movement of the arm to left or right oblique 105 is provided for by the turning of the body section in the hip section, and when the arm is elevated to firing position, it is supported by the lower edge 26 of the upper arm member 19 engaging the lip 25 of the member 14 of the 110 body section, the members of the respective body and arm sections being extended or approximately in alinement with the shoulders 11 in the manner stated. As shown in Fig. 6, the device is foldable into compact form for 115 convenience of carrying or storing.

Having thus described the invention, what is claimed as new is:

1. Means to be secured to the body and arm for supporting the arm in raised or extended position, the same comprising pivotally 120 connected body and arm sections, interlocking means between the two sections for holding the arm section extended, and a flexible guard positively connected at its ends to the respective sections, and adapted to extend 125 across the angle formed between them when the arm section is raised.

2. In a support of the character specified, the combination of members having end portions flattened and adapted to overlap, one of 130

the members being provided with two openings, a pivot fastening for connecting the two members and adapted to pass through one of the two openings in the member having a
5 pair of openings according to the relative position of said member whether right or left, and each member having a shoulder to engage the extremity of the opposite member and having an edge portion cut away in line
10 with the pivot fastening to admit of the two members folding close upon each other.

3. In combination, a hip section, a body section having both swivel and pivotal connection with the hip section to admit of said
15 body section swinging laterally or being turned to any angular position, and an arm section pivotally connected with the upper portion of the body section to fold thereon, or

to be extended and interlocked therewith to support the arm in raised position. 20

4. A gun support comprising a hip section provided with means for attaching the same to the body, a bracket having pivotal connection with the hip section, a body section connected with said bracket to turn rela- 25 tively about a vertical axis and having shouldered portions to engage the wings or members of the bracket, and an arm section having pivotal connection with the body section.

In testimony whereof I affix my signature 30 in presence of two witnesses.

SAMUEL L. BURNAUGH, JR.

Witnesses:

C. M. LOCKWOOD,

W. R. HOLMES.