

No. 868,032.

PATENTED OCT. 15, 1907.

H. A. THOMSON.

CRANE.

APPLIOATION FILED JUNE 20, 1906.

2 SHEETS--SHEET 1.

*Fig. 1.*

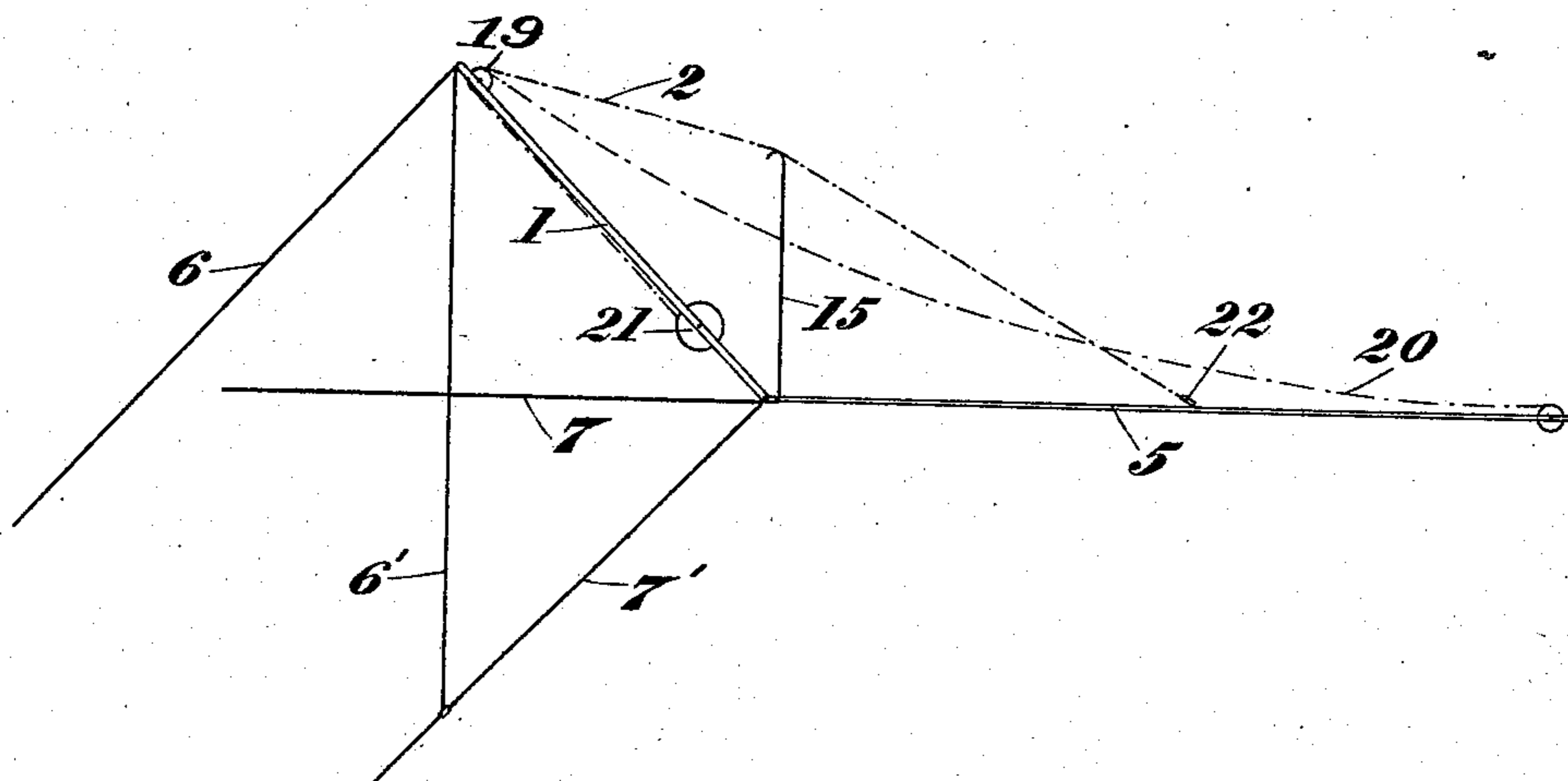

Witnesses

Chas Simpson  
F. B. Mac Neil.

Inventor

H. A. Thomson

37 ~~H. R. Thomson~~  
~~James A. Thompson~~  
~~Atty.~~

No. 868,032.

PATENTED OCT. 15, 1907.

H. A. THOMSON.

CRANE.

APPLICATION FILED JUNE 20, 1906.

2 SHEETS—SHEET 2.

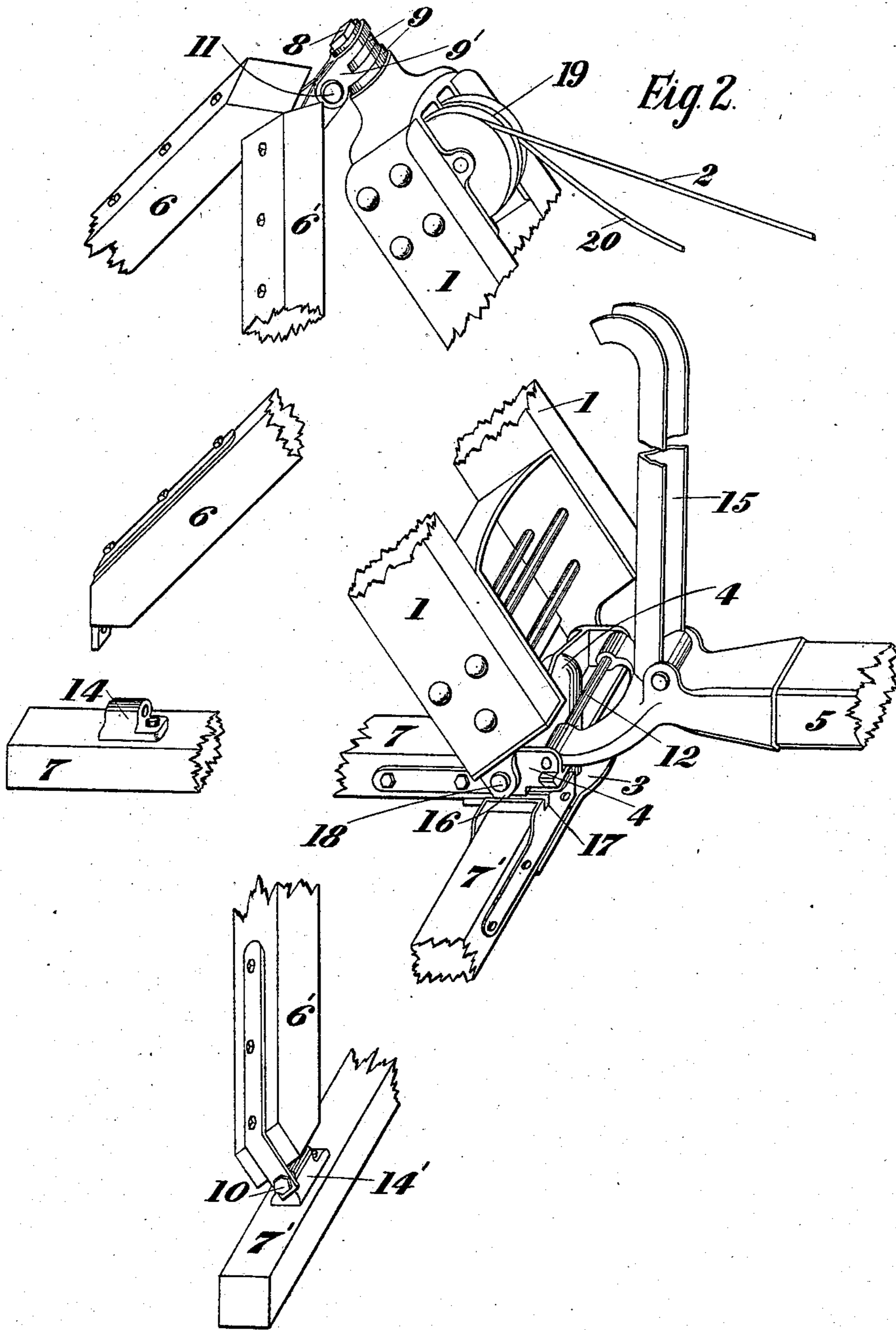

Witnesses

J. M. Buscher  
F. B. MacKall

Inventor

H. A. Thomson  
by *Charles Chandler*  
attys

# UNITED STATES PATENT OFFICE.

HUGH ALEXANDER THOMSON, OF SHAWLANDS, SCOTLAND.

## CRANE.

No. 868,032.

Specification of Letters Patent.

Patented Oct. 15, 1907.

Application filed June 20, 1906. Serial No. 322,576.

*To all whom it may concern:*

Be it known that I, HUGH ALEXANDER THOMSON, a subject of the King of the United Kingdom of Great Britain and Ireland, residing at Shawlands, Renfrew, Scotland, have invented certain new and useful Improvements in Cranes, of which the following is a specification.

My invention relates to improvements in cranes and the objects of my improvements are that the crane members can be safely and quickly erected and when required to be taken down the several parts can be easily lowered and disconnected. I attain these objects in the manner illustrated by the accompanying drawings in which Figure 1 is a line diagram showing the crane being raised or lowered, and Fig. 2 a corresponding drawing illustrating in detail the connecting joints.

Similar figures refer to similar parts throughout the several views.

The crane consists of a mast 1 with the usual hoisting gear 21, pulleys 19, lifting tackle 2, 20, bed-plate 3, turn-table 4, jib 5, two guys 6, 6<sup>1</sup> and two sleepers 7 and 7<sup>1</sup>. On the metal bed plate 3 to which the ends of the sleepers are fixed the turn-table 4 with its dome shaped bearing is pivoted.

The crane mast 1 is centered at the top to rotate on the pin 8 and each leg of the mast will be hinged at the foot to the turn-table 4 by the pin 18.

To the top of the mast the connecting pieces 9 & 9<sup>1</sup> are pivoted on the pin 8 and to these pieces the ends of the guys 6 and 6<sup>1</sup> will be hinged on pins one of which 11 is shown, the other ends of the guys being pivoted to the sleepers by a screw bolt 10 and fixing blocks 14, 14<sup>1</sup> as shown.

To erect the crane I would after leveling and securely anchoring the two sleepers 7, 7<sup>1</sup> and bed plate 3, mount the turn-table 4 and to it would hinge the

mast 1 with its attached hoisting gear to lie in a horizontal or upwardly inclined position. To the mast 1 and sleeper 7<sup>1</sup> I would connect one of the guys 6<sup>1</sup>. The jib 5 would then be hinged to the turn-table 4 by the pin 12 and also securely anchored to lie in a horizontal or upwardly inclined position. By means of the hoisting gear 21 and lugging tackle 2 fixed to the jib at 22 shown at Fig. 1 the mast 1 and guy 6<sup>1</sup> would be raised by hand power to the vertical position folding on the sleeper 7<sup>1</sup> while the other guy 6 is being guided to the fixing block 14 on the sleeper 7.

To facilitate the raising of the crane when the mast and jib are lying horizontally it would be necessary to carry the lugging rope 2 over a strut 15 as shown. This angle iron strut can be folded to lie on the mast when not in use.

To lower the crane set the jib horizontally and square to either sleeper, the square being proved by the entrance of the lug 16 into the groove 17, and then disconnecting the guy in line with the jib lower the mast and its attached guy over the strut 15 by means of the hoisting gear 21 and tackle 2 as shown at Fig. 1.

Having now described my invention what I claim and desire to secure by Letters Patent of the United States is:—

1. A crane comprising in combination a mast, guys attached to the top of said mast, and a turntable to which the foot of said mast is hinged as described.

2. A crane consisting of a mast and sleepers in combination with guys attached to the top of the mast and each pivotally engaging one of said sleepers, and a turntable to which the foot of said mast is hinged as described.

In testimony whereof I have signed my name to this specification in the presence of two subscribing witnesses.

HUGH ALEXANDER THOMSON.

Witnesses:

WALLACE FAIRWEATHER,  
JNO. ARMSTRONG, JR.