

No. 825,552.

PATENTED JULY 10, 1906.

N. NILSON.
NECK YOKE ATTACHMENT.
APPLICATION FILED JULY 18, 1905.

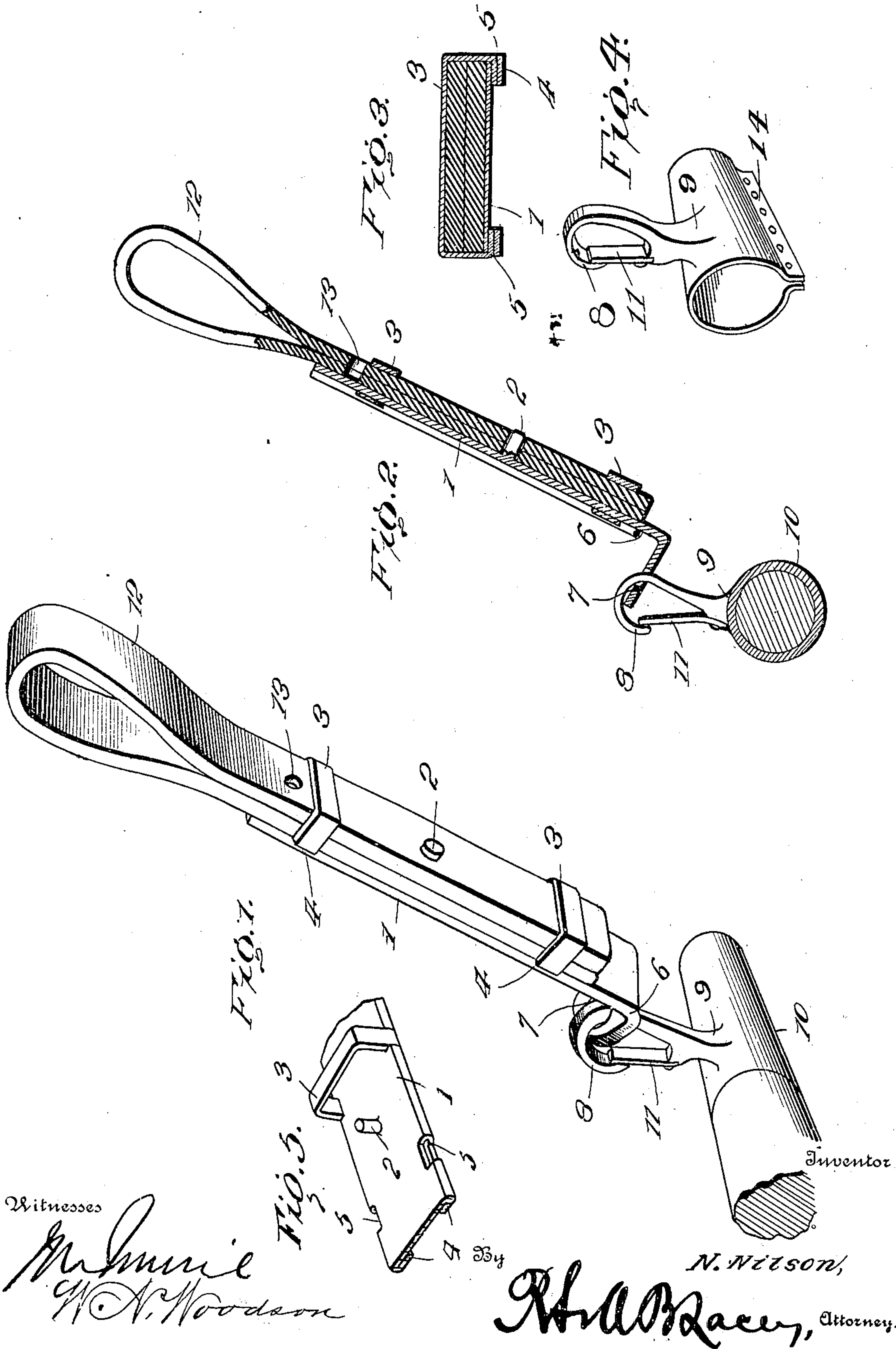

UNITED STATES PATENT OFFICE.

NILS NILSON, OF CASSELTON, NORTH DAKOTA, ASSIGNOR OF ONE-HALF
TO H. H. WALTERS, OF CASSELTON, NORTH DAKOTA.

NECK-YOKE ATTACHMENT.

No. 825,552.

Specification of Letters Patent.

Patented July 10, 1906.

Application filed July 18, 1905. Serial No. 270,214.

To all whom it may concern:

Be it known that I, NILS NILSON, a citizen of the United States, residing at Casselton, in the county of Cass and State of North Dakota, have invented certain new and useful Improvements in Neck-Yoke Attachments, of which the following is a specification.

This invention relates to a novel method of attaching the neck-yoke to the collar of the horse, and has for its object to produce a device for this purpose which can be very easily and quickly attached and detached and which will do away with the wear commonly occasioned by the constant vibration of the neck-yoke.

A further object is to construct an attachment which can be readily applied to any neck-yoke, which will be simple and durable in construction, and which can be manufactured at comparatively small cost.

With these objects in view the invention consists, essentially, of a peculiarly-constructed buckle adapted to receive the ends of the neck-yoke strap and removably attached to the neck-yoke.

For a full description of the invention and the merits thereof and also to acquire a knowledge of the details of construction of the means for effecting the result reference is to be had to the following description and accompanying drawings, in which—

Figure 1 is a perspective view of the invention. Fig. 2 is a vertical sectional view through the device. Fig. 3 is a transverse sectional view through one of the strap-loops. Fig. 4 is a perspective view of a modified form of the ferrule which fits around the neck-yoke. Fig. 5 is a perspective view of a portion of the buckle, showing one of the strap-loops removed.

Corresponding and like parts are referred to in the following description and indicated in all the views of the drawings by the same reference characters.

The buckle comprises a metal plate 1, provided with a centrally-located stud 2 and having a strap-loop 3 on each side of the stud. The metal base-plate 1 is preferably formed of sheet metal, the longitudinal edges of which are turned back upon themselves at 4 and serve to reinforce the buckle. The strap-loops 3 are secured to the base-plate 1 by passing the ends through openings formed by notches 5 in the sides of the plate 1 and

fastening said ends under the inturned edges 55
4. The end of the buckle is bent around at an angle, as seen at 6, and is provided with an opening 7, which is adapted to engage a hook attached to the neck-yoke 9. This hook 8 is preferably secured to a ferrule 10, 60 which fits onto the end of the neck-yoke, and a spring-guard 11 may or may not be employed, as desired. The neck-yoke strap 12 passes around the horse's collar and its ends pass through the strap-loops 3 and are provided with openings 13, which are adapted to engage the stud 2. By employing a series of openings in the strap same can be adjusted as may be required by the circumstances.

By the employment of my device the neck-yoke can be very quickly and easily detached 70 by simply unbuckling the strap or disengaging the buckle from the hook 8, and vice versa. Owing to the fact that the buckle is pivotally attached to the hook 8, much of the wear which is commonly occasioned by the constant vibration of the neck-yoke is eliminated. The buckle itself is peculiarly constructed, so as to obtain the maximum of strength without materially increasing the 80 weight or cost of production.

It must be understood, however, that I do not limit myself to the method of forming the buckle out of sheet metal, but that it can be constructed in any suitable manner, and I 85 further reserve to myself the right to place the hook 8 upon the buckle and the eye 7 upon the ferrule 10, if desirable. Under some conditions it may be found advantageous to construct the ferrule 10 as shown in 90 Fig. 4, in which it is broken along the under side and provided with flanges 14, which are bolted or otherwise suitably fastened together to clamp the ferrule around the neck-yoke.

Having thus described the invention, what 95 is claimed as new is—

1. In a device of the character described, the combination of a neck-yoke, a buckle comprising a base-plate having a stud thereon and provided with strap-loops to hold the neck-yoke strap in engagement with the stud, an outwardly-extending flange projecting from an end of the base-plate, said flange being provided with a perforation, and 105 a hooked member secured to the neck-yoke and engaging with the opening in the outwardly-extending flange.

2. A buckle comprising a base-plate having opposite edges thereof bent backward upon themselves or returned, a stud projecting from said base-plate, and strap-loops, the
5 ends of which are passed through openings formed by notches in the edges of the base-plate and are secured under the before-mentioned returned edges.

3. In a device of the character described,
10 the combination of a neck-yoke, a buckle comprising a base-plate, an outwardly-ex-

tending flange projecting from said base-plate, and connecting means between the neck-yoke and said outwardly-extending flange.

In testimony whereof I affix my signature
in presence of two witnesses.

NILS NILSON. [L. s.]

Witnesses:

JOHN L. GUNKEL,
A. M. DYER.