

No. 819,114.

PATENTED MAY 1, 1906.

G. Y. ANDERSON.
SAW SET.

APPLICATION FILED FEB. 20, 1905.

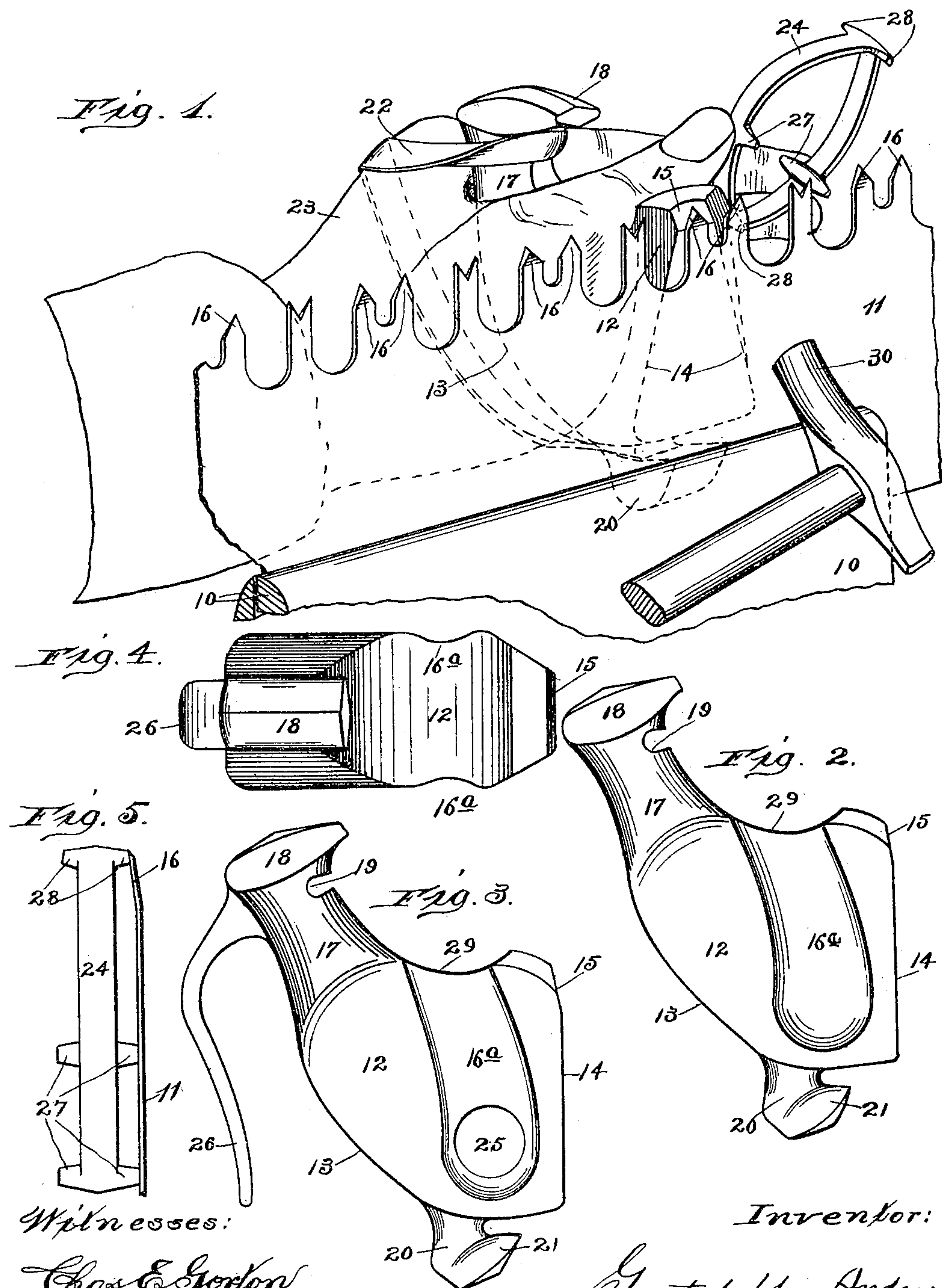

UNITED STATES PATENT OFFICE.

GUSTAF Y. ANDERSON, OF SEATTLE, WASHINGTON.

SAW-SET.

No. 819,114.

Specification of Letters Patent.

Patented May 1, 1906.

Application filed February 20, 1905. Serial No. 246,414.

To all whom it may concern:

Be it known that I, GUSTAF Y. ANDERSON, a citizen of the United States, residing at Seattle, in the county of King and State of Washington, have invented certain new and useful Improvements in Saw-Sets, of which the following is a specification.

This invention relates to improvements in a device to be used in the operation of setting saw-teeth; and it consists in certain peculiarities of the construction, novel arrangement, and operation of the various parts thereof, as will be hereinafter more fully set forth and specifically claimed.

The principal object of the invention is to provide a saw-set which shall be simple and inexpensive in construction, strong, durable, and effective in operation, and so made that it can be operatively retained in one hand of the operator in such a manner that the same hand may be employed for holding and manipulating the gage for the teeth, thus leaving the other hand free for the purpose of using the hammer employed in conjunction with the saw-set for deflecting the saw-teeth and also obviating the necessity of and loss of time in laying the hammer down and picking up the gage.

Other objects and advantages of the invention will be disclosed in the subjoined description and explanation.

In order to enable others skilled in the art to which my invention pertains to make and use the same, I will now proceed to describe it, referring to the accompanying drawings, in which—

Figure 1 is a perspective view of a portion of a saw and its support, showing my improved saw-set grasped in and secured on the hand of the operator and in the position against the saw it will occupy in the operation of deflecting one of the teeth thereof and also illustrating the gage for the teeth as being held between the thumb and forefingers of said hand. Fig. 2 is a side view in elevation of the saw-set, showing the retaining-strip removed therefrom. Fig. 3 is a similar view illustrating a modification in the construction of the saw-set. Fig. 4 is a plan view thereof, and Fig. 5 is an edge view of the gage and a part of the saw-blade.

Like numerals of reference refer to corresponding parts throughout the different views of the drawings.

The reference-numeral 10 indicates a portion of a clamp or vise used for holding or

supporting the saw 11 in the proper or desired position to be operated on and which may be of the ordinary or any preferred construction. The saw 11 is usually supported by means of the vise or clamp 10 in a vertical position and with its teeth projecting upwardly, as shown in Fig. 1 of the drawings, so that the saw-set may be applied to first one side and then the other of the saw. The saw-set comprises an irregular-shaped block 12, which may be made of any suitable size and material, but preferably of metal, and of substantially the shape illustrated in the drawings—that is, its rear portion is slightly curved, as at 13, to fit snugly in the palm of the hand, as will be readily understood by reference to Fig. 1 of the drawings. The front or face of the block 12 has a flat surface 14, which is contracted toward its upper end, as shown by dotted lines in Fig. 1, and the upper front portion or face of the block is rearwardly beveled, as at 15, to enable the teeth 16 of the saw to be given the proper deflection or pitch.

As shown in Fig. 1, the lower part of the beveled portion 15 of the block extends across the block, and when the same is in position for use it will lie in a horizontal plane or across the tooth which is to be set. Each side of the block 12 is preferably provided with a longitudinal recess 16^a, one of said recesses being adapted to receive the fleshy or enlarged portion of the hand below the thumb and the other to receive one or more of the fingers. The upper portion of the block 12 is provided with an upwardly and rearwardly extending neck 17, having on its free end a head or enlargement 18 of any suitable shape. Just below the head 18 the front portion of the neck 17 is preferably provided with a recess 19, for the purpose to be presently explained. The lower portion of the block 12 is provided with a downward projection 20, which has a forwardly-extending portion to form a hook 21 to be used for engaging one end of a band or loop 22, the other end of which is adapted to engage the neck 17 just below its head 18 and when the recess 19 is employed to fit therein. This band may be of elastic or other suitable material and when attached to the neck 17 and projection 20 of the block will extend around the back of the hand 23 so as to straddle the knuckles, thus firmly holding the block 12 against the palm of the hand in such a manner as to permit of the free use of the thumb and upper fingers

in order that the gage 24 for the saw-teeth may be held and suitably manipulated thereby to ascertain when the tooth has the proper inclination or set. Instead of using a band 22 it is obvious that I may employ a strap or cord, which may be attached to the neck 17 and projection 20 or upper and lower portions of the block in any suitable manner without departing from the spirit of my invention.

In Figs. 3 and 4 of the drawings I have shown a modification in the construction of the saw-set, which consists in providing the block 12 with a transverse opening 25 in its lower portion and with a rearwardly and downwardly extending projection 26 on the rear portion of the neck 17 of the block. When this modified form is employed, the projection 26 will extend downwardly over the back of the hand, so as to securely hold the block in position, and which may be more firmly held by inserting one of the fingers in the opening 25 therefor.

In Fig. 5 of the drawings is shown an edge view of the saw 11 and gage 24, the latter comprising an elongated frame having on its edges a series of projections 27 to rest against the saw-blade and at one of its ends beveled extensions 28 to gage the saw-teeth.

From the foregoing and by reference to the drawings it will be readily understood and clearly seen that by placing the block 12 in the palm of the hand, so that the neck 17 will project between the thumb and forefinger at their juncture, the bottom part of the hand will rest against or just above the rear portion of the projection 20 on the lower portion of the block. When in this position, the thumb may be extended across the recessed upper part 29 of the block and assist the fingers in holding and manipulating the gage 24, while one or more of the lower fingers may rest against the side of the block in one of the recesses 16^a, or when the modified construction shown in Fig. 3 is employed one of them may be inserted in the opening 25 therefor. As before stated, the block may be retained on the hand by means of the retaining pro-

jection 26 or by means of an elastic band 22 or other suitable retaining device. When thus located in the hand, the flat front or face 14 of the block is placed against the saw-blade so that the lower portion 16 of the beveled part 15 will extend across one of the teeth, when by striking the upper portion of said tooth with a hammer 30 it may be suitably deflected, the inclination of said deflected portion being ascertained by means of the gage 24 in the well-known manner.

Having thus fully described my invention, what I claim as new, and desire to secure by Letters Patent, is—

1. A saw-set comprising a block having a flat face with a portion thereof beveled to form a die, an upwardly and rearwardly projecting neck on the upper portion of the block, a projection on the lower portion of the block, and retaining means adapted to be secured to the neck and said projection, substantially as described.

2. A saw-set comprising a block having a flat face with a part thereof beveled to form a die, an upwardly and rearwardly extending neck on the upper portion of the block having a recess in its front portion, a hooked projection on the lower portion of the block, and means adapted to be located at its ends in said recess and hook to retain the block on the hand of the operator, substantially as described.

3. A saw-set comprising a block having a flat face with the upper part thereof beveled to form a die, an upwardly and rearwardly extending neck having a head at its top, retaining means associated with said neck and extending over the back of the hand, said block having a suitable hole or recess in the lower portion thereof to receive one or more of the lower fingers of the hand of the operator, for steadying and holding the block in position, substantially as described.

GUSTAF Y. ANDERSON.

Witnesses:

CHAS. C. TILLMAN,
A. GUSTAFSON.