

No. 812,016.

PATENTED FEB. 6, 1906.

M. BYE.
HANDLE FOR FIREARMS.
APPLICATION FILED JAN. 7, 1905.

2 SHEETS—SHEET 1.

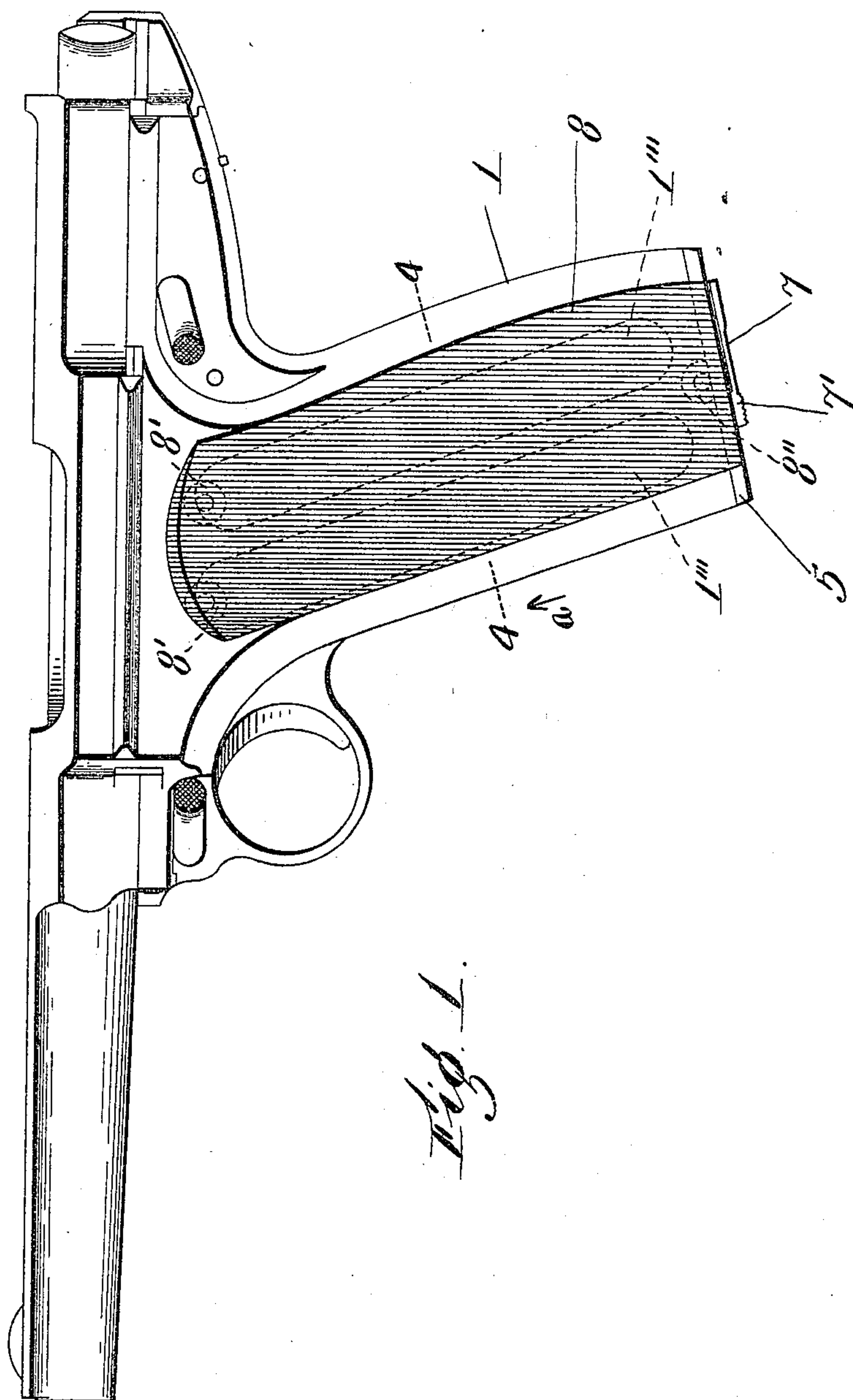

Fig. 1.

Witnesses:
G. F. Mason
M. Heale.

Inventor:
M. Bye
By his Attorney
John L. Dawey.

No. 812,016.

PATENTED FEB. 6, 1906.

M. BYE.
HANDLE FOR FIREARMS.
APPLICATION FILED JAN. 7, 1905.

2 SHEETS—SHEET 2.

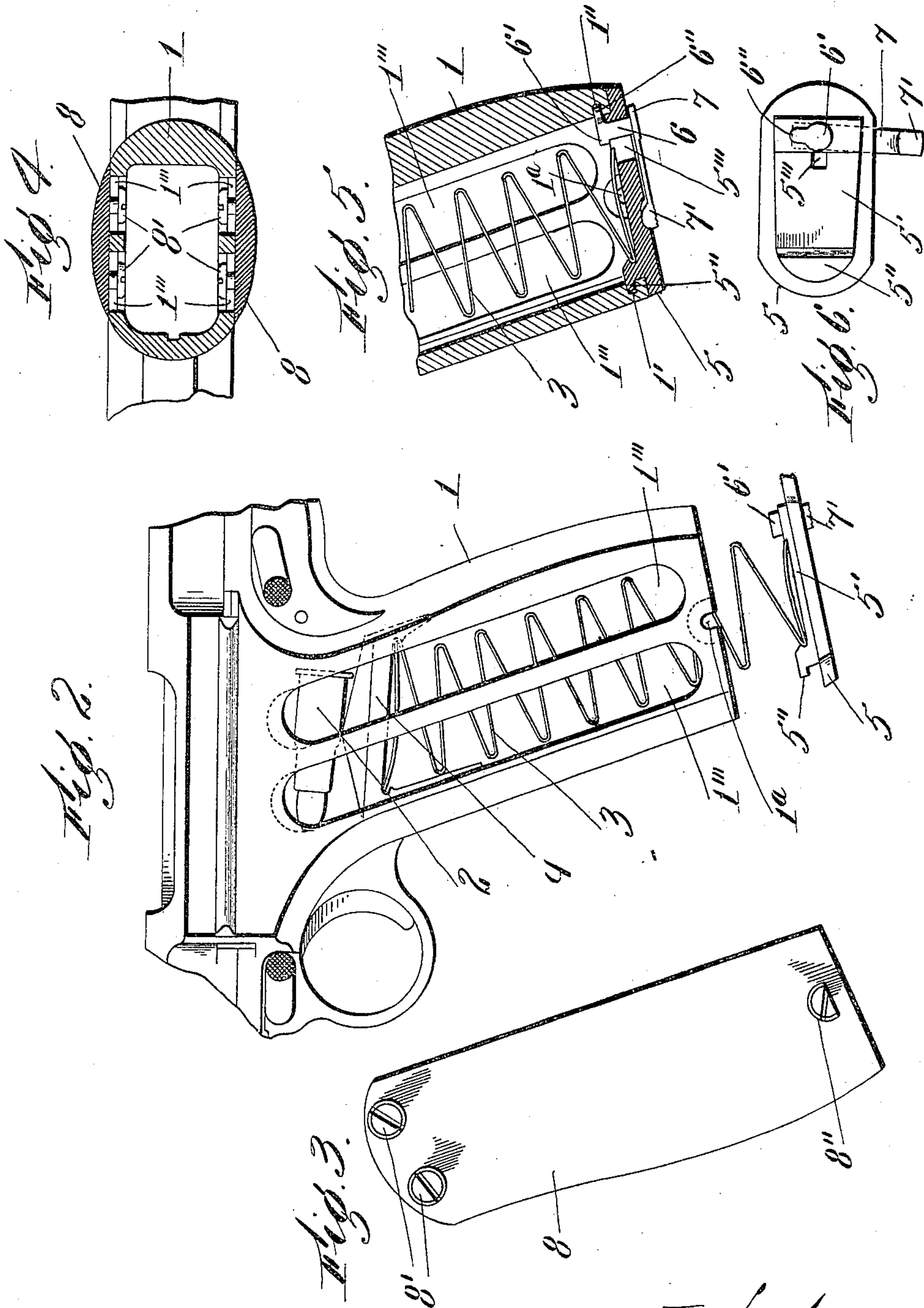

UNITED STATES PATENT OFFICE.

MARTIN BYE, OF WORCESTER, MASSACHUSETTS, ASSIGNOR TO HARRINGTON & RICHARDSON ARMS COMPANY, A CORPORATION OF MASSACHUSETTS.

HANDLE FOR FIREARMS.

No. 812,016.

Specification of Letters Patent.

Patented Feb. 6, 1906.

Application filed January 7, 1905. Serial No. 239,998.

To all whom it may concern:

Be it known that I, MARTIN BYE, a citizen of the United States, residing at Worcester, in the county of Worcester and State of Massachusetts, have invented certain new and useful Improvements in Handles for Firearms, of which the following is a specification.

My invention relates to a handle for firearms, and more particularly to the sides or cheek-pieces of the handle of a firearm.

The object of my invention is to improve upon the construction of the cheek-pieces of the handle of a firearm as ordinarily made and the manner of attaching them to the handle.

In the ordinary construction of the cheek-pieces of the handle of a firearm they are attached to the handle by means of screws or rivets, the heads of which appear on the outside of the cheek-pieces and are visible on the outer surface of the handle. In my improvements the cheek-pieces of the handle of a firearm are so made and attached to the handle of the firearm that the attaching screws or rivets are not visible on the outer surface of the handle. I provide the cheek-pieces with headed screws or rivets upon their inner surface, which enter undercut recesses or openings in the handle portion, and I also provide a detachable plate for the lower or outer end of the handle portion which extends over the lower ends of the cheek-pieces and is detachably secured in place to the end of the handle portion to secure the cheek-pieces thereto.

I have shown in the drawings my improvements in cheek-pieces of the handle of a firearm combined with the handle of a magazine-firearm of the type shown and described in my pending application, Serial No. 217,841, in which the handle forms a magazine for the cartridges which are forced up into position by a spring which is secured at its lower end to a plate detachably secured to the lower end of the handle, as above referred to; but my improvements may be combined with the handle of firearms of any ordinary and well-known construction.

Referring to the drawings, Figure 1 is a side view of a firearm having cheek-pieces on the handle and a plate on the lower end of the handle embodying my improvements. Fig. 2 is a view of the handle portion detached, with the cheek-pieces removed and

the plate at the lower end of the handle detached from the handle. Fig. 3 is a view of the inner side of one of the cheek-pieces detached. Fig. 4 is a cross-section on line 4 4, Fig. 1, looking in the direction of arrow *a*, same figure. The spring and cartridges are not shown. Fig. 5 is a central vertical section through the lower part of the handle shown in Fig. 1, and Fig. 6 is a view of the inner side of the end plate detached with the catch in its open or inoperative position.

In the accompanying drawings in Fig. 1 is shown a recoil-firearm of the type shown and described in my pending application, Serial No. 217,841. The handle portion 1 forms the magazine for holding the cartridges 2, and an expansion leaf-spring 3 is contained within the handle 1 and has at its upper end a block or plate 4, which is fitted to slide in grooves in the handle portion 1 and acts to force up the cartridges into position to be fired in the ordinary way. The lower end of the spring 3 is attached to the inner side of the plate 5, which forms the end plate of the handle 1. The end plate 5 fits onto the lower end of the handle portion, and its external shape corresponds to the shape of the lower end of the handle portion in cross-section. The end plate 5 has a raised portion 5' upon its inner surface, which fits within the open end of the handle portion, and an undercut projection 5'' on one end, which extends into a recess or groove 1' within the lower end of the handle 1. (See Fig. 5.) On the other end of the plate 5 is a rotary stud 6, extending through an opening 5''' in the plate 5 and having an enlarged inner end or head 6' with a projection 6'' thereon, which is adapted to extend into a recess or groove 1'' within the lower end of the handle portion 1. The stud 6 has secured upon its outer end and extending upon the outside of the plate 5 a spring-handle or thumb-latch 7 to turn the stud 6 and move the projection 6'' into the recess 1'' after the projection 5'' has been inserted in the recess 1' to secure the plate 5 to the end of the handle 1, as shown in Fig. 5. The end 7' of the spring-handle 7 will fit into a recess in the outer side of the plate 5 to hold it in position. (See Fig. 5.) When the handle 7 is moved out, as shown in Fig. 6, to disengage the projection 6'' the end plate 5 is free to be removed, as shown in Fig. 2.

The handle portion 1 has in this instance on each side two elongated openings 1'''

therein, which extend substantially the length of the handle. Each cheek-piece 8 is preferably made of horn, bone, or other suitable material and is adapted to fit onto the sides of the handle portion 1 and to extend entirely over the openings 1''' therein, as shown in Fig. 1.

Each cheek-piece 8 preferably has two headed screws or rivets 8' at its upper end upon its inner surface, which are adapted to extend through the openings 1''' (see Fig. 4) and into undercut recesses at the upper ends of said openings. (Shown by broken lines in Fig. 2.) At the lower end of each cheek-piece 8 upon its inner surface is a headed screw or rivet 8'' with the lower part of its head cut off. The shank of the screw or rivet 8'' is adapted to extend into a recess or notch 1^a in the lower end of the side of the handle portion 1, and the head extends into a recessed portion on the inner side of the handle portion around the notch 1^a. (Indicated by broken lines in Fig. 2.)

The side edges of the end plate 5 bear against the lower surface of the screws 8'' and hold the screws 8' and 8'' in their operative position to lock and secure the cheek-pieces 8 to the handle portion 1. When the end plate 5 is removed, the cheek-pieces 8 are free to be removed by simply drawing down said pieces to disengage the screws 8' and 8'' thereon from their retaining grooves or recesses.

It will be understood that the details of construction of my improvements may be varied, if desired, and they may be adapted to be used in connection with the handle portion of firearms of any usual and well-known construction of a magazine or other type.

Having thus described my invention, what

I claim as new, and desire to secure by Letters Patent, is—

1. In a firearm, the combination with the handle portion, of detachable cheek-pieces having stationary headed screws or attaching devices upon their inner surface, adapted to engage recesses in the handle portion, to secure the cheek-pieces thereto, and means for holding said attaching devices in engagement with said recesses, said means comprising a plate on the outer or lower end of the handle portion, substantially as shown and described.

2. In a firearm, the combination with the handle portion, of detachable cheek-pieces having stationary headed screws or attaching devices upon their inner surface, adapted to engage recesses in the handle portion to secure the cheek-pieces thereto, and means for holding said attaching devices in engagement with said recesses, said means comprising a detachable plate on the outer or lower end of the handle portion, and means for attaching and detaching said plate, substantially as shown and described.

3. In a firearm, the combination with the handle portion, of a plate having a projection thereon to extend into a recess in the end of the handle, and a rotatable stud thereon, and a projection on said stud, and an external handle to rotate said stud and move said projection into and out of engagement with a recess in the end of the handle, to attach said plate thereto, and detach it therefrom, substantially as shown and described.

MARTIN BYE.

Witnesses:

JOHN C. DEWEY,
M. HAAS.