

No. 754,570.

PATENTED MAR. 15, 1904.

C. F. KADE.
KITCHEN CABINET.

APPLICATION FILED NOV. 14, 1901.

NO MODEL.

3 SHEETS—SHEET 1.

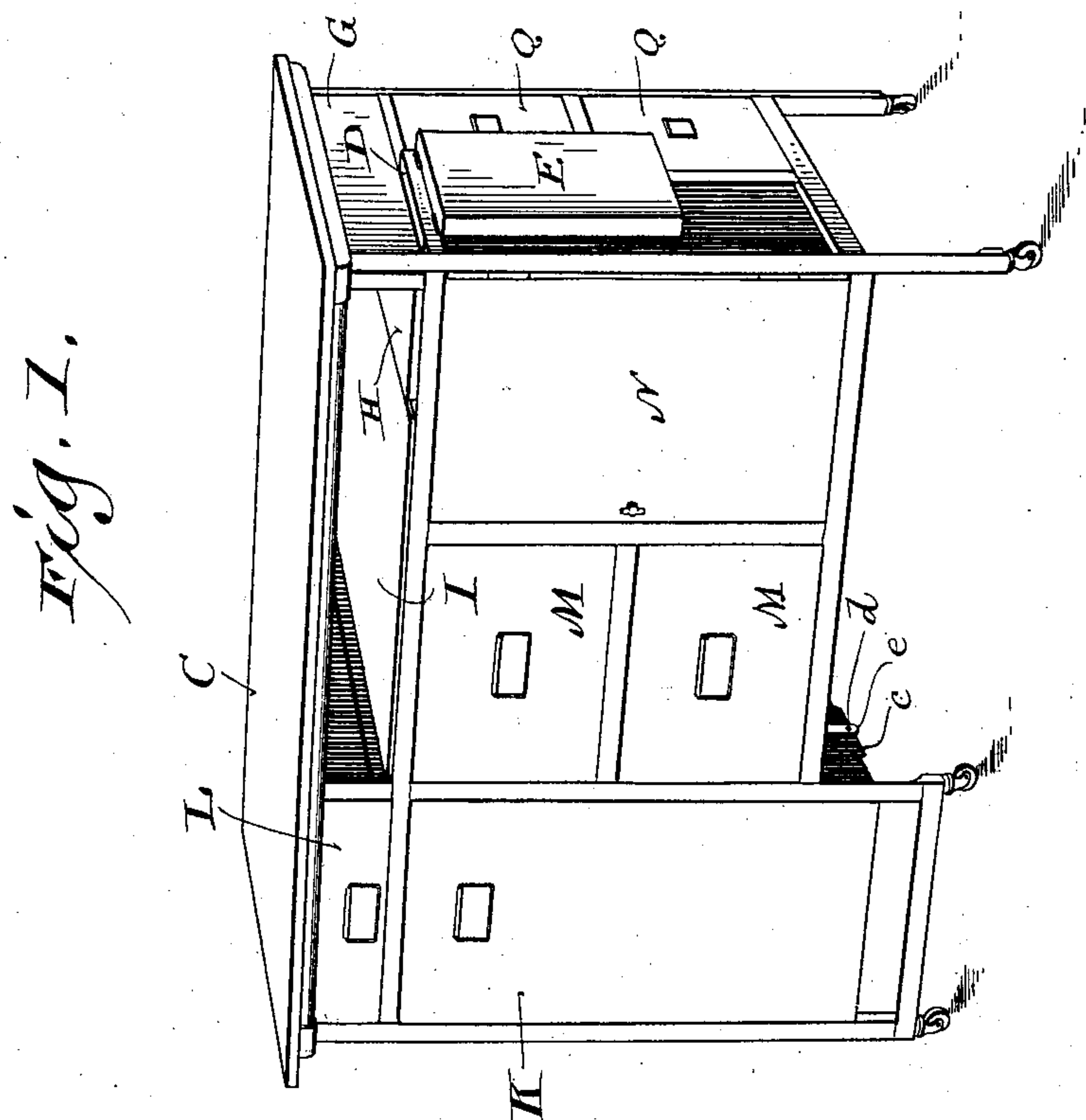

Witnesses
Geo. W. Young,
H. E. Oliphant

Inventor
Charles F. Kade
By H. G. Underwood
Attorney

No. 754,570.

PATENTED MAR. 15, 1904.

C. F. KADE.
KITCHEN CABINET.

APPLICATION FILED NOV. 14, 1901.

NO MODEL.

3 SHEETS—SHEET 2.

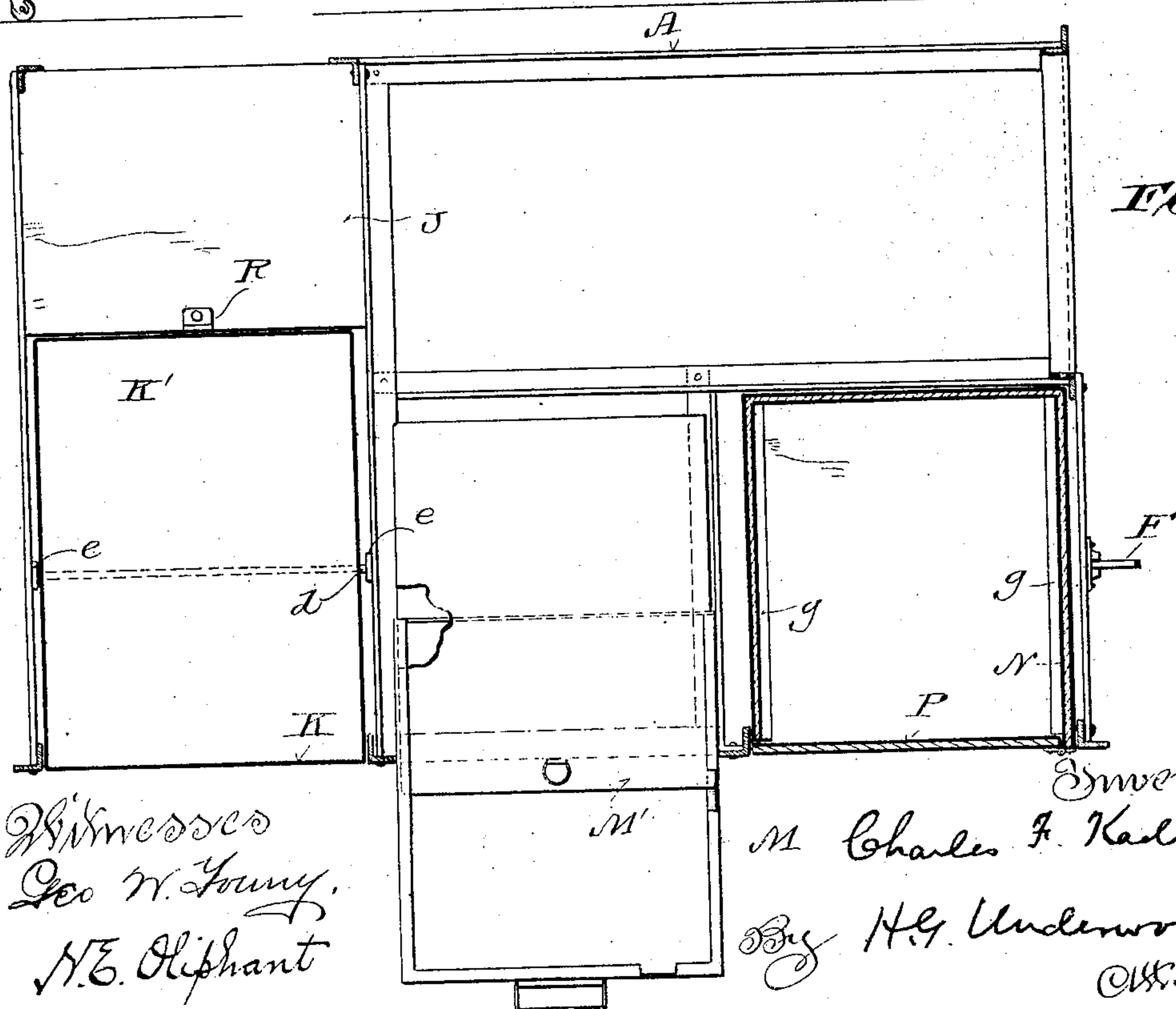
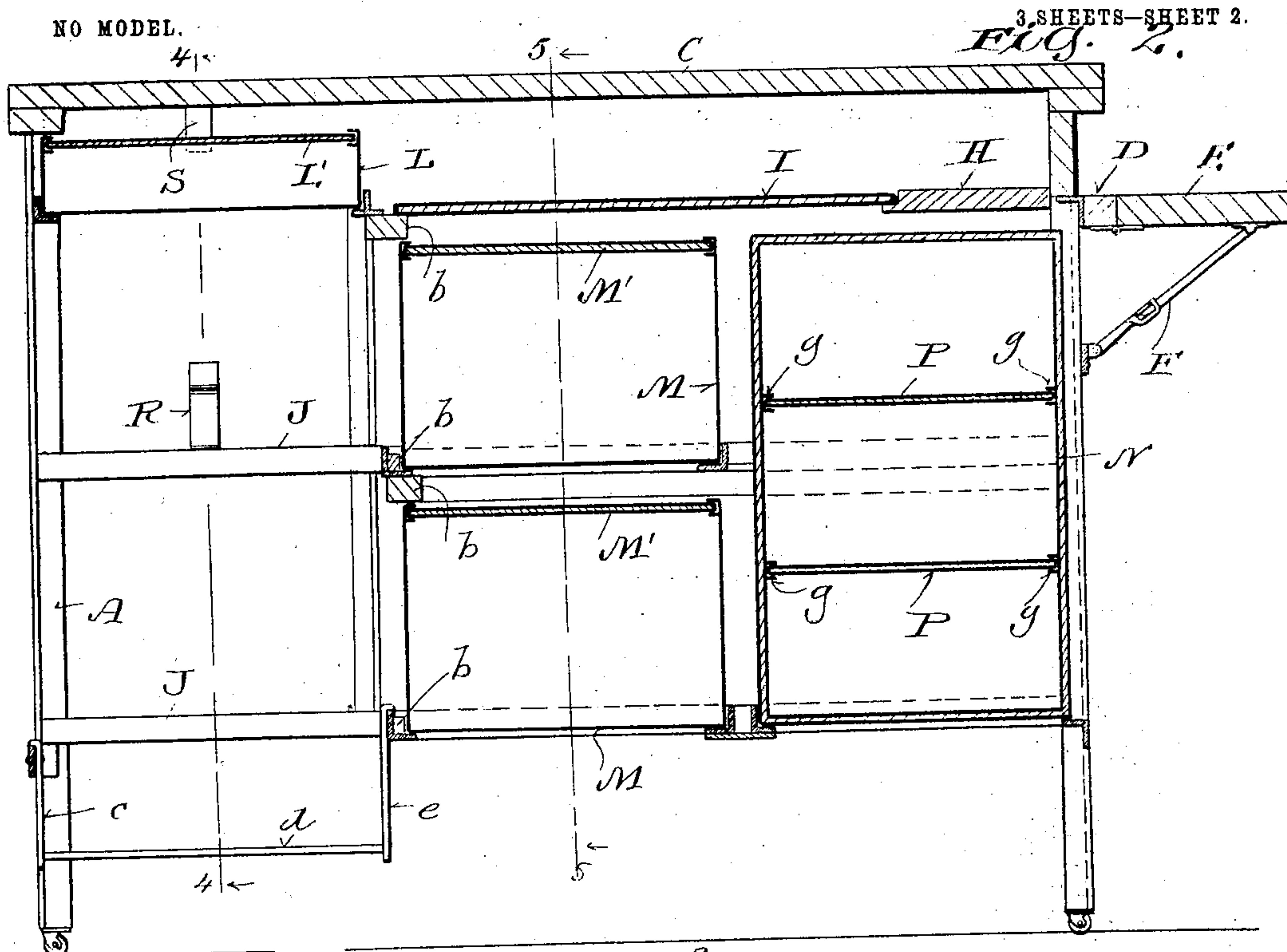

Witnessed
Geo W. Young.
N.E. Oliphant

Inwente
M Charles F. Kade
By H. G. Underwood
Attorney

No. 754,570.

PATENTED MAR. 15, 1904.

C. F. KADE.
KITCHEN CABINET.

APPLICATION FILED NOV. 14, 1901.

NO MODEL.

3 SHEETS—SHEET 3.

Fig. 5.

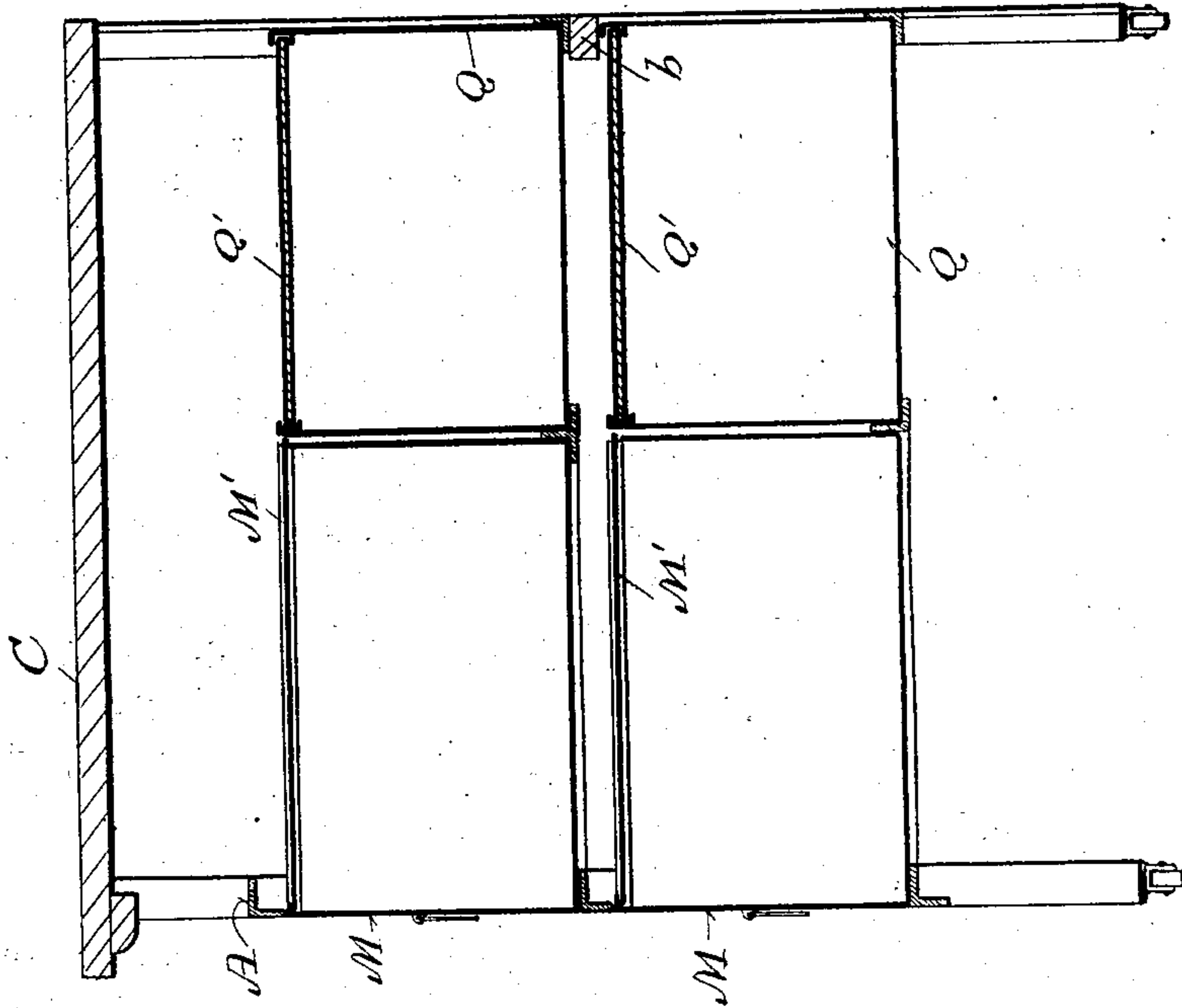
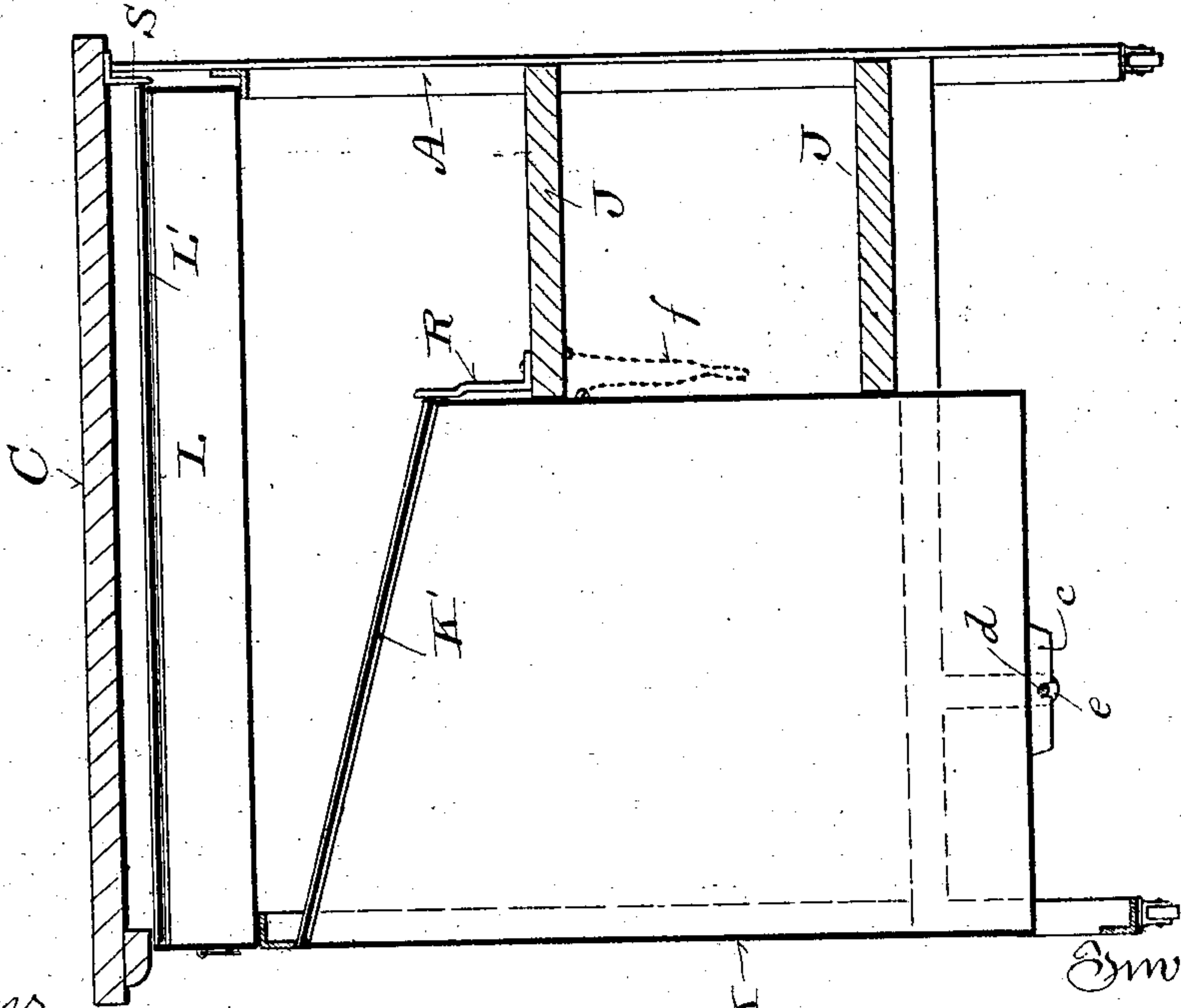

Fig. 4.



Witnesses
Geo W. Young
H.E. Oliphant

Inventor
Charles F. Kade
By H.G. Underwood
Attorney

UNITED STATES PATENT OFFICE.

CHARLES F. KADE, OF SHEBOYGAN, WISCONSIN, ASSIGNOR TO M. WINTER LUMBER COMPANY, OF SHEBOYGAN, WISCONSIN.

KITCHEN-CABINET.

SPECIFICATION forming part of Letters Patent No. 754,570, dated March 15, 1904.

Application filed November 14, 1901. Serial No. 82,185. (No model.)

To all whom it may concern:

Be it known that I, CHARLES F. KADE, a citizen of the United States, and a resident of Sheboygan, in the county of Sheboygan and State of Wisconsin, have invented certain new and useful Improvements in Kitchen-Cabinets; and I do hereby declare that the following is a full, clear, and exact description thereof.

My invention has for its object to provide
 10 hygienic kitchen storage-cabinets having work-table tops, independent separately-removable dust and vermin proof compartments, and convenient shelving, said invention consisting in certain peculiarities of construction
 15 and combination of parts, hereinafter particularly set forth with reference to the accompanying drawings and subsequently claimed.

Figure 1 of the drawings represents a perspective view of a kitchen-cabinet in accordance with my invention; Fig. 2, a vertical longitudinal section of the same looking from the rear, a tilt-bin thereof having been removed; Fig. 3, a horizontal sectional view; and Figs. 4 and 5 transverse sectional views
 25 respectively indicated by lines 4 4 and 5 5 in the second figure.

Referring by letter to the drawings, A indicates a frame, consisting for the most part of vertical and horizontal angle-iron strips riveted together at the joints, filling-strips *b*, of wood, being made fast in the frame wherever necessary or desirable. A wood top C is made fast on the frame and therewith forms a work-table. Joined to an upper end strip of the
 30 frame is a wooden cleat D, and in hinge connection with this cleat is a drop-shelf E, the sections of a jointed extension-brace F being in pivotal connection with the shelf and another end strip of said frame. The extension-
 40 brace is of ordinary type in which a lug of one section in pivotal connection with the under side of the shelf engages a longitudinal slot in the other section, that is pivotally connected to the frame, the two sections being
 45 extended in line when the shelf is up. The joint is broken by a lift of same, and the sections of the brace are vertical when the shelf is down. A panel G is set in the frame between top C and the frame-strip to which cleat

D is made fast. A permanent wooden shelf
 50 H, adjacent to panel G, and one of the filling-strips *b* in the frame constitute supports for a portable bread-slab I when the same is not in use, one edge of the shelf being rabbeted to form a seat for said bread-slab. Other stationary shelves J are arranged one above another in the frame back of space in which a tilt-bin K has play, depending notched flanges
 55 *c* of the bin being engaged by a pivot-rod *d*, supported by hangers *e*, depending from frame-strips, a chain *f* being put in connection with said bin and one of the shelves J to limit outward tilt of the former. The shelves J are accessible through the adjacent open portions of the frame. A front drawer L
 60 above the tilt-bin and other drawers M, one above the other between said bin and a chest N, are supported and guided on horizontal strips of the frame, the chest being also supported and guided on other horizontal frame-
 65 strips. The chest has a hinged front-opening door, and its side walls are provided with inner supports *g* for shelves P, that are preferably removable. End drawers Q are supported and guided on horizontal strips of the
 70 frame in rear of the chest, and all the drawers, the bin, and chest are preferably sheet metal, each being a separately-removable independent compartment, whereby cleaning of the cabinet of which they form parts is facilitated. 80
 Sliding covers K' L' M' Q' are provided in connection with bin K and drawers L M Q, these covers being pushed back by hand when said bin and drawers are swung or pulled outward. A bracket R on one of the shelves J
 85 serves to cause automatic return of pushed-back cover K' to normal position when bin K is swung back to be wholly within the frame. A bracket S, depending from top C, serves the same purpose with reference to pushed-back
 90 cover L' when drawer L is run in. Drawers Q are in the way of pushed-back covers M' of drawers M, and shelves J are in the way of pushed-back covers Q' of said drawers Q, all the covers, the bread-slab I, and chest-shelves
 95 P being preferably wood-filled sheet-metal casings.

To facilitate moving the kitchen storage-

cabinet herein set forth, the frame of same is mounted on casters.

Owing to the predominance of metal in the cabinet and the closures for the several independent separately-removable compartments, said cabinet is virtually dust and vermin proof. In practice the frame is coated with enamel and the several compartments exteriorly japanned.

10 Having thus described my invention, what I claim as new, and desire to secure by Letters Patent, is—

A kitchen-cabinet comprising a frame, com-

partments separately removable from the frame, covers having sliding engagement with 15 the compartments, and brackets arranged in said cabinet in the path of pushed-back covers of said compartments.

In testimony that I claim the foregoing I have hereunto set my hand, at Sheboygan, in 20 the county of Sheboygan and State of Wisconsin, in the presence of two witnesses.

CHARLES F. KADE.

Witnesses:

F. H. POETHIG,

P. J. PETERSON.