

No. 719,540.

PATENTED FEB. 3, 1903.

C. E. WETTLAUER.  
SHOE LACE HOLDER.

APPLICATION FILED SEPT. 15, 1902.

NO MODEL.

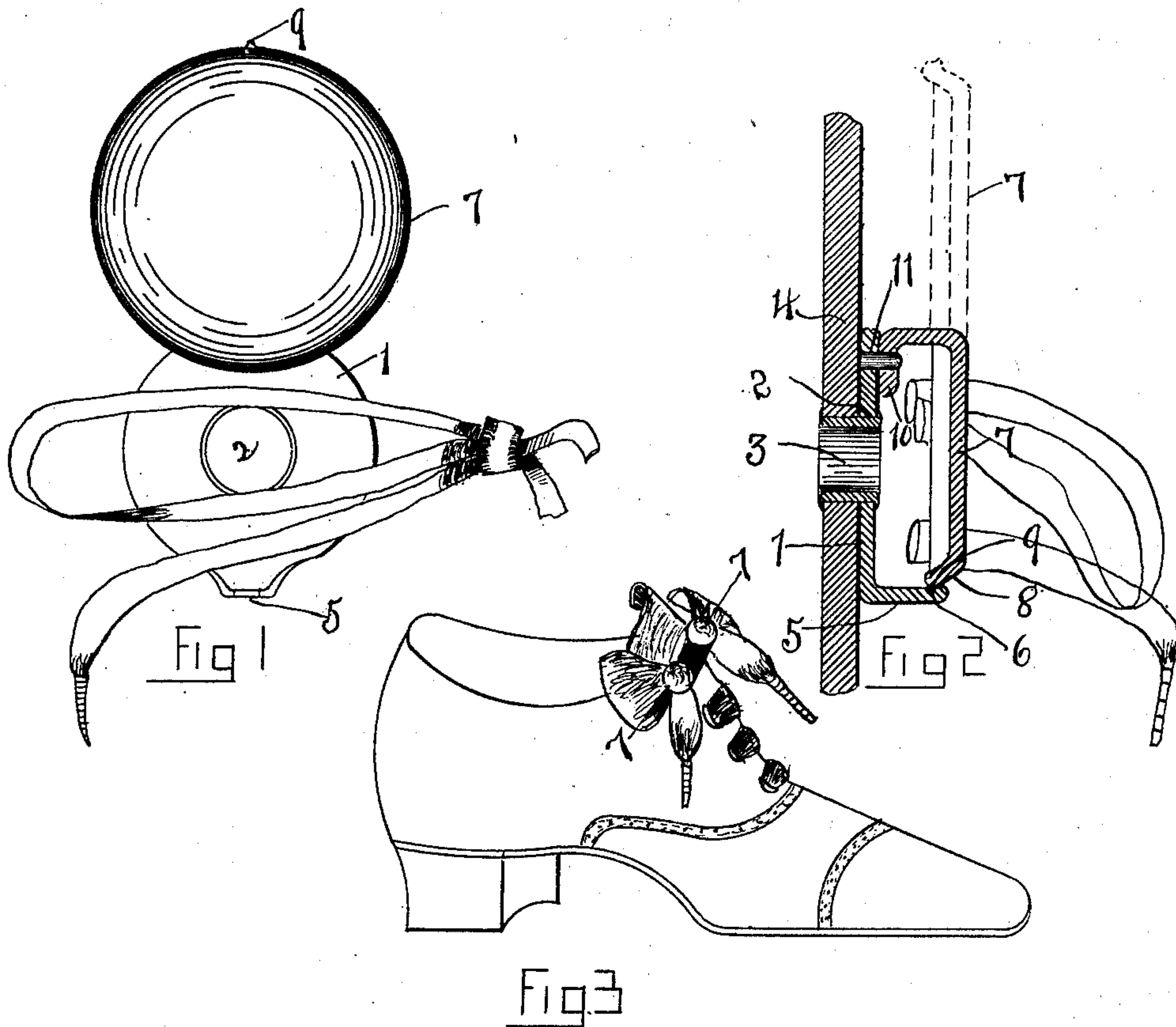

WITNESSES  
*J. W. Pettapiece*  
*A. J. Reid*

INVENTOR  
CONRAD E. WETTLAUER  
*W. F. Miller*  
ATTORNEY

# UNITED STATES PATENT OFFICE.

CONRAD E. WETTLAUFER, OF BUFFALO, NEW YORK.

## SHOE-LACE HOLDER.

SPECIFICATION forming part of Letters Patent No. 719,540, dated February 3, 1903.

Application filed September 15, 1902. Serial No. 123,473. (No model.)

*To all whom it may concern:*

Be it known that I, CONRAD E. WETTLAU-  
FER, a citizen of the United States, residing at  
Buffalo, in the county of Erie and State of  
New York, have invented certain new and  
useful Improvements in Shoe-Lace Holders;  
and I do hereby declare the following to be a  
full, clear, and exact description of the inven-  
tion, such as will enable others skilled in the  
art to which it appertains to make and use  
the same, reference being had to the accom-  
panying drawings, and to figures of reference  
marked thereon, which form a part of this  
specification.

My invention relates to improvements in  
shoe-lace fasteners, or more particularly to  
that class of devices which are employed to  
temporarily secure the ends of a shoe-lace  
after it has been tied to prevent such ends  
from becoming accidentally unfastened. Con-  
stant contact with the skirt or trousers causes  
the lace to become loosened; and the object  
of my invention is to provide a simple, easily-  
adjusted, and effective device secured to each  
side of the front opening in the upper, at or  
near the top edge thereof, and adapted for  
the temporary reception and retention of the  
two ends of the lace-bow.

To that end my invention consists of cer-  
tain details of construction, all of which will  
be fully hereinafter described and claimed.

In the drawings, Figure 1 is a top plan view  
of my improved fastener opened for the re-  
ception of one side of the lace-bow. Fig. 2 is  
a central vertical section of the same in closed  
position, the open position being shown in  
dotted lines. Fig. 3 illustrates a shoe with  
a pair of my improved fasteners in position  
thereon.

Referring to the drawings, 1 (see Figs. 1 and  
2) is the base, preferably disk-shaped and  
provided with the central circular orifice 2.  
This orifice is adapted for the reception of the  
securing-eyelet 3, (see Fig. 2,) which passes  
through such orifice and the upper-leather 4  
and is upset on its inner end to permanently  
secure the base 1 of the fastener.

At the front of base 1 is the upturned lip or  
flange 5, having upon its inner face the socket  
or depression 6, located near its upper edge.

7 is the inclosing and retaining member,

preferably disk-shaped, with its outer edge  
turned inwardly to form an annular flange 8.  
Upon the front is located the teat or spur  
9, adapted for spring engagement with the  
socket 6 on the base 1. Diametrically oppo-  
site the teat or spur 9 is the inwardly-project-  
ing lug 10, which is loosely pivoted to the base  
1, as at 11. This permits the member 7 to be  
swung upon the base 1 in a plane parallel  
thereto.

To secure the lace-bow, it is only necessary  
to swing the member 7 back into the position  
shown in Fig. 1, lay one side of the bow upon  
the base 1, and throw the member 7 around  
until the teat 9 springs into engagement with  
the socket 6. In this manner each side of the  
bow can be securely retained in one of my  
improved fasteners, as clearly shown in Fig.  
5, which effectively prevents the lace from  
accidental unfastening through contact with  
the skirt or trousers. The bow of the lace is  
as easily unfastened by applying pressure to  
the member 7 to swing it out of engagement  
with the base 1, which permits the bow to be  
readily removed from the fastener, when it  
can be untied.

It will be seen that the spring-catch is en-  
tirely within the device when in locked posi-  
tion, thus presenting no obstructions what-  
ever for the skirt or trousers to catch upon.

I claim—

A shoe-lace fastener consisting of the disk-  
shaped base 1, the upturned lip or flange 5 on  
the front of base 1 and having on its inner  
face the socket or depression 6, the disk-  
shaped inclosing and retaining member 7  
pivoted to the base 1 and adapted for opening  
and closing engagement in a plane parallel  
with such base, and the teat or spur 9 upon  
the front of member 7 adapted for spring en-  
gagement with the socket or depression 6 of  
the base, all combined and operating as and  
for the purpose stated.

In testimony whereof I have signed my  
name to this specification in the presence of  
two subscribing witnesses.

CONRAD E. WETTLAUFER.

Witnesses:

A. J. LEID,

W. T. MILLER.