

No. 694,718.

Patented Mar. 4, 1902.

A. T. BINKERD.

SAW CLAMP.

(Application filed Oct. 14, 1901.)

(No Model.)

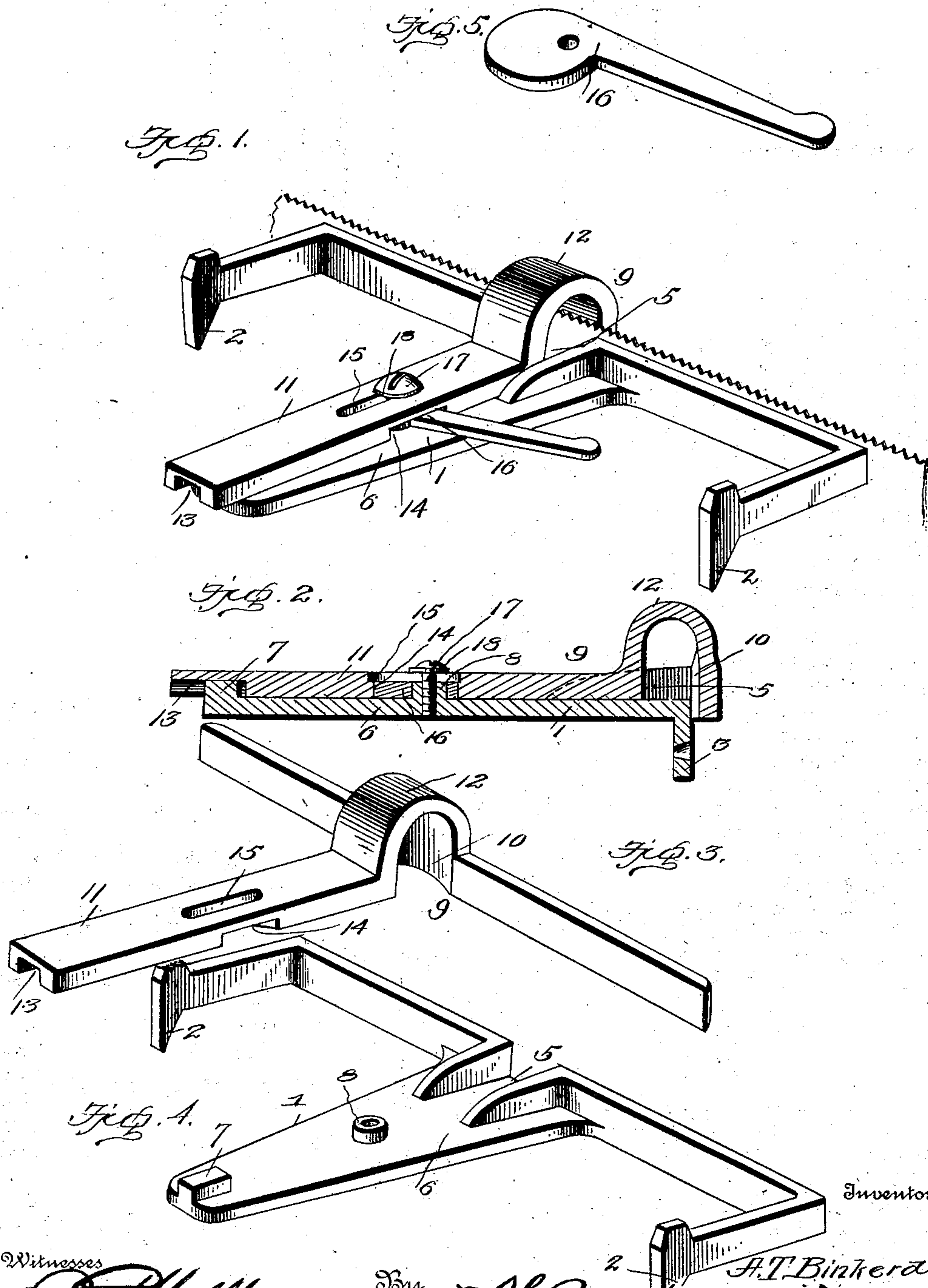

Inventor

Witnesses

J. H. Wilson
E. C. Hunt

By

A. T. Binkerd
A. B. Wilson & Co
Attorneys

UNITED STATES PATENT OFFICE.

AARON T. BINKERD, OF PETROLIA, PENNSYLVANIA.

SAW-CLAMP.

SPECIFICATION forming part of Letters Patent No. 694,718, dated March 4, 1902.

Application filed October 14, 1901. Serial No. 78,638. (No model.)

To all whom it may concern:

Be it known that I, AARON T. BINKERD, a citizen of the United States, residing at Petrolia, in the county of Butler and State of Pennsylvania, have invented certain new and useful Improvements in Saw-Clamps; and I do declare the following to be a full, clear, and exact description of the invention, such as will enable others skilled in the art to which it appertains to make and use the same.

The invention relates to saw-clamps.

The object of the invention is to provide a saw-clamp which shall be simple and compact of construction, durable in use, comparatively inexpensive of production, and efficient in action.

With these objects in view the invention consists in certain novel features of construction and combination of parts, which will be hereinafter more fully set forth.

In the accompanying drawings, Figure 1 is a perspective view of my improved saw-clamp, showing it in use. Fig. 2 is a longitudinal sectional view. Fig. 3 is a detail perspective view of the movable jaw. Fig. 4 is a similar view of the fixed jaw, and Fig. 5 a similar view of the operating-lever.

Referring to the drawings, 1 denotes a fixed jaw, which may be provided with embedding prongs 2 at its rear end for adjustment to a bench, shelf, or other object, and, if desired, it may be further provided with a downwardly-extending lip 3 to receive screws for permanently fastening it in position. The face of the jaw is provided with a recess 5 for a purpose hereinafter to appear, and located at and extending from the rear of this recess is a plate or extension 6, provided with a guide-lug 7 and a central post 8.

9 denotes a movable jaw the working face of which is provided with a recess 10, which coacts with the recess 5, whereby when the saw is clamped in position the teeth which are opposite said recesses will not come in contact with said jaws, thereby obviating damage to the "set" of said teeth.

11 denotes a shank preferably made integral with the jaw 9 and provided with an arched portion 12 at its point of connection with said jaw, whereby the shank is prevented from coming in contact with the saw-teeth. This shank is adapted to have a sliding en-

gagement between the vertical walls of the recess 5, and is provided on its lower side at its inner end with a groove 13 to receive the guide-lug 7, and is further provided with a circular recess 14, intersected by the vertically-disposed longitudinal slot 15.

16 denotes a cam-lever the cam-head of which is journaled upon the post 8 and rests in the circular recess 14. A set-screw 17 extends through the longitudinal slot 15 and is secured in the post 8 and has confined between its head and the upper surface of the shank 11, over the slot 15, a washer 18.

In operation the saw-blade is placed between the two jaws, and by moving the lever in the proper direction the sliding jaw 9 will be caused to clamp the saw-blade between said jaw 9 and the fixed jaw 1, thus securely retaining the blade in position. A reverse movement of the lever will release the blade. In the moving of the jaw it will be observed that the forward end of the shank 11 is guided between the side walls of the recess 5, while the rear end is guided by the lug 7, engaging the groove 13, so that all sidewise strain upon the screw 17 and the post 8 is obviated.

From the foregoing description, taken in connection with the accompanying drawings, the construction, mode of operation, and advantages of the invention will be readily understood without requiring a more extended explanation.

While the preferred form of the invention is as herein described, it will of course be understood that changes in the form, proportion, and the minor details of construction may be made within the scope of the invention without departing from the spirit or sacrificing any of the advantages thereof.

Having now described my invention, what I claim as new, and desire to secure by Letters Patent of the United States, is—

1. In a saw-clamp, the combination with a fixed jaw having a recess in its working face and provided with a guide-lug, of a movable jaw having a coacting recess in its working face and provided with a groove to receive said guide-lug, and means for slidably connecting the fixed jaw to the movable jaw, and means for clamping the two jaws together, substantially as set forth.

2. In a saw-clamp, the combination with a

fixed jaw having a groove in its working face
and provided with a vertically-extending lug
and with a stud, of a movable jaw having a
coacting recess in its working face and pro-
5 vided with an extension having a notched
portion, said extension being provided with a
groove to engage the lug, and formed with a
circular recess and with a longitudinal open-
ing, a cam-lever journaled upon the stud and
10 a screw extending through the longitudinal

opening into the stud for slidably connecting
the movable jaw to the fixed jaw, substan-
tially as described.

In testimony whereof I have hereunto set
my hand in presence of two subscribing wit- 15
nesses.

AARON T. BINKERD.

Witnesses:

E. H. RANDOLPH,
ROBT. BALPH. *