

No. 636,334.

Patented Nov. 7, 1899.

H. HAMMER.
TRACE BUCKLE.

(Application filed Jan. 25, 1899.)

(No Model.)

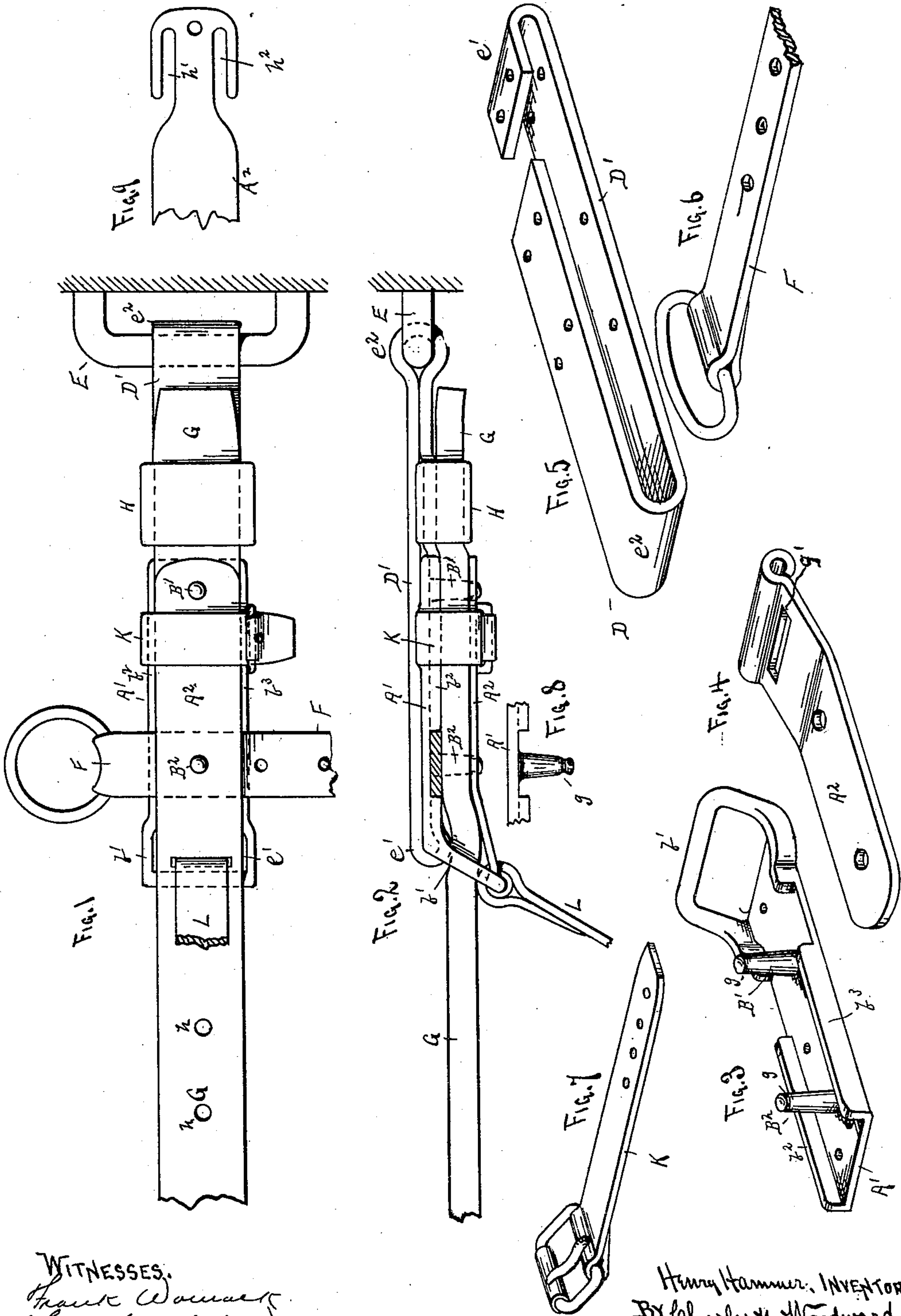

WITNESSES:
Frank W. W. W.
The Kimpfen

Henry Hammer, INVENTOR,
By Charles H. Woodward,
Attor.

UNITED STATES PATENT OFFICE.

HENRY HAMMER, OF MOUNTAIN LAKE, MINNESOTA.

TRACE-BUCKLE.

SPECIFICATION forming part of Letters Patent No. 636,334, dated November 7, 1899.

Application filed January 25, 1899. Serial No. 703,334. (No model.)

To all whom it may concern:

Be it known that I, HENRY HAMMER, a citizen of the United States, residing at Mountain Lake, in the county of Cottonwood and State of Minnesota, have made certain new and useful Improvements in Trace-Buckles, of which the following is a specification.

This invention relates to trace-buckles; and it consists in the construction, combination, and arrangement of parts, as hereinafter shown and described, and specifically pointed out in the claims.

In the drawings, Figure 1 is a side view, and Fig. 2 is a plan view, of the buckle complete, with a section of the trace or tug and other parts in place therein. Fig. 3 is a perspective view of the buckle-frame, and Fig. 4 is a perspective view of the "keeper" of the buckle detached. Fig. 5 is a perspective view of the connecting-strap of the buckle. Fig. 6 is a perspective view of a portion of the "belly-band" connection detached. Fig. 7 is a perspective view of the binding-strap detached. Fig. 8 is a detached detail of one of the studs of the buckle-frame, illustrating its construction more fully. Fig. 9 is a detached detail of one end of the keeper, illustrating a modification in the construction.

A' is the buckle-frame, formed with a loop b' at one end, to which a keeper or top binding-plate A² is hinged, as shown.

b² b³ are ribs along the sides of the frame A', and B' B² are two pins or studs rising from the frame and passing by their upper ends through the holes in the keeper A² when the latter is folded over parallel to the base-frame, as shown in Figs. 1 and 2.

D' is a strap riveted or otherwise secured to the base A', and with one end at e' folded over beneath the loop b' and riveted or otherwise secured to the base-frame, one or more rivets being passed through the three parts—two parts of the strap and one part of the base A'. The other end of the strap D' is longer and is formed into the loop e², which embraces the hame-loop E, the hame not being shown in the drawings, as it forms no part of the present invention. The strap D' is then carried backward from the loop e² and riveted fast to the base A', the ribs b² b³ serving as side supports to the strap, the stud B'

passing through the strap D' between the ribs, as shown.

Between the ends of the strap D' a vacant space is left in which the stud B² is placed, this vacant space being adapted to receive the belly-band strap F, as shown in Figs. 1 and 2.

G is a section of the trace or tug, which is passed through the loop b', over both the studs B' B² and the belly-band strap F, and with its end passed beneath a keeper-loop H, secured to the outer part of the strap D', as shown. Then when the keeper-plate A² is turned down in place, with the outer ends of the studs B' B² projecting through it, the trace or tug will be firmly secured in place, as shown. As a further means of security, the parts A' A² and the trace or tug G will be bound together by a small strap K, as shown.

The keeper-plate A will be provided with a slot g', into which the "holdback-strap" L may be secured, as shown.

The trace will be provided with the usual perforations h, so that it may be adjusted to shorten or lengthen the trace.

By this arrangement a very secure and simple buckle is produced, that not only provides for the secure holding of the trace or tug and other straps, but which may very readily be disconnected for the purpose of adjusting the trace or other parts.

The outer ends of the studs B' B² will preferably be formed with grooves g, encircling them just below their outer ends, and the holes in the keeper A² will be formed to fit tightly over the outer ends of the studs and be compressed slightly into the grooves g, to thereby assist in holding the keeper in place.

In Fig. 9 the free end of the keeper A² is shown with open slots h' h², into which the binder-strap K may be interwoven, and thus dispense with the buckle thereon. This is an important feature of my invention, as it insures the perfect holding of the binding-strap K and without the necessity for the employment of buckles thereon.

Having thus described my invention, what I claim as new, and desire to secure by Letters Patent, is—

1. In a device for adjusting and connecting traces to hames, a base-plate, studs project-

ing from one side thereof, a loop at one end
and inclined toward the side of the plate hav-
ing the studs, annular depressions near the
ends of the studs, a strap connected to the
5 plain side of the base-plate and having its
ends folded over and engaging the studs to
the other side, said strap forming a loop at
one end of the base-plate to engage the staple
on the hame, a keeper-plate hinged to the
10 said loop on the plate and having perforations
adapting it to engage the depressions in the
studs, said keeper retaining the trace upon
the studs, substantially as described.

2. In a device for adjusting and connecting
15 traces to hames, a base-plate, studs project-
ing from one side thereof, a loop at one end
inclined toward the side of the plate having
the studs, annular depressions near the ends
of the studs, a strap connected to the plain

side of the base-plate and having its ends 20
folded over and engaging the studs to the
other side, said strap forming a loop at one
end of the base-plate to engage the staple on
the hame, a keeper-plate hinged to the said
loop on the plate, and having perforations 25
adapting it to engage the depressions in the
studs, and provided with open slots h' h^2 in
the free end, and a binding-strap adapted to
be passed into said open slots, whereby the
trace is retained upon said studs, substan- 30
tially as set forth.

In testimony whereof I have hereunto set
my hand in the presence of two subscribing
witnesses.

HENRY HAMMER.

In presence of—

J. H. DICKMAN,
D. G. HILBERT.