

(No Model.)

R. MILLER.  
UMBRELLA SUPPORT.

No. 602,662.

Patented Apr. 19, 1898.

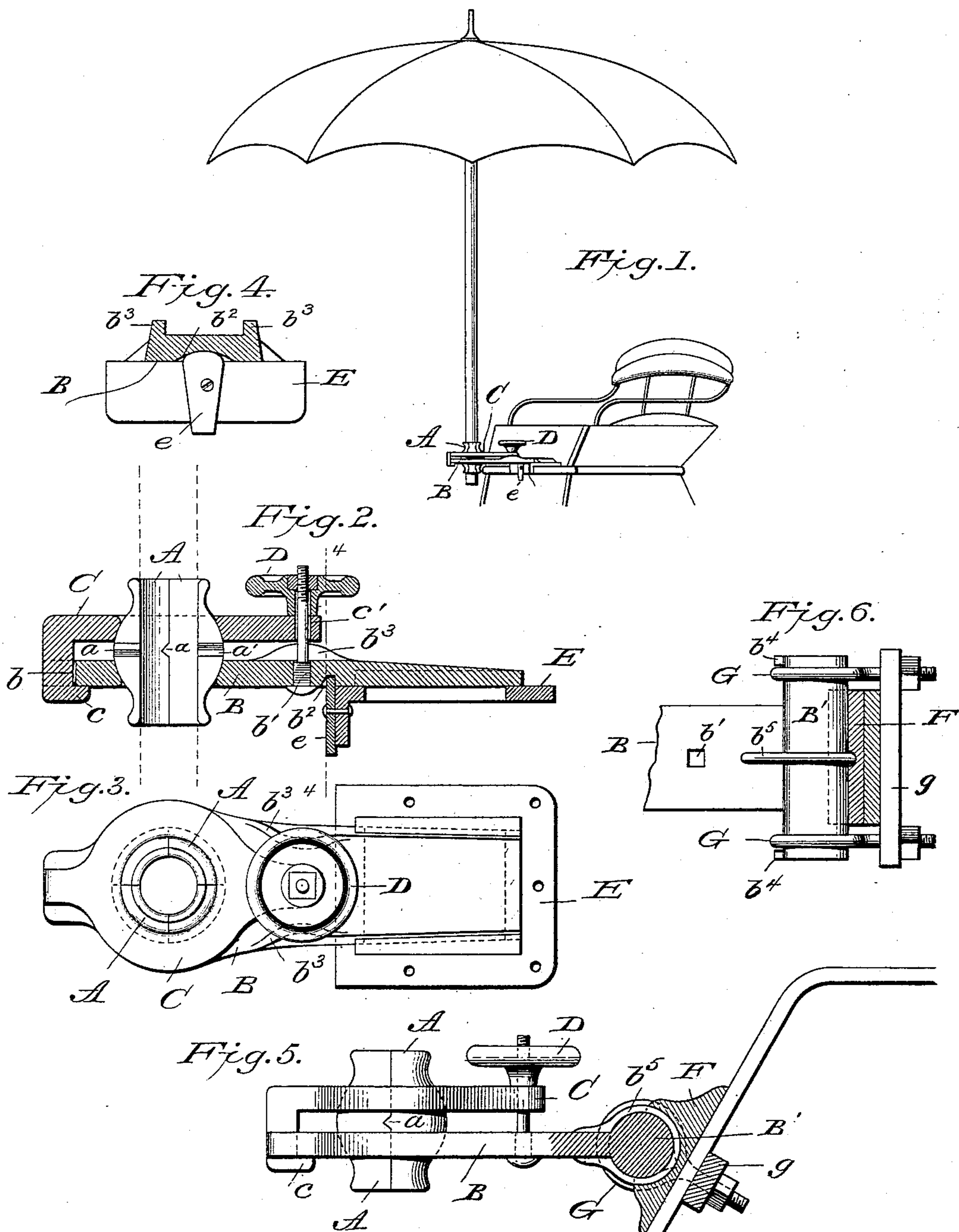

WITNESSES  
L. S. Elliott.  
Relle Elliott.

Richard Miller,  
INVENTOR,

By Eugene W. Johnson.  
Attorney.



# UNITED STATES PATENT OFFICE.

RICHARD MILLER, OF APPLETON, WISCONSIN.

## UMBRELLA-SUPPORT.

SPECIFICATION forming part of Letters Patent No. 602,662, dated April 19, 1898.

Application filed November 18, 1897. Serial No. 658,951. (No model.)

*To all whom it may concern:*

Be it known that I, RICHARD MILLER, a citizen of the United States of America, residing at Appleton, in the county of Outagamie and State of Wisconsin, have invented certain new and useful Improvements in Umbrella-Supports; and I do hereby declare the following to be a full, clear, and exact description of the invention, such as will enable others skilled in the art to which it appertains to make and use the same, reference being had to the accompanying drawings, and to letters of reference marked thereon, which form a part of this specification.

This invention relates to certain new and useful improvements in umbrella holders or supports, the object being to provide a simple, cheap, and effective clamp and holder for an umbrella-staff or other similar object, the invention being applicable either to the seats of vehicles or the seat-supports of farm implements.

My invention consists in the special construction and combination of the parts which embody clamping-plates, between which are positioned quartered blocks which engage with each other and grasp the staff, said blocks being forced together and positioned between plates, the lower or base plate being connected to a seat or standard, as will be hereinafter set forth.

In the accompanying drawings, which illustrate my invention, Figure 1 is a view in perspective, showing the application of the invention to the seat of a vehicle. Fig. 2 is a longitudinal sectional view. Fig. 3 is a plan view. Fig. 4 is a sectional view through the line 4 4 of Fig. 2. Fig. 5 is a side elevation, partly in section, showing the application of my invention to a seat-support; and Fig. 6 is a detail plan view, partly in section.

In the several figures of the drawings, A refers to each of the four sections of the clamping-blocks which engage with the staff or handle of the umbrella. Each of the clamping-blocks is provided on one side with a V-shaped projecting portion *a* and on the opposite side with a similarly-shaped recess *a'*, which permits the sections to engage with each other, though said sections may be separated slightly from each other. The outer edges of each section are spherical, and their

upper and lower edges are shaped so as to provide beads, the ends being rounded, as shown.

B refers to a base-plate which is provided with an aperture through which the sections of the clamping-blocks pass and are seated, and the outer end has a notch or recess *b*, while the opposite side of the base-plate has a rectangular aperture *b'* of sufficient size to receive the headed end of an ordinary carriage-bolt.

C refers to the top plate, which is provided with an aperture through which the clamping-blocks pass, and the inner end has a circular aperture *c'* for the passage of the rounded portion of the bolt hereinbefore referred to. The outer end of the plate C has a depending portion centrally disposed, which is adapted to pass through the recess *b* in the outer end of the lower or base plate, and this depending portion has an inwardly-projecting lug *c*, which engages with the under side of the base-plate adjacent to the recess.

D refers to a hand-wheel having a depending hub or central portion, which is adapted to bear on the upper face of the plate C, adjacent to the aperture *c'*, and this hand-wheel is provided with a rectangular recess in which is seated an ordinary nut, which engages with a bolt. This construction of the hand-wheel permits the use of an ordinary carriage-bolt, so that when the thread thereof or the nut becomes worn it can be readily replaced.

When the holder or umbrella-support hereinbefore described is intended to be applied to the seat of a vehicle, as shown in Fig. 1, the under side of the base-plate is provided with a transverse recess *b<sup>2</sup>*, and in order to make up for the weakening of the plate the opposite side has formed thereon reinforcing-flanges *b<sup>3</sup>*, which are positioned opposite the bolt-aperture and on a line with the recess. The base-plate is also extended and has tapered and beveled edges for engagement with a plate E, which is secured to the seat of the vehicle by screws or bolts, and the forward edge of this plate depends and has attached thereto a turn-button *e*, which engages with the recess and holds the base-plate B in positive engagement with the plate attached to the vehicle-seat, said plate having flanges, as shown.



When it is desired to attach the umbrella-holder to a seat-standard, the plate B is formed with a projecting portion B', which extends beyond each edge of the plate B, and said projecting portion is provided with lugs  $b^4$ , as well as a central flange  $b^5$ . A block F, having a concave recess, is adapted to engage with the rounded portion and with the flange thereon.

G refers to eyebolts, the eyes of which engage with the laterally-extended portions of the plate B, and said eyebolts pass through a cross-bar  $g$ , with which the clamp-nuts engage. The construction shown in Figs. 5 and 6 admits of the device being used with a seat support or standard, as in harvesters or other agricultural implements, where the same is usually inclined. It also admits of the plate B being adjusted, so as to be maintained in a horizontal position.

The device hereinbefore described, though designed primarily as an umbrella-support, may be used for holding flagstaves or other cylindrical rods.

Having thus described my invention, what I claim as new, and desire to secure by Letters Patent, is—

1. A rod or staff support comprising a plurality of clamping-blocks, a pair of plates

having apertures to receive the same, one of said plates having formed therein a recess and the other a downwardly-projecting lug for engagement with the plate beneath and a bolt and nut for drawing the end of the upper plate toward the lower one so that the clamping-blocks will be forced together and upon the staff or rod which is passed there-through, substantially as shown.

2. A holder or support for rods or staffs comprising a clamping-block made up of quadrant sections each provided centrally with a recess and a projecting portion which registers with the recess of the adjacent section, a base-plate having therethrough an aperture for the reception of the clamping-block, a plate similarly apertured and provided at one end with a depending lug for engagement with the under side of the base-plate the opposite end being engaged by a set-screw mounted on a bolt which passes through the base-plate, substantially as shown and for the purpose set forth.

In testimony whereof I affix my signature in presence of two witnesses.

RICHARD MILLER.

In presence of—

O. C. MITCHELL,

D. E. VAUGHN.