

(No Model.)

J. T. MUMFORD.
DOOR CHECK.

No. 597,425.

Patented Jan. 18, 1898.

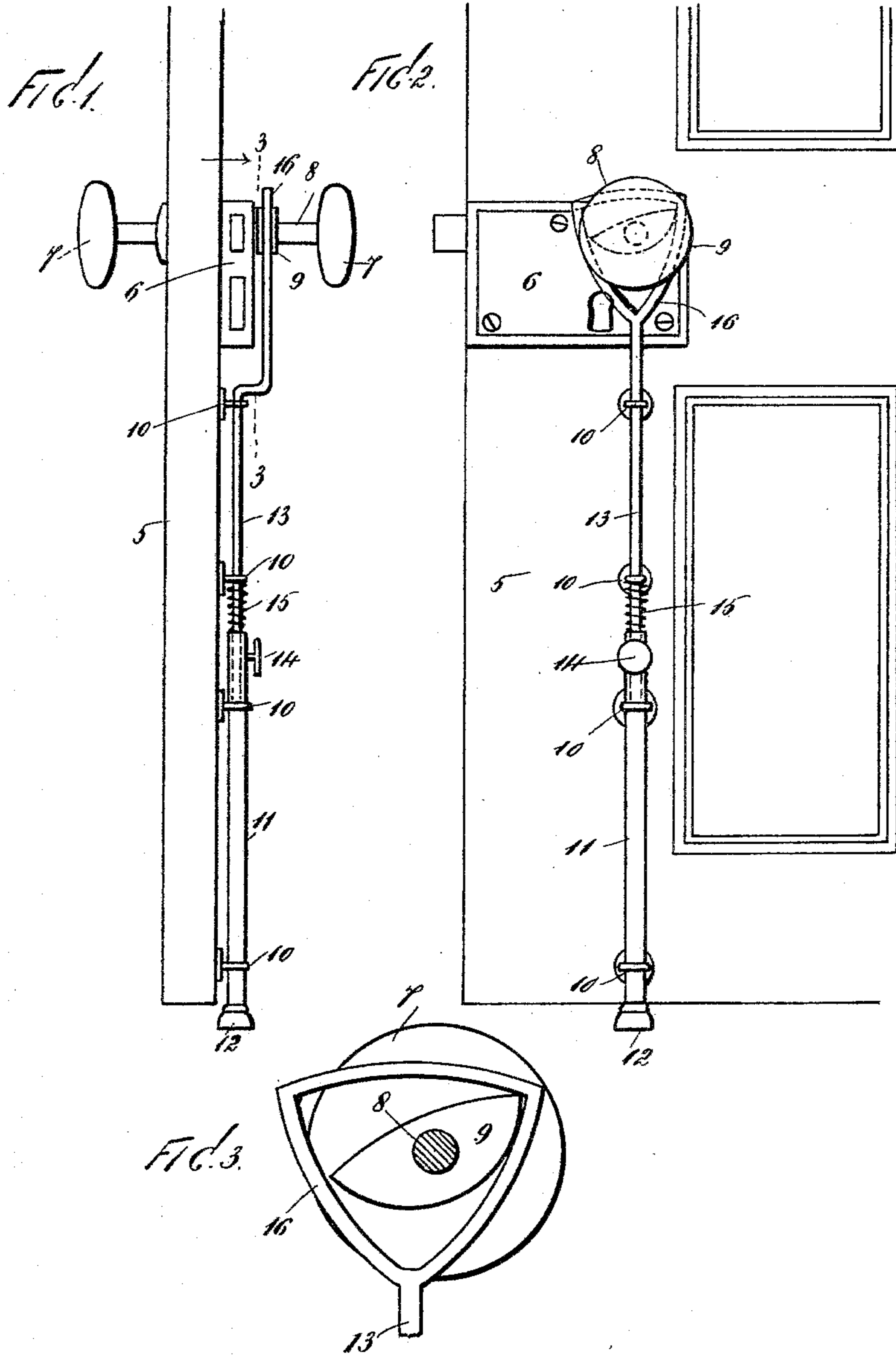

WITNESS

Wilfred Lukinaw.
C. Gerst.

INVENTOR

James T. Mumford.
BY
Edgar Tate & Co.
ATTORNEYS.

UNITED STATES PATENT OFFICE.

JAMES THOMAS MUMFORD, OF CENTRAL CITY, IOWA.

DOOR-CHECK.

SPECIFICATION forming part of Letters Patent No. 597,425, dated January 18, 1898.

Application filed April 3, 1897. Serial No. 630,567. (No model.)

To all whom it may concern:

Be it known that I, JAMES THOMAS MUMFORD, a citizen of the United States, residing at Central City, in the county of Linn and State of Iowa, have invented certain new and useful Improvements in Door-Checks, of which the following is a full and complete specification, such as will enable those skilled in the art to which it appertains to make and use the same.

This invention relates to door-checks; and the object thereof is to provide an improved device of this class which may be used as a door-lock, but which is preferably designed for holding the door in a closed position or partially open for ventilation and other purposes.

The invention is fully disclosed in the following specification, of which the accompanying drawings form a part, in which—

Figure 1 is an edge view of a door provided with my improved fastening device; Fig. 2, a side view thereof, and Fig. 3 a section on the line 3 3 of Fig. 1.

In the drawings forming part of this specification the separate parts of my improvement are designated by the same numerals of reference in each of the views, and in said drawings I have shown at 5 a door which is provided with the usual lock 6 and knobs 7, which are mounted on the shaft 8, which passes through the lock in the usual manner.

Secured on the shaft 8, adjacent to the face or inner side of the lock 6, is an elliptical-shaped cam-block 9, and I also secure to the door below the lock a plurality of keepers 10, which are preferably four in number. Passing through the lower two keepers 10 and adapted to slide therein is a tube 11, the lower end of which is provided with a foot, which is preferably composed of rubber, but which may be composed of any desired material, and passing through the upper keepers 10 is a rod 13, the lower end of which passes into the upper end of the tube 10, and may be adjusted therein by means of a set-screw 14, and between the lower keeper 10, through which the rod 13 passes, and the upper end of the tube 11 is placed a spiral spring 15, the func-

tion of which is to force the tube 11 downwardly, so that the foot 12 thereof will press upon the floor.

The upper end of the rod 13 is provided with a stirrup 16, which incloses the elliptical-shaped block 9, and said block 9 constitutes a cam by which the rod 13 and the tube 11 may be raised when one of the knobs 7 of the lock is turned.

The operation will be readily understood from the foregoing description when taken in connection with the accompanying drawings and the following statement thereof.

By turning one of the knobs 7 the rod 13 and the tube 11 may be raised so that the door may be free to swing on its hinges, and when said knob is released the said rod and the said tube will be forced downwardly by the spring 15, so that the foot 12 will bear upon the floor and securely hold the door in the desired position.

This device is simple in construction and operation and is perfectly adapted to accomplish the result for which it is intended, and it will be apparent that changes in and modifications of the construction herein described may be made without departing from the spirit of my invention or sacrificing its advantages.

Having fully described my invention, I claim as new and desire to secure by Letters Patent—

1. A door-check, consisting of a cam-block secured to the knob-spindle, a rod provided with a stirrup which incloses said cam-block, a tube into which the lower end of said rod passes, keepers secured to the door by means of which said rod and said tube are held in place, and a spring mounted on said rod between one of said keepers and the upper end of said tube, substantially as shown and described.

2. A door-check, consisting of a cam-block secured to the knob-spindle, a rod provided with a stirrup which incloses said cam-block, a tube into which the lower end of said rod passes, keepers secured to the door by means of which said rod and said tube are held in place, and a spring mounted on said rod be-

tween one of said keepers and the upper end
of said tube, said tube being provided at its
lower end with a foot which is adapted to
bear upon the floor and with a set-screw by
5 means of which said rod may be adjusted
therein, substantially as shown and described.

In testimony that I claim the foregoing as

my invention I have signed my name, in pres-
ence of the subscribing witnesses, this 30th
day of March, 1897.

JAMES THOMAS MUMFORD.

Witnesses:

WALTER ROCKWELL KIBBER,
AMBROSE PERRY WARD.