

(No Model.)

W. A. ROWAN.  
NURSERY BOTTLE SUPPORT.

No. 577,391.

Patented Feb. 16, 1897.

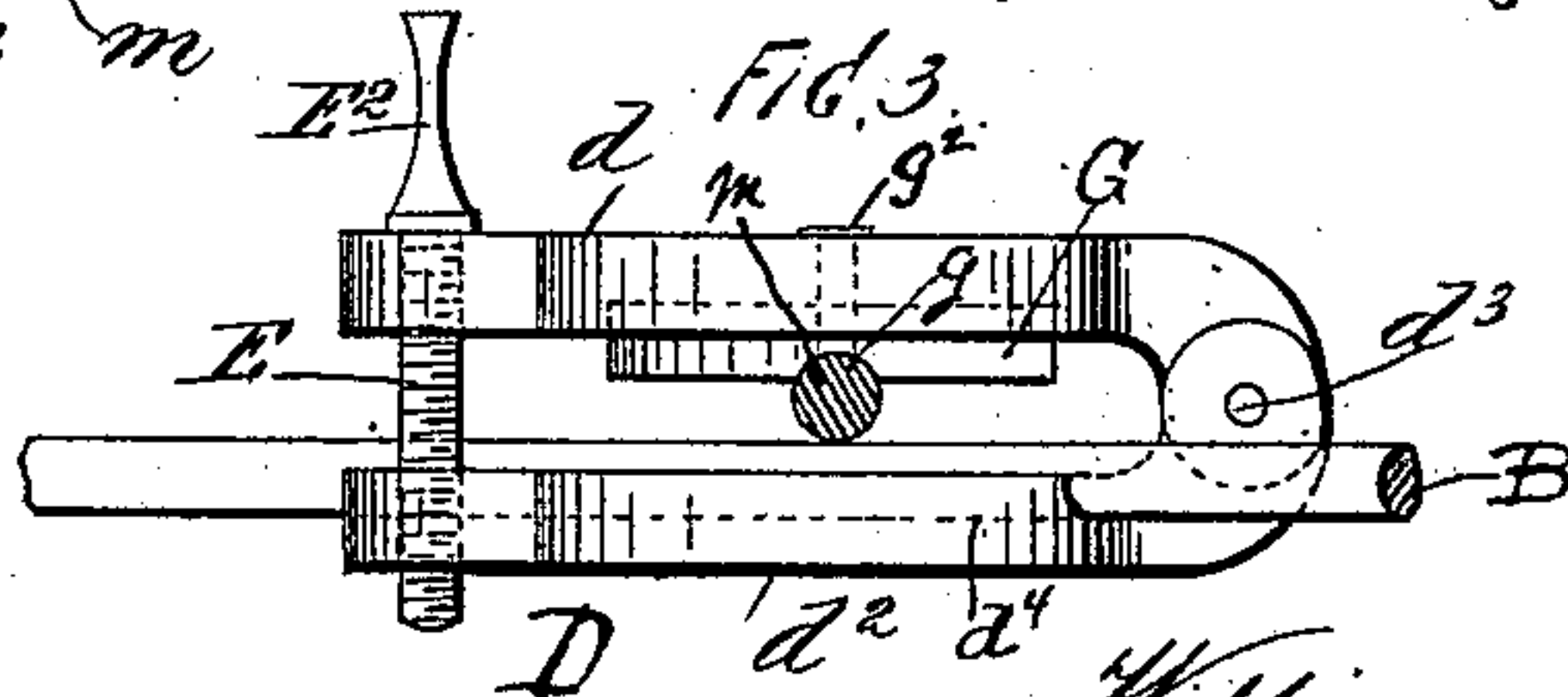
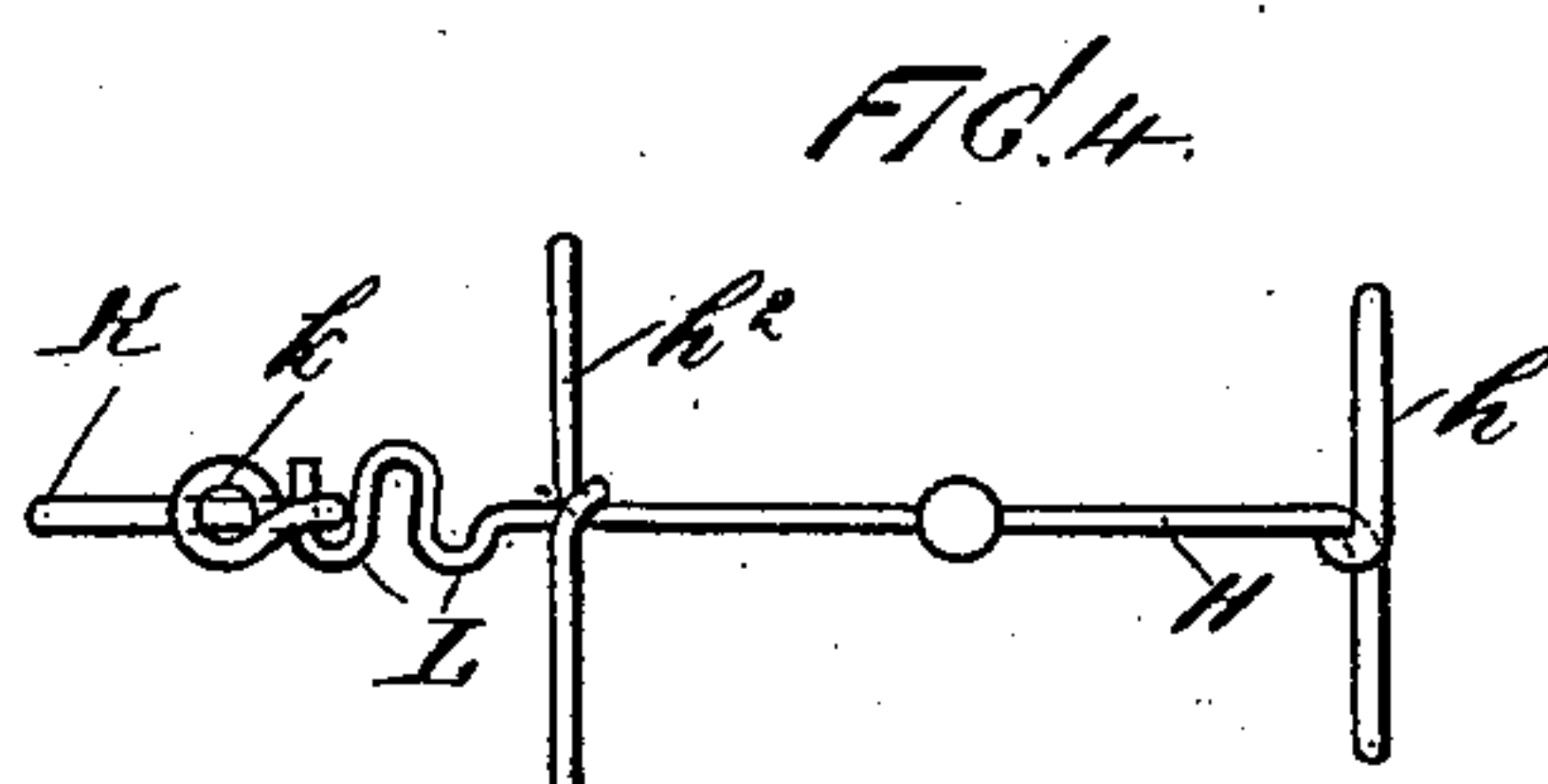
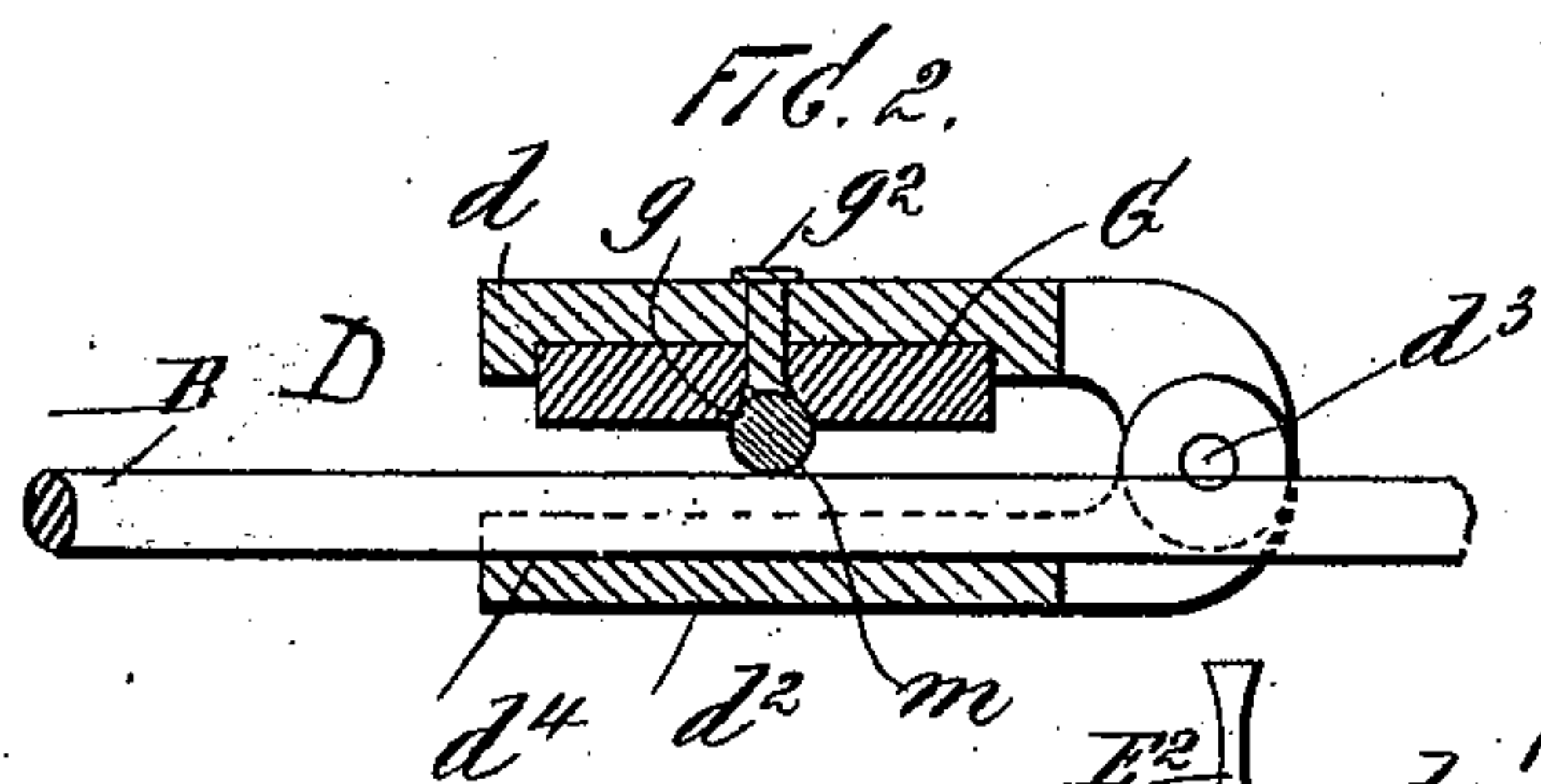
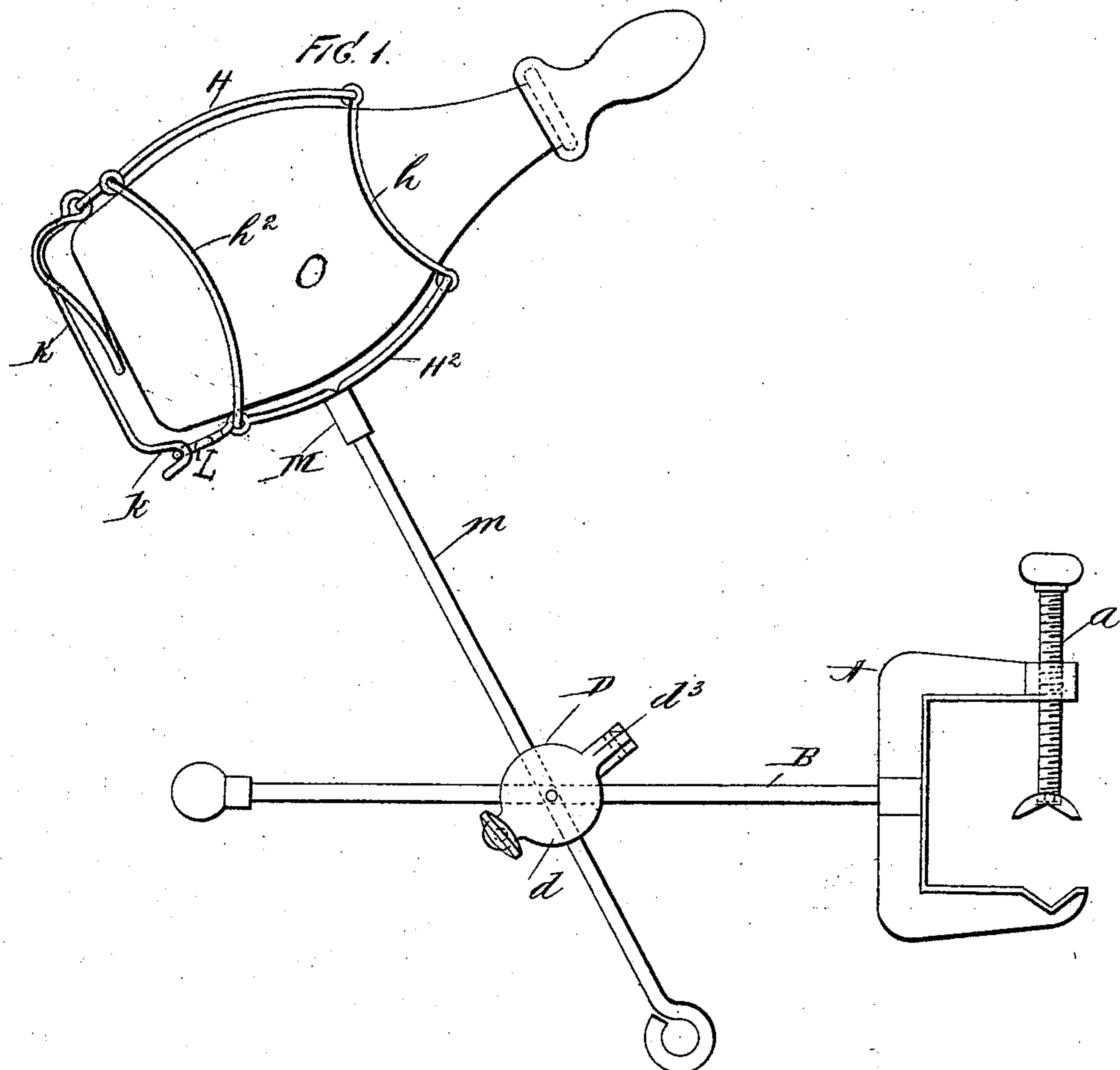

WITNESSES:

John Ruelker,  
C. Gersh.

INVENTOR

William A. Rowan,  
BY  
Edgar Tate & Co.  
ATTORNEYS.



# UNITED STATES PATENT OFFICE.

WILLIAM A. ROWAN, OF WEST HOBOKEN, NEW JERSEY.

## NURSERY-BOTTLE SUPPORT.

SPECIFICATION forming part of Letters Patent No. 577,391, dated February 16, 1897.

Application filed November 27, 1895. Serial No. 570,267. (No model.)

*To all whom it may concern:*

Be it known that I, WILLIAM A. ROWAN, a citizen of the United States, and a resident of West Hoboken, in the county of Hudson and State of New Jersey, have invented certain new and useful Improvements in Nursery-Bottle Supports, of which the following is a specification, reference being had to the accompanying drawings, forming a part thereof, in which similar letters of reference indicate corresponding parts.

This invention relates to supports for nursery-bottles, and the object thereof is to provide an effective device of this class whereby a nursery-bottle may be held at any desired angle or supported in any desired position; and with this and other objects in view the invention consists in the construction, combination, and arrangement of parts hereinafter described and claimed.

The invention is fully disclosed in the following specification, of which the accompanying drawings form a part, in which—

Figure 1 is a side view of my improvement, showing the nursery-bottle supported thereby; and Figs. 2, 3, and 4 represent details of the construction.

In the practice of my invention I provide an ordinary clamp A, having a set-screw  $a$ , and which is adapted to be connected with a table, bedpost, bedstead, or any other support, and said clamp is provided with a projecting arm B, which passes through a clamp D, composed of two jaws  $d$  and  $d^2$ , which are hinged together at one end, as shown at  $d^3$ , and said jaws are connected at the opposite end by a screw-threaded bolt E, provided with a head  $E^2$ . The jaw  $d^2$  is provided on its inner side with a longitudinal groove  $d^4$ , in which the arm B rests, and the jaw  $d$  is provided on its inner side with a plate G, having a transverse groove  $g$ , and extending through said jaw and plate is a bolt  $g^2$ , and said plate is circular in form and free to revolve on the bolt  $g^2$ . I also provide a wire cage or frame in which a bottle is adapted to be placed, said cage or frame consisting of side pieces H and  $H^2$  and end rings  $h$  and  $h^2$ , and pivotally connected with or hinged to the side piece H is a bottom or clamp K, the other end of which is provided with a hook  $k$ , which is

adapted to engage with a hook or hooks L, secured to or formed on the lower end of the side  $H^2$ .

Secured to or formed on the side  $H^2$  is a socket M, with which is connected a rod  $m$ , which passes transversely between the jaws  $d$  and  $d^2$  of the clamp D, as shown in Figs. 1 and 2. The rod M rests in the transverse groove  $g$  of the plate G and is adapted to be clamped in contact with the rod or arm B by means of the screw-bolt E, and by means of this arrangement it will be seen that the bottle O may be held in any desired position, vertically, longitudinally, or at an angle to either of these positions and with the nozzle thereof directed downwardly, if desired, and it will also be seen that the bottle is capable of being oscillated or rotated either in a vertical or a horizontal position or at an angle to either of these positions, as will be apparent. I thus provide a simple and effective device by means of which a nursery-bottle may be held at any desired adjustment, and thus be made to accommodate itself to almost any possible position of the party by which it is to be used.

My invention is not limited to the exact form, construction, and arrangement of parts herein described, and I therefore reserve the right to make all such alterations therein and modifications thereof as fairly come within the scope of the invention.

Having fully described my invention, its construction and operation I claim as new and desire to secure by Letters Patent—

1. A support for a nursery-bottle having a clamp A provided with an arm B, a basket or cage for a bottle, a rod secured to said cage, a clamp D movably attached to said rod, and having on one side thereof a longitudinally-extending groove and on the other side thereof a plate having a transverse groove therein, said arm B secured at one end to said clamp A and being engaged by said clamp D, said arm passing through said longitudinally-extending groove, while said rod snugly fits said plate-groove, all of said parts being combined substantially as described.

2. A basket or cage for a nursery-bottle, comprising a wire frame composed of side pieces, and upper and lower rings, and a bot-

tom-fastening device or clamp hinged to one side of the frame and provided with a hook *k*, hooks *L* adapted to be engaged by said hook *k*, a rod secured to said frame a pivot-  
5 ally-connected arm engaging said rod and a clamp secured to one end of said arm, all of said parts being combined substantially as and for the purposes described.

In testimony that I claim the foregoing as my invention I have signed my name, in presence of the subscribing witnesses, this 26th day of November, 1895.

WILLIAM A. ROWAN.

Witnesses:

C. GERST,

M. A. KNOWLES.