

(No Model.)

C. B. DEMAREST.
FOOT REST.

No. 518,489.

Patented Apr. 17, 1894.

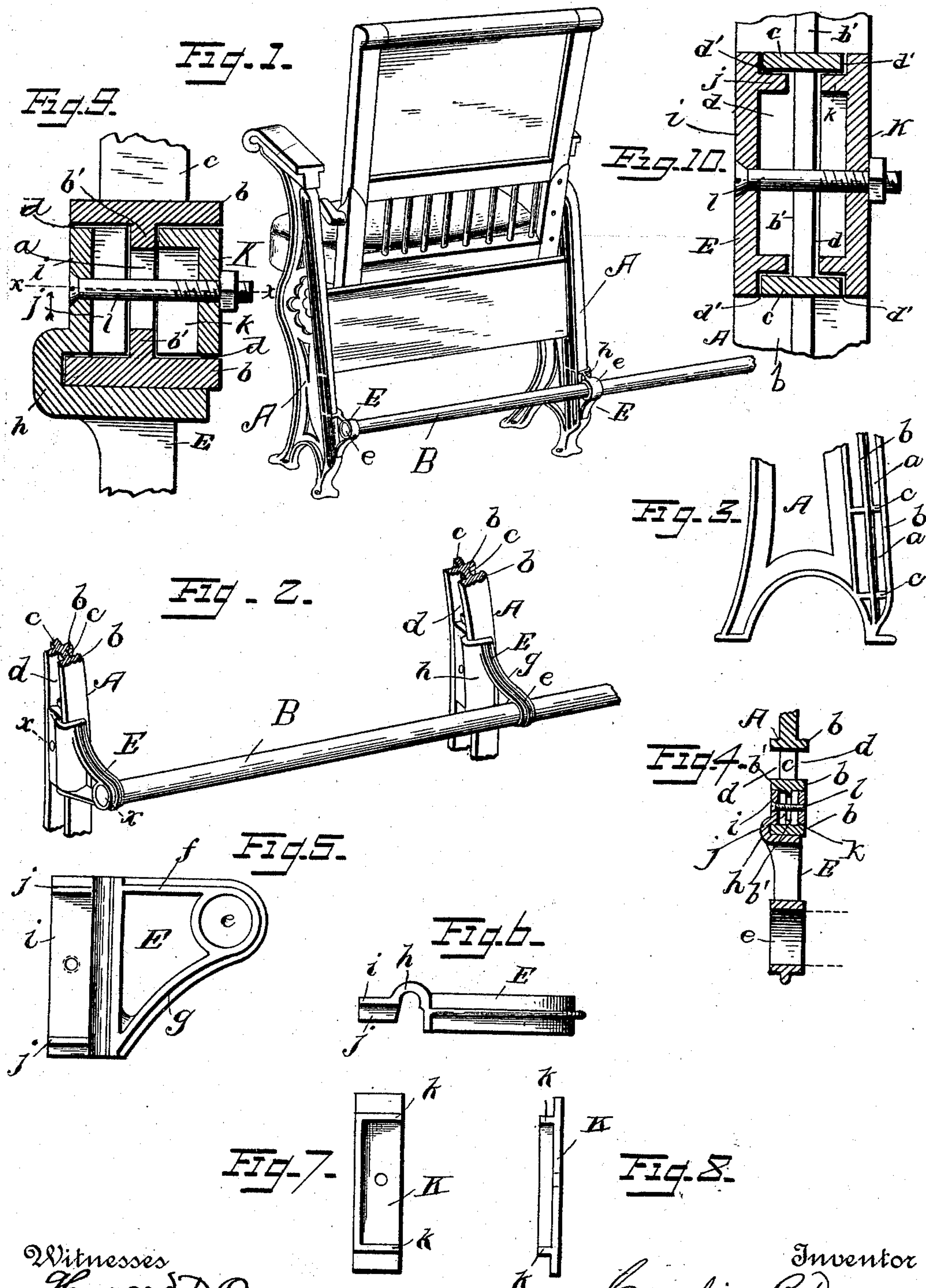

Witnesses
Howard D. Orr.
John Mayden

Inventor
Cornelius B. Demarest
by
M. W. Pack
His Attorney

UNITED STATES PATENT OFFICE.

CORNELIUS B. DEMAREST, OF BROOKLYN, ASSIGNOR TO ANDREWS
DEMAREST SEATING COMPANY, OF NEW YORK, N. Y.

FOOT-REST.

SPECIFICATION forming part of Letters Patent No. 518,489, dated April 17, 1894.

Application filed June 30, 1893. Serial No. 479,253. (No model.)

To all whom it may concern:

Be it known that I, CORNELIUS B. DEMAREST, a citizen of the United States, residing at Brooklyn, in the county of Kings and State of New York, have invented certain new and useful Improvements in Foot-Rests for Chairs; and I do hereby declare the following to be a full, clear, and exact description of the invention, such as will enable others skilled in the art to which it appertains to make and use the same, reference being had to the accompanying drawings, which form part of this specification.

My invention relates to foot rests for chairs used in opera halls and in other like public buildings, its object being to provide an adjustable support for such foot rests which is simple and durable in construction and which may be applied to opera chairs now in common use, and to this end my invention consists of the several details of construction and arrangement of parts hereinafter described and more particularly pointed out in the claims.

Referring to the drawings; Figure 1, is a perspective view of a chair with my invention applied thereto, the foot rest extending to an adjoining chair being broken away. Fig. 2, is a similar view on an enlarged scale, of the foot rest, its supporting brackets and parts of the seat standards, the brackets being in reversed position from those shown in Fig. 1. Fig. 3, is a side elevation of a portion of the seat standard showing the cast open work in one of its sides. Fig. 4, is a cross sectional view on the line xx of Fig. 2, showing the manner in which the bracket is attached. Fig. 5, is a side elevation of the bracket. Fig. 6, is a top view of the bracket. Fig. 7, is a side elevation of the clamping plate. Fig. 8, is an edge view of the same. Fig. 9 is an enlarged view of the bracket and attachment shown in Fig. 4; and Fig. 10, is a vertical section on line XX of Fig. 9, looking in the direction designated by the arrow.

Similar letters of reference indicate corresponding parts in each figure of the drawings.

A represents the seat standards which are usually made of cast metal. The rear portion of these standards are provided with elongated openings a , one above the other, forming an ornamental net work in which strips

of wood are usually placed and made to serve as foot rests and hat guards.

As shown in Figs. 2, 4 and 8, the rear portions of the standards consist of flat parallel bars b , having ribs b' at the center of their inner sides forming the walls of the elongated opening a . These bars are united at about midway of their width by webs c , which are somewhat narrower than the bars b , and are arranged at intervals between the bars and form shallow recesses d' with the outer edges of the bars, at the points of their union, while the ribs b' form deep recesses d , between the edges of the bars on each side of the opening a .

E represents a bracket having a ring e , for the reception of the rod B which serves as a foot rest. The ring E is substantially in a line with one end of the attaching plate i , of the bracket as seen in Fig. 5, and is connected to the base of the bracket by the short arm f , at a right angle to the base, and the longer arm g , forming an acute angle with the base. The bracket E is adapted to fit on either side of the standard, and by turning it upside down in changing it from one side to the other, the vertical plane of the ring e , will be changed so as to lower or elevate the rod B as desired. The bracket is provided with an outwardly curved and grooved portion h , which fits over the edge of the bar b , of the standard, and the ends of the attaching plate i , rest on the webs c , in the shallow recesses d' formed with the edges of the bars, while the lugs j , on the under side of the plate pass into the deep recess d , formed by the ribs b' on each side of the elongated opening a .

K represents a clamping plate adapted to fit into the shallow recess on the opposite side of the standard from the plate i , of the bracket, and this plate is also provided with lugs k , which correspond to the lugs j , on the attaching plate of the bracket and fit into the deep recess between the bars. The plates of the brackets with their lugs and the clamps, having been seated in the shallow and deep recesses on opposite sides of the standards A, are secured together by bolts or screws l , passing through the elongated openings a , securing them to the standard. It will be observed that by reversing or turning the brackets upside down in changing them from one side of

the standards to the other, the foot rests will have two adjustments in height from the floor in each elongated opening. Standards having a series of elongated openings, such as have been hereinbefore described, being old and in common use, my adjustable brackets and foot rest, may be applied to chairs already placed in position.

Having thus fully described my invention, what I claim as new, and desire to secure by Letters Patent of the United States, is—

1. The combination with seat standards having recesses on opposite sides and elongated openings connecting said recesses, of brackets having attaching plates a foot rest held by said brackets, said plates adapted to fit in the recesses on either side of the standards, clamping plates fitting in the opposite recesses and secured to the brackets and standards, the foot rest being adjusted in height by turning the brackets upside down and changing them from one side to the other of the standards, as and for the purpose set forth.

2. The combination with seat standards having shallow and deep recesses between their bars on opposite sides thereof and elongated openings connecting the said deep recesses, of brackets having attaching plates fitting in the shallow recesses and lugs on the

plates projecting into the deep recesses and resting on ribs of the bars in the deep recesses and clamping plates with lugs, fitting in the opposite recesses in the standards, said plates being secured together and to the standards through the elongated openings, and the brackets holding a foot rest bar, as and for the purpose set forth.

3. The combination with seat standards having shallow and deep recesses on opposite sides, and elongated openings connecting the said deep recesses, of foot rest brackets having attaching plates fitting in the shallow recesses with outwardly curved portions fitting over the edge of the bars, said plates having lugs thereon resting on ribs of the bars in the deep recesses and clamping plates having lugs thereon fitting into the recesses of the standards on the opposite sides of the bars from the brackets, said plates being secured together and to the standards through the elongated openings, and the brackets holding a foot rest bar, as and for the purpose set forth.

In testimony whereof I affix my signature in presence of two witnesses.

CORNELIUS B. DEMAREST.

Witnesses:

JAMES E. REDMAN,
M. H. LEONARD.