

(No Model.)

2 Sheets—Sheet 1.

R. CONWAY.  
HAND PLOW.

No. 516,521.

Patented Mar. 13, 1894.

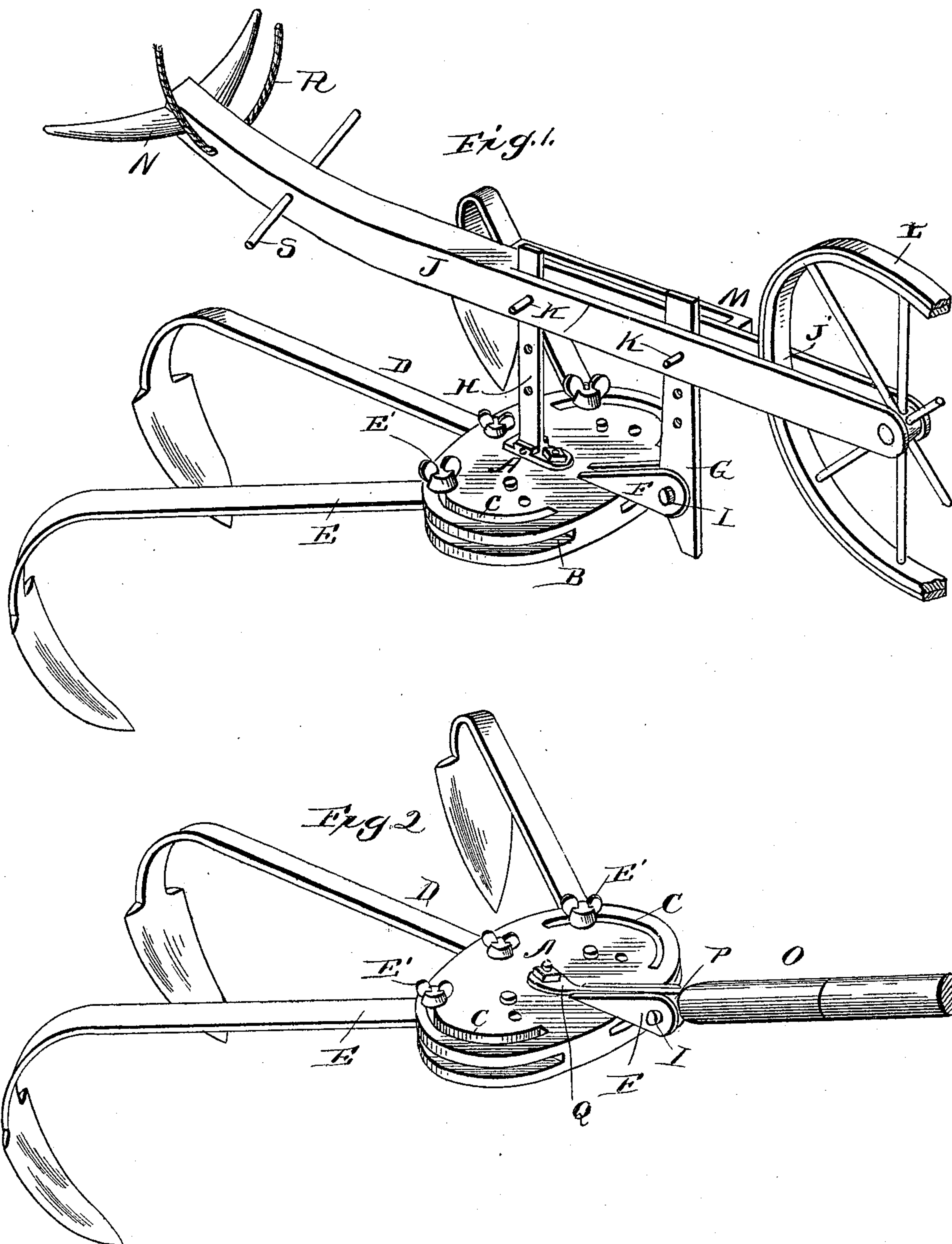

Witnesses  
J. M. Fowler Jr.  
Phadell Fitzgerald

Inventor  
Richard Conway  
By Leaman Patterson Mesick  
Attorneys.

(No Model.)

2 Sheets—Sheet 2.

R. CONWAY.  
HAND PLOW.

No. 516,521.

Patented Mar. 13, 1894.

Fig. 3.

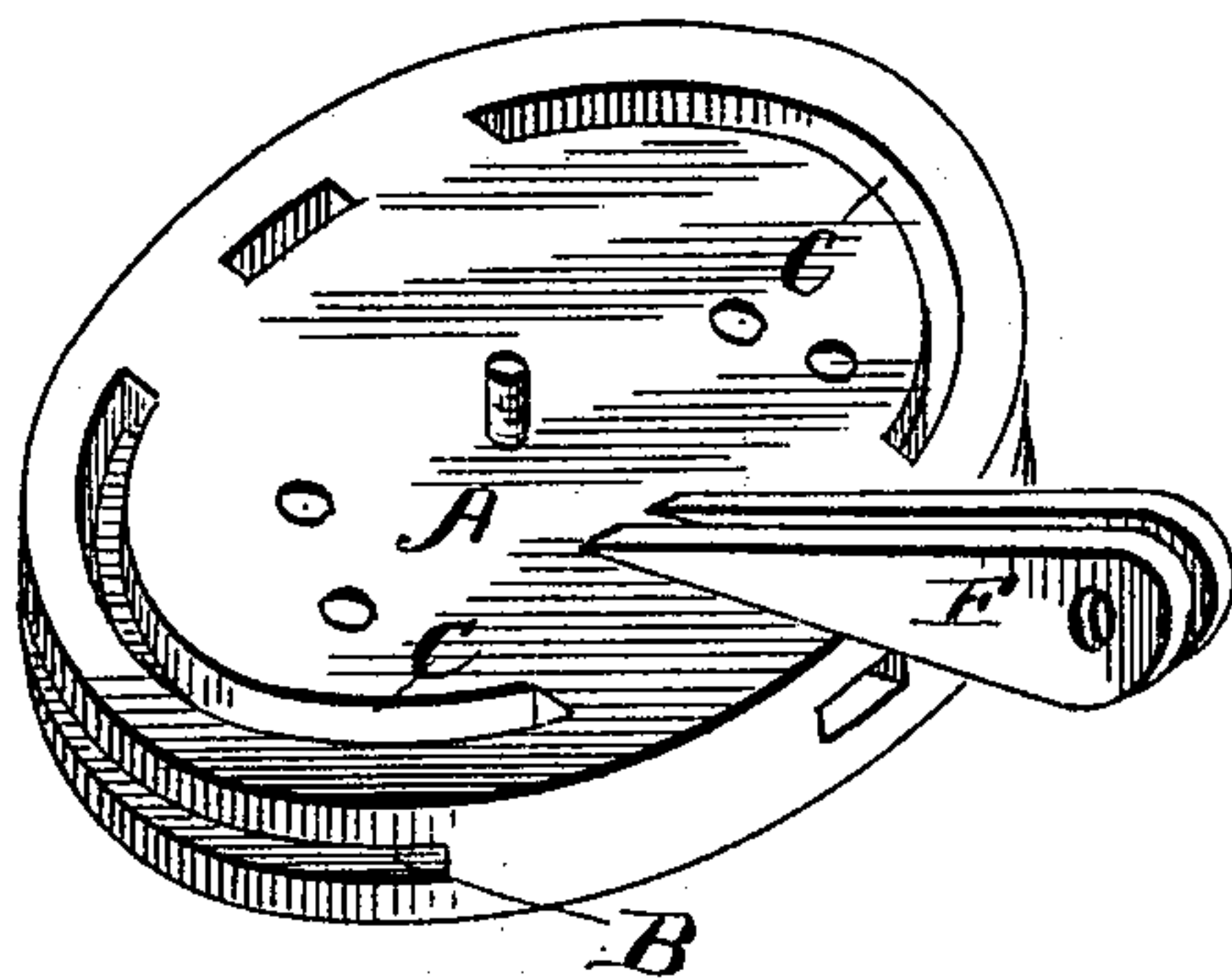

Fig. 4.

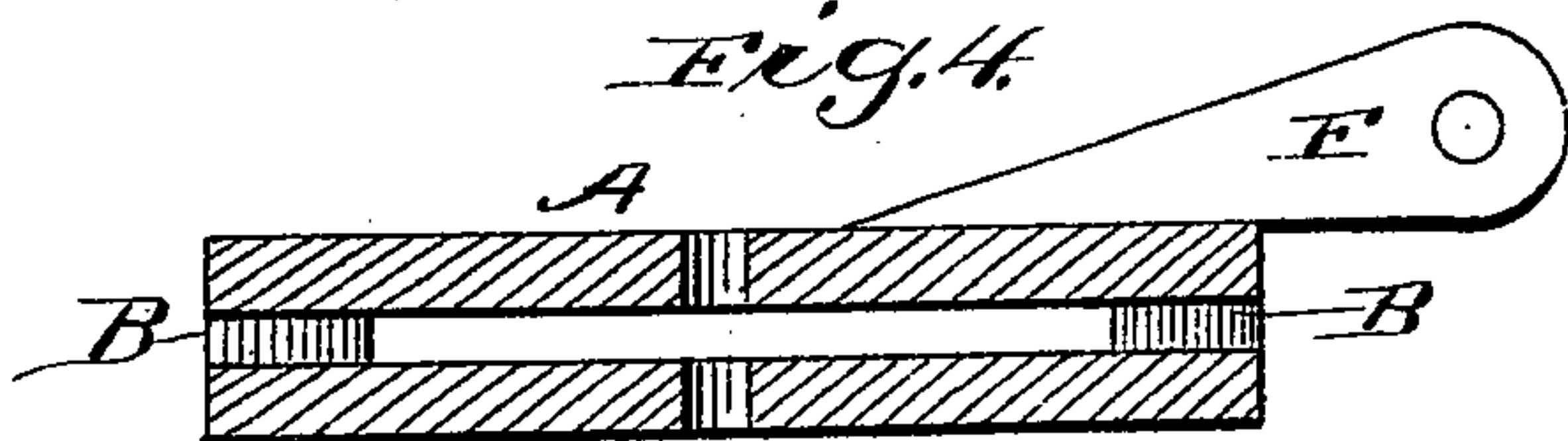
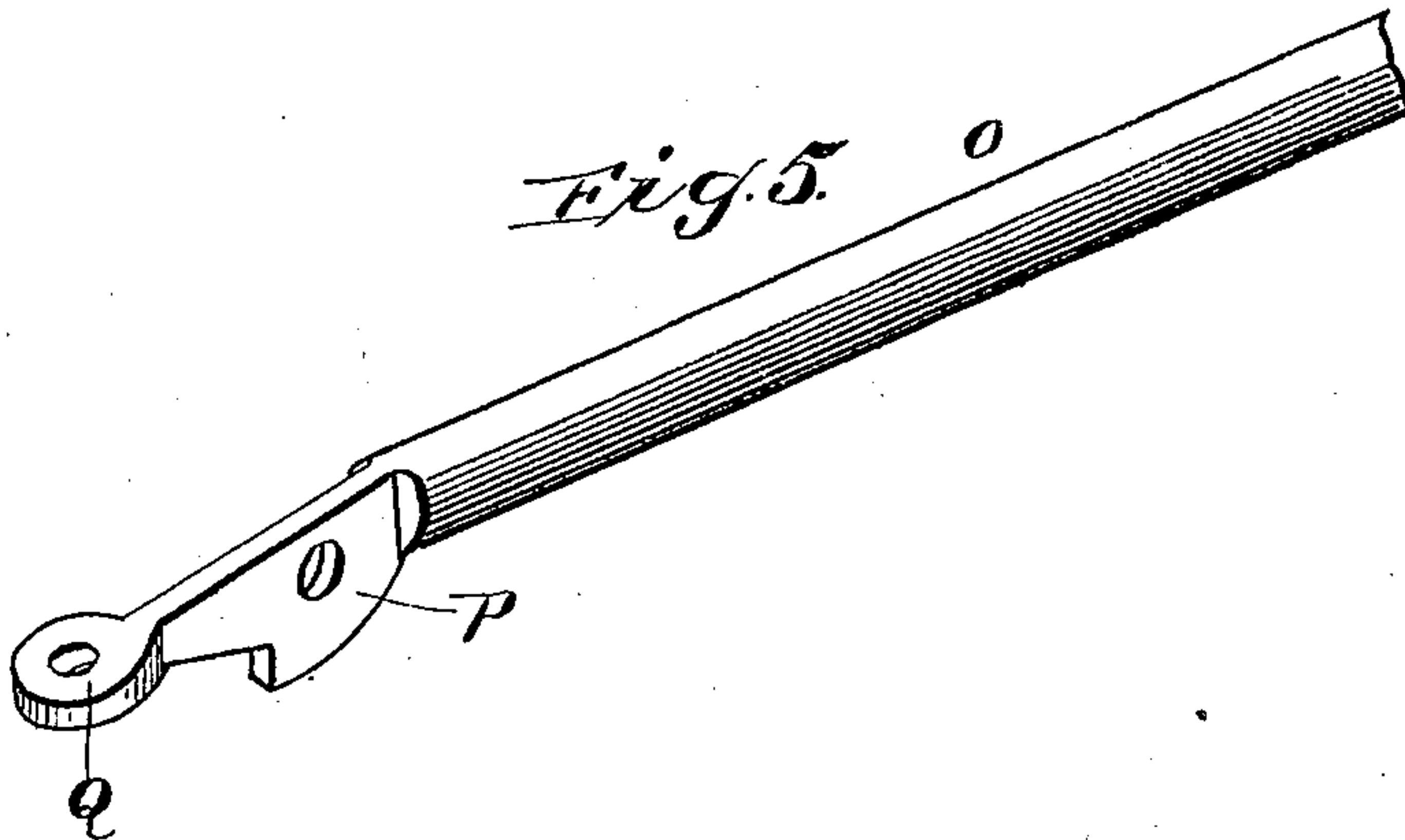

Fig. 5.



Witnesses

J. M. Fowler, Jr.  
Charles Q. Fitzgerald

Inventor

Richard Conway  
By Leveaux Patterson Nashit-  
Morse.



# UNITED STATES PATENT OFFICE.

RICHARD CONWAY, OF ARGENTVILLE, MISSOURI.

## HAND-PLOW.

SPECIFICATION forming part of Letters Patent No. 516,521, dated March 13, 1894.

Application filed July 17, 1893. Serial No. 480,738. (No model.)

*To all whom it may concern:*

Be it known that I, RICHARD CONWAY, of Argentville, in the county of Lincoln and State of Missouri, have invented certain new and useful Improvements in Hand-Plows; and I do hereby declare the following to be a full, clear, and exact description of the invention, such as will enable others skilled in the art to which it pertains to make and use it, reference being had to the accompanying drawings, which form part of this specification.

My invention relates to an improvement in hand plows; and it consists in the novel features of construction hereinafter fully described and more especially referred to in the claims.

The object of my invention is to construct an improved plow which may be either pushed by the operator with a portion of its weight supported upon a drive wheel, or pulled by means of a projecting handle which may be as readily applied as the wheel mechanism is removed.

Referring to the accompanying drawings: Figure 1, is a perspective view of my improved plow showing the wheel mechanism applied thereto. Fig. 2, is a similar view having the projecting handle applied thereto. Fig. 3, is a detached view of the head to which the teeth are secured. Fig. 4, is a longitudinal sectional view of the same. Fig. 5 shows the handle to be used when the wheel frame is removed.

A designates the head having depressions B formed in its ends which communicate with the upper surface of the head through curved slots C. A central tooth D is projected from the head being secured in a suitably formed recess, while confined at their inner ends within depressions B are teeth E carrying set screws E' which are adapted to move in groove C, and in this manner the same may be separated or contracted at will, and the cultivator and the plow thus made to cover a large or small expanse of ground. The pivotal point of the side piece being concentric with the slot C permits of the above mentioned adjustment.

Projecting upward and forward from the top surface of head A is the support F and confined therein at its lower end is the vertically extending and perforated standard G, while extending vertically from the head is a

perforated standard H, which is suitably secured in position by bolt I, as shown.

J is the beam of the wheel mechanism slotted longitudinally at its forward end, as shown at J', and into this slot project the standards G and H, in which they are confined in the desired adjustment by the transverse bolt K. The outer end of the beam is journaled to the drive wheel L. The bolt K confines in position the longitudinal portion M which may be secured to either side of the beam, for the purpose of securing the standards to the beam out of the draft line, as for instance, when the teeth are adjusted to straddle the row and the operator desires to walk between the rows. Upon the rear end of the beam is the push bar N and immediately in front of the same is the supporting strap R which passes around the operator's neck, while in front of this strap is the hand hold S for guiding the implement.

In Fig. 2, I show the plow provided with an outwardly extending handle O, which is formed upon its inner end with the flattened shank portion P perforated at the point where it is confined in fork F while its free inner end is flattened transversely as shown at Q where it is clamped to the head by a bolt. Thus it will be seen that the plow may be operated by pushing the same forward upon the wheel with the teeth engaging the ground at the desired angle, or the wheel mechanism may be entirely removed by detaching the standards G and H, from the head and supplying handle O thereto, as above stated. The arrangement may be quickly accomplished and is of great convenience to the operator who may elect in which position he will operate the plow.

Having thus described my invention, what I claim, and desire to secure by Letters Patent, is—

1. An improved hand plow comprising a head having depressions in its respective ends, the said depressions communicating with the top surface of the head by means of semi-circular slots, teeth extended into the depressions and pivoted at their ends concentrically with said curve in which they are adapted to be adjusted in the desired position, and means for propelling the head, substantially as shown and described.

2. An improved plow comprising a head, prongs projecting therefrom, a projection extending upward and outward from the upper side of the head, a clamping bolt projected  
5 vertically through the head, and a means for propelling the head which is adapted to be secured thereto by the said projection and the clamping bolt, substantially as shown and described.
- 10 3. An improved plow comprising a head, teeth projecting therefrom, a fork projecting upward and outward from its upper side, a clamping bolt projected through the head, a standard projecting vertically from the fork  
15 and the said bolt, a beam adjustable upon

the upper portions of the standards, and a wheel at the forward end of the beam, substantially as shown and described.

4. An improved plow comprising a beam, a plowing device, standards connecting the  
20 same with the center of the beam, longitudinal strap M, and pins K for the purpose substantially as shown and described.

In testimony whereof I affix my signature in presence of two witnesses.

RICHARD CONWAY.

Witnesses:

LEE FRANK,  
JULIUS STROKER.