

(No Model.)

C. E. SANSOUY.  
FIRE ESCAPE.

No. 507,455.

Patented Oct. 24, 1893.

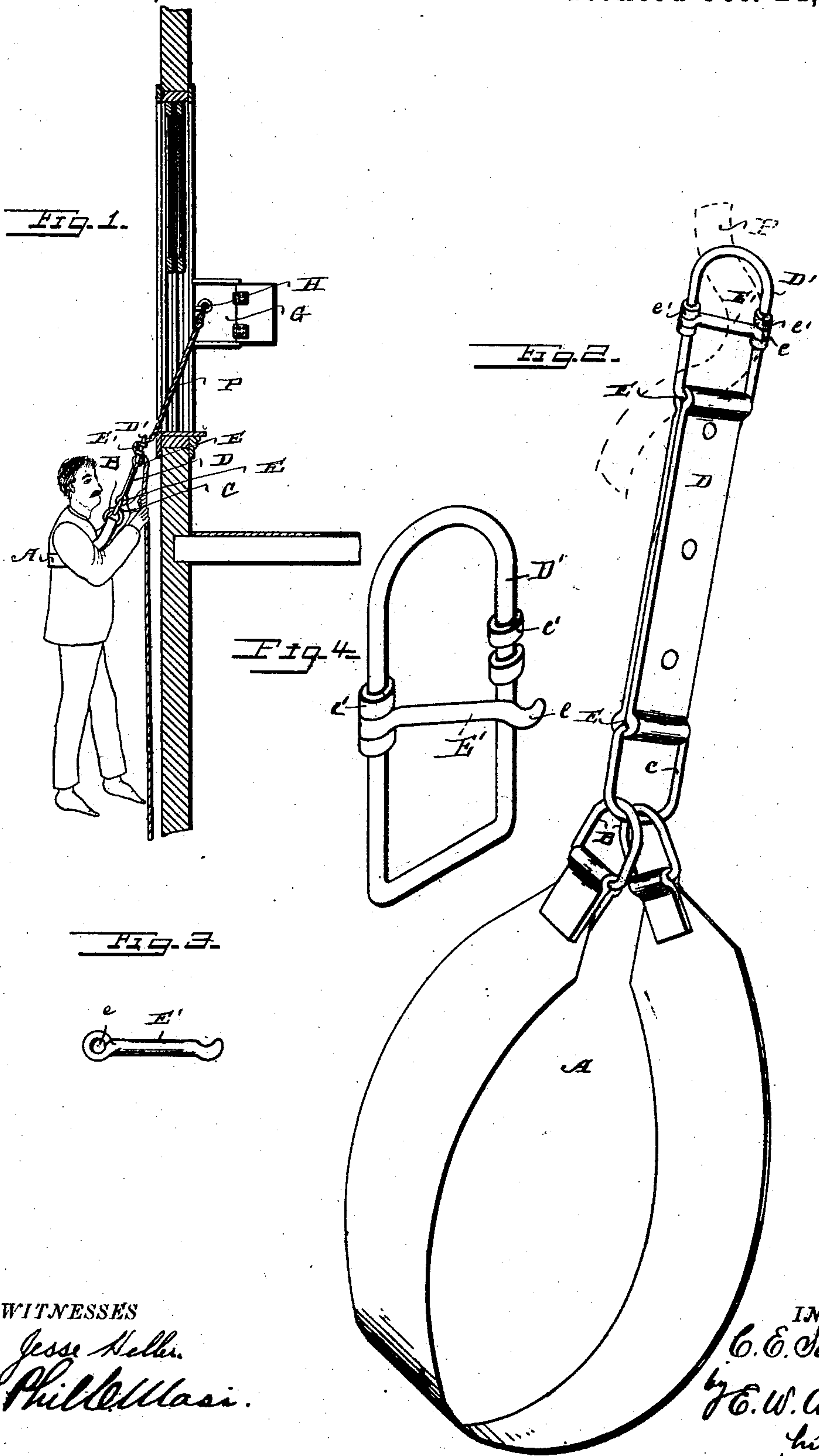

WITNESSES  
Jesse Heller.  
Phil Massi.

INVENTOR  
C. E. Sansoucy,  
by E. W. Anderson,  
his Attorney

# UNITED STATES PATENT OFFICE.

CHARLES E. SAN SOUCY, OF DULUTH, MINNESOTA.

## FIRE-ESCAPE.

SPECIFICATION forming part of Letters Patent No. 507,455, dated October 24, 1893.

Application filed March 31, 1893. Serial No. 468,484. (No model.)

*To all whom it may concern:*

Be it known that I, CHARLES E. SAN SOUCY, a citizen of the United States, residing at Duluth, in the county of St. Louis and State of Minnesota, have invented certain new and useful Improvements in Fire-Escapes; and I do declare the following to be a full, clear, and exact description of the invention, such as will enable others skilled in the art to which it appertains to make and use the same, reference being had to the accompanying drawings, and to letters of reference marked thereon, which form a part of this specification.

Figure 1 of the drawings is a vertical section of a house front and window showing the application thereto of the invention and Fig. 2 is a perspective view of the belt and attachments. Fig. 3 is a detail view of the tongue. Fig. 4 is an enlarged detail view of the ring D'.

This invention has relation to certain new and useful improvements in fire escapes, the object being to provide a simple and effective device at a small cost, by means of which escape may be quickly and safely made from a burning building; and the invention consists in the novel construction and combination of parts, all as hereinafter specified and pointed out in the claims.

Referring to the accompanying drawings, the letter A designates a belt of canvas, leather, or other suitable material, and designed to encircle the body of a person around the waist. To each end of this belt is firmly attached a ring B, and these rings are permanently attached to a ring C at one end of a strap or stirrup D, which is shown as consisting of a stout piece of leather doubled upon itself, and firmly secured by rivets, leaving an eye or loop E at each end. To one of these eyes or loops is connected the ring C, above referred to, and to the other is attached another ring D', of oblong shape, square at the end where the stirrup or strap is attached. Said ring D' is provided with a transverse bar or tongue E', having an eye e at one end portion, which eye loosely encircles and bears on one side portion of the ring. The other

end of said bar or tongue is arranged to seat between flanges e', similar flanges being formed at each side of the bearing for the eye e to prevent the tongue from moving on the ring.

P designates the rope, which is designed to be sufficiently long to reach from the room in which the device is to be used to the ground. Said rope may be kept at any convenient place in the room, but is preferably coiled in a box G, secured to the wall near a window, one end of the rope being attached to a stout hook H, driven into the wall inside of said box.

The manner of using the device is as follows: The rope is thrown out of the window, the upper end remaining attached to the hook. The belt is placed around the waist, a short loop is made in the rope, the loop placed through the ring D, and the tongue turned down through the loop, as shown in Figs. 1 and 2, so that the loop cannot be withdrawn. The person then takes hold of the rope below the ring and steps out of the window, and by manipulating the rope properly it will be apparent that its friction on the tongue E' and ring may be increased or diminished at pleasure, so as to regulate his rate of descent. He may also be assisted by persons on the ground holding the rope. The device may then be drawn up by a second occupant of the room for his descent.

If desired, the whole device may be made portable, and may be readily carried in a valise or traveling bag.

Having described this invention, what I claim, and desire to secure by Letters Patent, is—

1. In a fire escape, the combination with an oblong ring D', having a pivoted transverse bar or tongue E', about midway between its end bars, and a belt A, of a strap or stirrup D connecting said ring and belt, said strap or stirrup having a bearing at one end portion for one end bar of the ring, and at the other end a second bearing for a ring C, to which the ends of said belt are attached, substantially as specified.



to be secured at one end within a room or building, a belt having a ring at each end, an oblong ring D', having a transverse pivoted bar or tongue E', a strap or stirrup connected  
5 at one end to said ring D', and at the other end to a ring C with which the rings on the belt are engaged, the said rope passing  
2. A fire escape, comprising a rope adapted

through the ring D' and over its transverse bar E', substantially as specified. 10

In testimony whereof I affix my signature in presence of two witnesses.

CHARLES E. SANSOUCY.

Witnesses:

G. H. LESAGE,  
FRANK A. DAY.