

(No Model.)

W. T. WOOD.
CUFF HOLDER.

No. 437,074.

Patented Sept. 23, 1890.

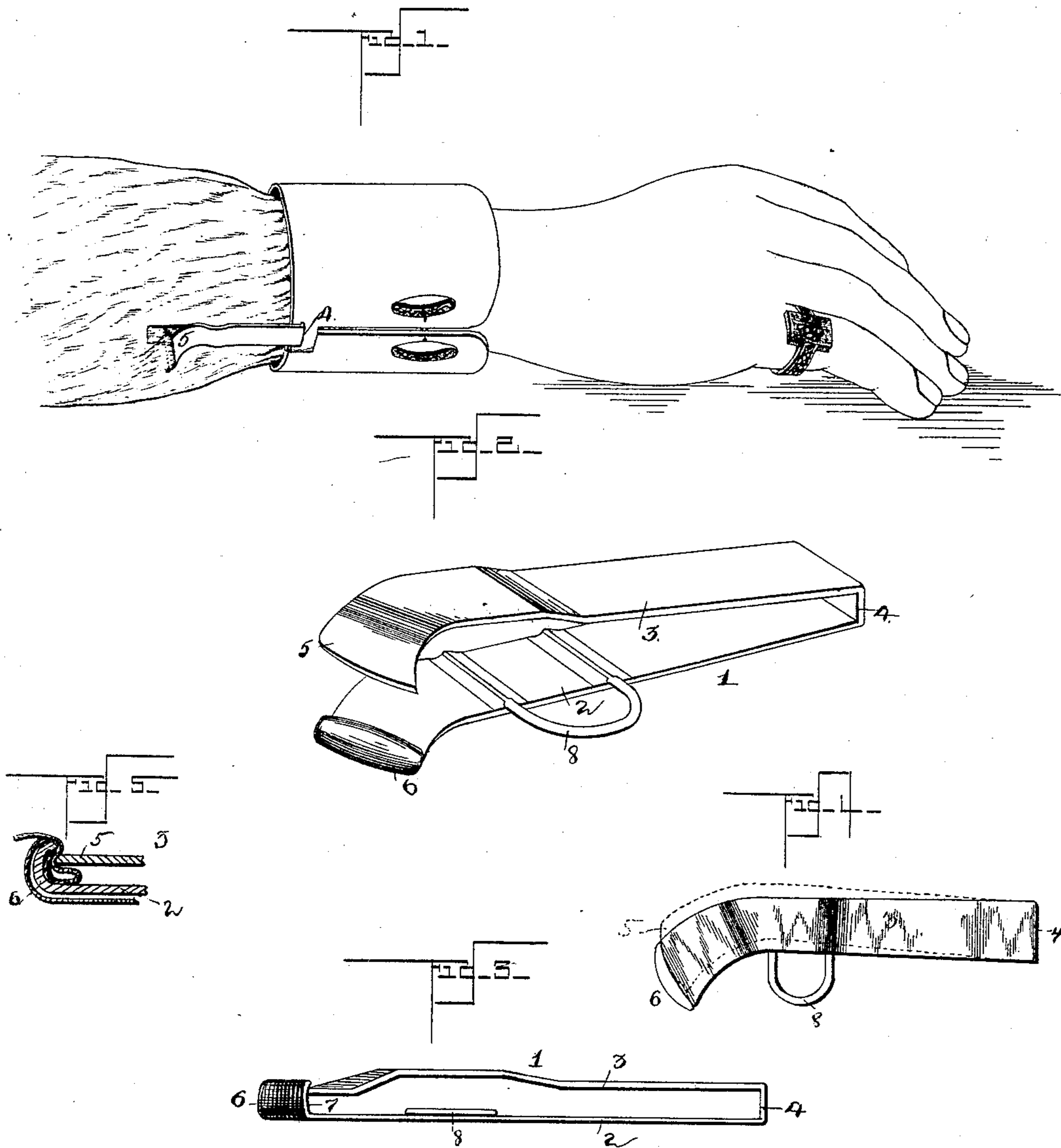

Witnesses

Horace G. Sutz

J. J. Wiley

Inventor
William T. Wood

By his Attorneys

C. A. Snow & Co.

UNITED STATES PATENT OFFICE.

WILLIAM T. WOOD, OF NASHVILLE, TENNESSEE, ASSIGNOR OF ONE-HALF
TO ROBERT M. GIDDENS, OF SAME PLACE.

CUFF-HOLDER.

SPECIFICATION forming part of Letters Patent No. 437,074, dated September 23, 1890.

Application filed March 13, 1890. Serial No. 343,746. (No model.)

To all whom it may concern:

Be it known that I, WILLIAM T. WOOD, a citizen of the United States, residing at Nashville, in the county of Davidson and State of Tennessee, have invented a new and useful Cuff-Holder, of which the following is a specification.

The invention relates to improvements in cuff-holders.

10 The object of the present invention is to provide a simple and inexpensive device adapted to be readily attached to a cuff and capable of engaging the fabric of a sleeve and of securely holding the cuff thereto without liability of injuring the fabric of the cuff or the sleeve.

A further object of the invention is to provide a device which will hold the sides of the cuff evenly and will not present any points or projections to engage the lining of a coat.

20 The invention consists in the construction and novel combination and arrangements of parts hereinafter fully described, illustrated in the accompanying drawings, and pointed out in the claims hereto appended.

In the drawings, Figure 1 is a perspective view of a cuff-holder constructed in accordance with this invention and shown in operative position. Fig. 2 is a perspective view of the cuff-holder detached, the jaws being opened. Fig. 3 is an elevation. Fig. 4 is a plan view illustrating the position of one of the jaws when sprung laterally. Fig. 5 is a detail sectional view.

35 Referring to the accompanying drawings, 1 designates a cuff-holder, which is constructed of a single piece of spring sheet metal that is doubled to form jaws 2 and 3, the ends of which are adapted to engage the fabric of a shirt-sleeve after one of the jaws has been passed through the button-holes of a cuff, and the button-holes are arranged at the bend 4, and are held opposite each other, thereby preventing one side of the cuff hanging below the other. The ends 5 and 6 of the jaws are curved or bent to one side, and the end 6 of the jaw 2 is bent inward toward the opposite jaw and rolled or crimped to provide a curved

recess 7 to receive the rounded edge or end 5 of the jaw 3, and the latter is adapted to be sprung laterally and is thereby brought into and out of engagement with the curved recess 7 of the jaw 2. The fold of the fabric of a sleeve is placed in the recess 7 and is engaged by the rounded edge or end of the jaw 3, which securely holds the fabric in the recess without liability of injuring the goods, as there are no points or teeth, but only smooth and curved surfaces in contact with the fabric, which is also doubled to afford an additional protection, and it will readily be seen that by this construction the device is adapted to be readily attached to any portion of a sleeve to hold the cuff at any desired position. The jaw 2 is provided a short distance from the recess 7 with a loop or projection 8, that is arranged in the same plane as the jaw, and is adapted to form a rest for the thumb when separating and locking the jaws, and it prevents the holder twisting in the hand. The loop or projection 8 may be formed integral with the jaw; but it is preferably, as illustrated in the accompanying drawings, of a separate piece secured to the inner face of the jaw.

From the foregoing it will readily be seen that the cuff-holder is simple and inexpensive, adapted to be readily attached to a cuff and a sleeve without liability of injuring the fabric, and presents no points to engage and injure a sleeve-lining.

What I claim is—

1. A cuff-holder constructed of a single piece of metal doubled and provided with jaws 2 and 3, having their ends 5 and 6 arranged at an angle to the body of the holder, the end of the jaw 2 being bent inward toward the jaw 3 and crimped and forming a curved recess 7, and the jaw 3 being provided with a curved or rounded end, and being adapted to be sprung laterally to engage the curved recess 7, substantially as described.

2. A cuff-holder constructed of a single piece of metal doubled and provided with jaws 2 and 3, having their ends arranged at an angle, the jaw 2 having the projection or loop

8 and having its end bent inward toward the
jaw 3 and provided with the curved recess 7,
and the jaw 3 having its end rounded or curved
at the edge and adapted to be sprung aside
5 to engage the curved recess, substantially as
described.

In testimony that I claim the foregoing as

my own I have hereto affixed my signature in
presence of two witnesses.

WILLIAM T. WOOD.

Witnesses:

D. A. LINDSEY,

W. S. FARRINGTON.