

(No Model.)

A. EFFINGER, L. L. DEWEESE, C. W. KOONS &
W. H. METZGER.
SAW SETTING DEVICE.

No. 399,391.

Patented Mar. 12, 1889.

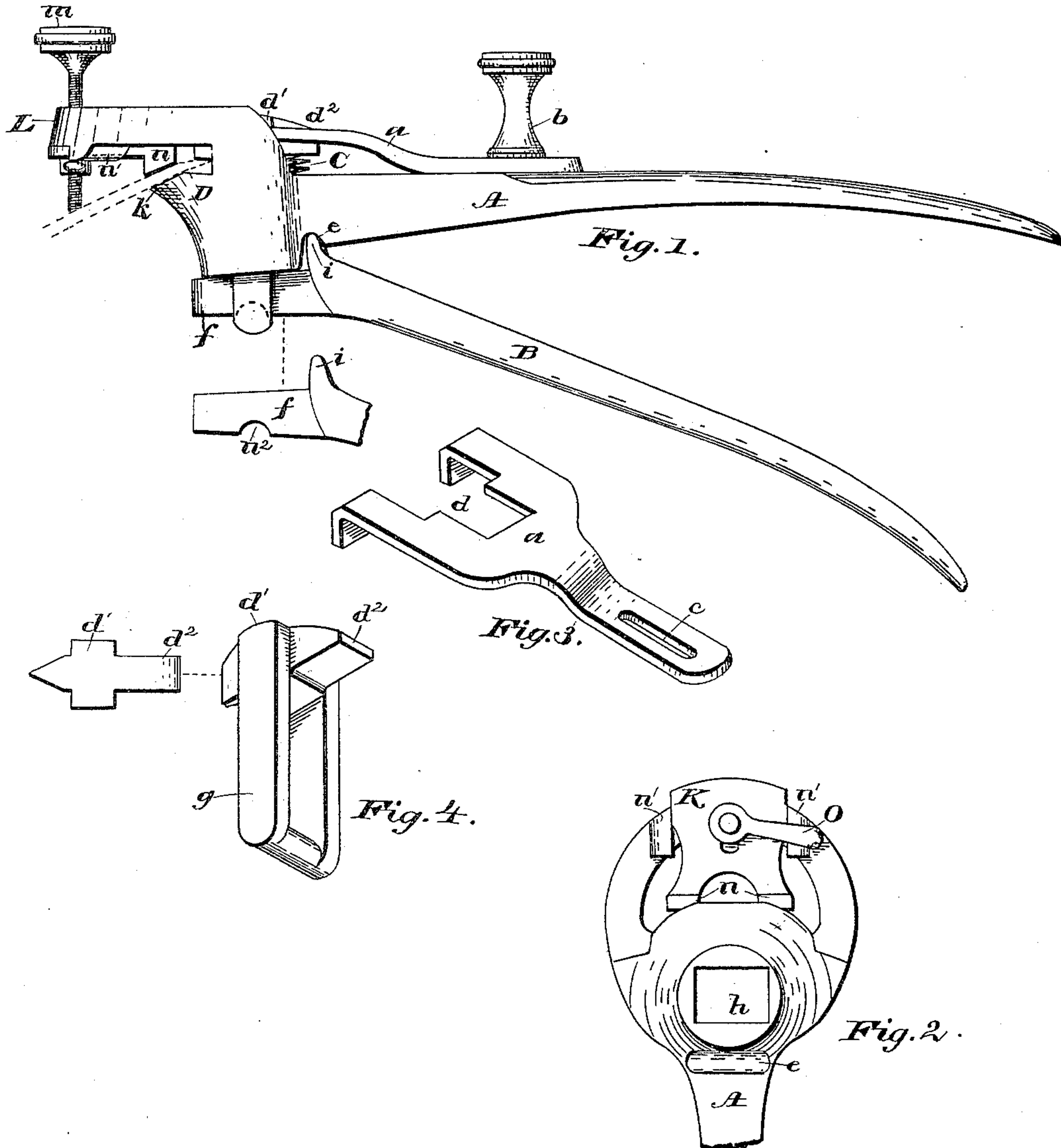

Witnesses:
E. H. Lape,
A. J. Furburn,

August Effinger
L. L. Dewees, Inventors.
By Charles W. Koons &
William H. Metzger
Bond & Wise Attorneys.

UNITED STATES PATENT OFFICE.

AUGUST EFFINGER, LEVI L. DEWEESE, CHARLES W. KOONS, AND WILLIAM H. METZGER, OF CANTON, OHIO; SAID KOONS AND METZGER ASSIGNORS TO SAID EFFINGER AND DEWEESE.

SAW-SETTING DEVICE.

SPECIFICATION forming part of Letters Patent No. 399,391, dated March 12, 1889.

Application filed July 18, 1888. Serial No. 280,299. (No model.)

To all whom it may concern:

Be it known that we, AUGUST EFFINGER, LEVI L. DEWEESE, CHARLES W. KOONS, and WILLIAM H. METZGER, citizens of the United States, residing at Canton, in the county of Stark and State of Ohio, have invented certain new and useful Improvements in Saw-Sets; and we do hereby declare that the following is a full, clear, and exact description of the same, reference being had to the annexed drawings, making a part of this specification, and to the letters and figures of reference marked thereon, in which—

Figure 1 is a side elevation of the saw-set. Fig. 2 is an under side view of the head. Fig. 3 is a detached view of the gage. Fig. 4 is a detached view of the die and its link.

The present invention has relation to saw-sets; and it consists in the different parts and combination of parts hereinafter described, and particularly pointed out in the claims.

Similar letters of reference indicate corresponding parts in all the figures of the drawings.

In the accompanying drawings, A B represent the handles, which may be substantially of the form shown. To the top or upper side of the handle A is attached the gage *a* by means of the set-screw *b*. The gage *a* is provided with the elongated slot *c*, which is for the purpose of adjusting the gage back and forth on the handle A. The front or forward end of the gage *a* is provided with the recess *d*, which is for the purpose of receiving the die *d'*. The die *d'* is provided with the extension *d²*, which is for the purpose of holding one end of the helical spring C, the opposite end of said spring being held by the handle A, a cup or recess being provided to hold the spring in proper position. The handle A is provided with the groove *e*, which is for the purpose of holding the extension or rib *i*, as illustrated in Fig. 1. The link *g* is preferably formed integral with the die *d'*, and is of sufficient length to extend through the aperture *h* and embrace the extension *f*, as illustrated in Fig. 1. The front or forward

portion of the anvil D is provided with the beveled portion *k*, which is for the purpose of receiving the blade of a saw.

For the purpose of holding a gig-saw in proper position the sliding gage or guide K is provided, which is attached to the front or forward end of the head L by means of the gage-screw *m*. This sliding gage or guide K is provided with the beveled heads *n*, which are so adjusted that they will set the blade of a gig-saw to the beveled portion *k*. In setting saws having wide blades the gage-screw *m* takes the place of the sliding gage or guide K, and, if desired, said sliding gage may be removed. In use the saw is placed in the position shown in Fig. 1 and the tooth of the saw designed to be set placed directly under the die *d'*, when the handles A B are pressed toward each other, thereby forcing the die *d'* against the tooth and setting said tooth. The helical spring C is for the purpose of elevating the die *d'* when the handles are released.

For the purpose of securely holding the gage-screw *m* at any desired point of adjustment the lock-lever O is provided, which has a screw-threaded aperture to receive the screw. In case the sliding gage K is removed the lock-lever O is placed on the top or upper side of the head L.

For the purpose of assisting in holding the sliding gage K the ribs *n'* are provided. The extension *f* is provided with the groove *n²*, which is for the purpose of receiving the lower end of the link *g*.

Having fully described our invention, what we claim as new, and desire to secure by Letters Patent, is—

1. The combination of the handles A and B, the former having the groove *e*, adapted to receive the rib *i* upon the latter, the die *d'*, provided with the extension *d²* and the link *g*, the anvil provided with the beveled portion *k*, the gage *a*, and the spring C, substantially as and for the purpose set forth.

2. The combination of the handles A and B, the anvil D, formed integral with the handle A and provided with the aperture *h*, the

die d' , the link g , and the sliding gage K, provided with the beveled heads n , substantially as and for the purpose specified.

3. The combination of the handles A and
5 B, the anvil D, provided with the beveled portion k , the die d' , the link g , the gage-screw m , and the lock-lever O, substantially as and for the purpose specified.

In testimony that we claim the above we

have hereunto subscribed our names in the presence of two witnesses.

AUGUST EFFINGER.

LEVI L. DEWEESE.

CHARLES W. KOONS.

WILLIAM H. METZGER.

Witnesses:

FRED W. BOND,

L. C. WISE.