

(No Model.)

H. T. DAVIS.

QUILTING ATTACHMENT FOR SEWING MACHINES.

No. 377,242.

Patented Jan. 31, 1888.

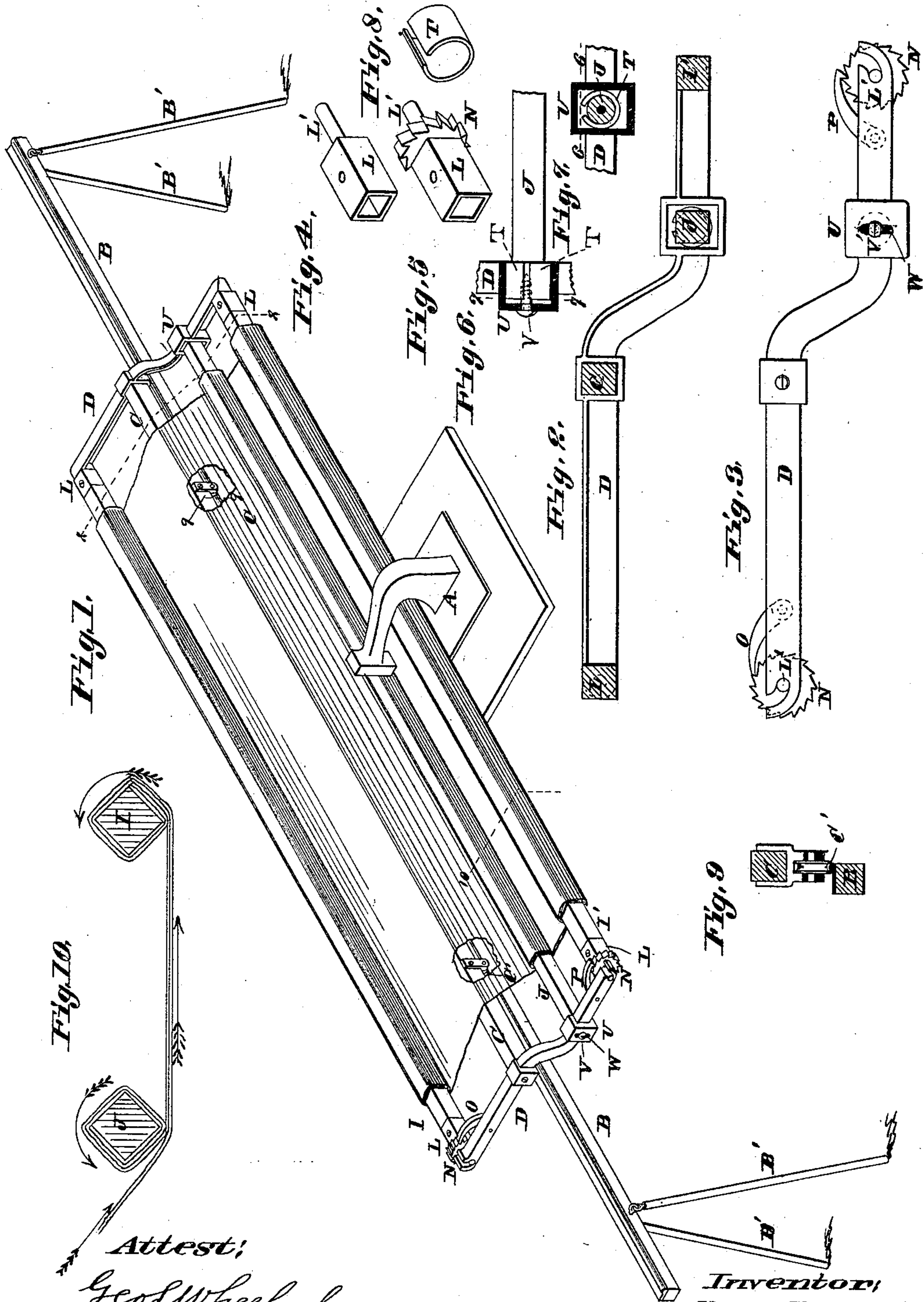

Attest:  
Geo. Wheelock  
Edward Stew.

Inventor,  
Henry T. Davis  
By Knight Bros  
attys



# UNITED STATES PATENT OFFICE.

HENRY T. DAVIS, OF NEW YORK, N. Y.

## QUILTING ATTACHMENT FOR SEWING-MACHINES.

SPECIFICATION forming part of Letters Patent No. 377,242, dated January 31, 1888.

Application filed April 18, 1885. Serial No. 162,694. (No model.)

*To all whom it may concern:*

Be it known that I, HENRY T. DAVIS, of the city, county, and State of New York, have invented a certain new and useful Improvement in Sewing-Machine Quilting Attachments, of which the following is a full, clear, and exact description, reference being had to the accompanying drawings, forming part of this specification, and in which—

Figure 1 is a perspective view of my improved attachment. Fig. 2 is an enlarged transverse section taken on line 2 2, Fig. 1, the quilt being removed. Fig. 3 is an enlarged end view. Figs. 4 and 5 are enlarged perspective views of the roller-clips. Fig. 6 is a section taken on line 6 6, Fig. 7. Fig. 7 is a section taken on line 7 7, Fig. 6. Fig. 8 is a perspective view of the spring-bushing. Fig. 9 is a section taken on line 9 9, Fig. 1; and Fig. 10 is an enlarged section taken on line 10 10, Fig. 1.

My present invention relates to a certain improvement on the attachment shown and described in patents already issued to me, notably in my United States Letters Patent No. 263,487, issued August 28, 1882; and this invention consists in features of novelty hereinafter fully described, and pointed out in the claims.

Referring to the drawings, A represents part of the top and head of a sewing-machine.

B represents the track of the attachment, supported at its ends by legs B', hinged to it, as shown in Fig. 1. Upon this track bear rollers C', secured to the under side of a bar, C, to which the end pieces, D, of the attachment are made fast.

I, I', and J represent rollers journaled in the end pieces, D, the roller I being the one the lining of the quilt is rolled upon, the roller J being the one the top of the quilt is rolled upon, and the roller I' being the one the quilt is rolled upon as it is completed. The roller J also acts as a tension-roller, as in the patent referred to, as well as a support for the top of the quilt.

I refer to my United States Letters Patent No. 334,646, dated January 19, 1886, for the advantages of having the lining and top of the quilt wound on separate rollers.

L represents the clips on the ends of the

rollers I I', that are cast in one piece with the gudgeons L', that are journaled in the end pieces, D, and the ratchet-wheels N are also cast in one piece with the clips to which they belong. By casting these parts together it reduces the cost of the frame, and at the same time adds to its stability. The ratchet on the roller I is engaged by a push-pawl, O, to control the roller and the ratchet on the roller I' by a pull-pawl, P, for the same purpose.

The ends of the roller J are journaled in spring metallic cylindrical bushings T, (see Figs. 6, 7, and 8,) that act to prevent the roller from turning too freely, and they fit in elongated sockets U in the end pieces, D, and the roller is adjustable up and down to compensate for amount of cloth rolled on the roller by set-screws V, that enter the ends of the rollers (see Fig. 6) and fit in slots W in the backs of the sockets, (see Figs. 1 and 3,) and by tightening these screws, to cause the screws to bear on the sockets, the roller may be made to turn less freely should it turn too freely in the bushings.

The operation is as follows: The top of the quilt is all rolled upon the tension-roller and the bottom or lining on the roller I, except enough of each to reach to the machine-needle. As the quilt is finished and rolled upon the roller I', the top and lining are unrolled and the cotton put on as in the attachment shown and described in said United States Letters Patent No. 334,646.

I claim as my invention—

1. In a quilting attachment for sewing-machines, the combination of a suitable support, a longitudinal track-bar, end pieces, a lining-roller, a winding-roller, a combined cover and tension roller, and means for imparting tension to the latter roller, substantially as described and shown.

2. A quilting attachment for sewing-machines, consisting of a longitudinal track-bar, end pieces, lining-roller, winding-roller, and combined cover and tension roller, and spring-metal bushings T, surrounding the journals of the cover-roller, substantially as described and shown.

3. A quilting attachment for sewing-machines, consisting of a longitudinal track-bar, end pieces, lining-roller, winding-roller, com-

bined cover and tension roller, the elongated sockets V, having slots W, and the set-screws for adjusting the cover-roller, substantially as described and shown.

- 5 4. A quilting attachment for sewing-machines, consisting of a longitudinal track-bar, end pieces, a lining-roller, and a winding-roller, said rollers having on each end a clip,

L, formed with a gudgeon, L', and one of the clips on each roller having a ratchet-wheel, N, 10 in combination with suitable pawls on the end pieces, substantially as described.

HENRY T. DAVIS.

In presence of—

W. E. SPOTSWOOD,  
S. S. WRIGHT.