

(No Model.)

J. THORNTON.
HALTER.

No. 277,380.

Patented May 8, 1883.

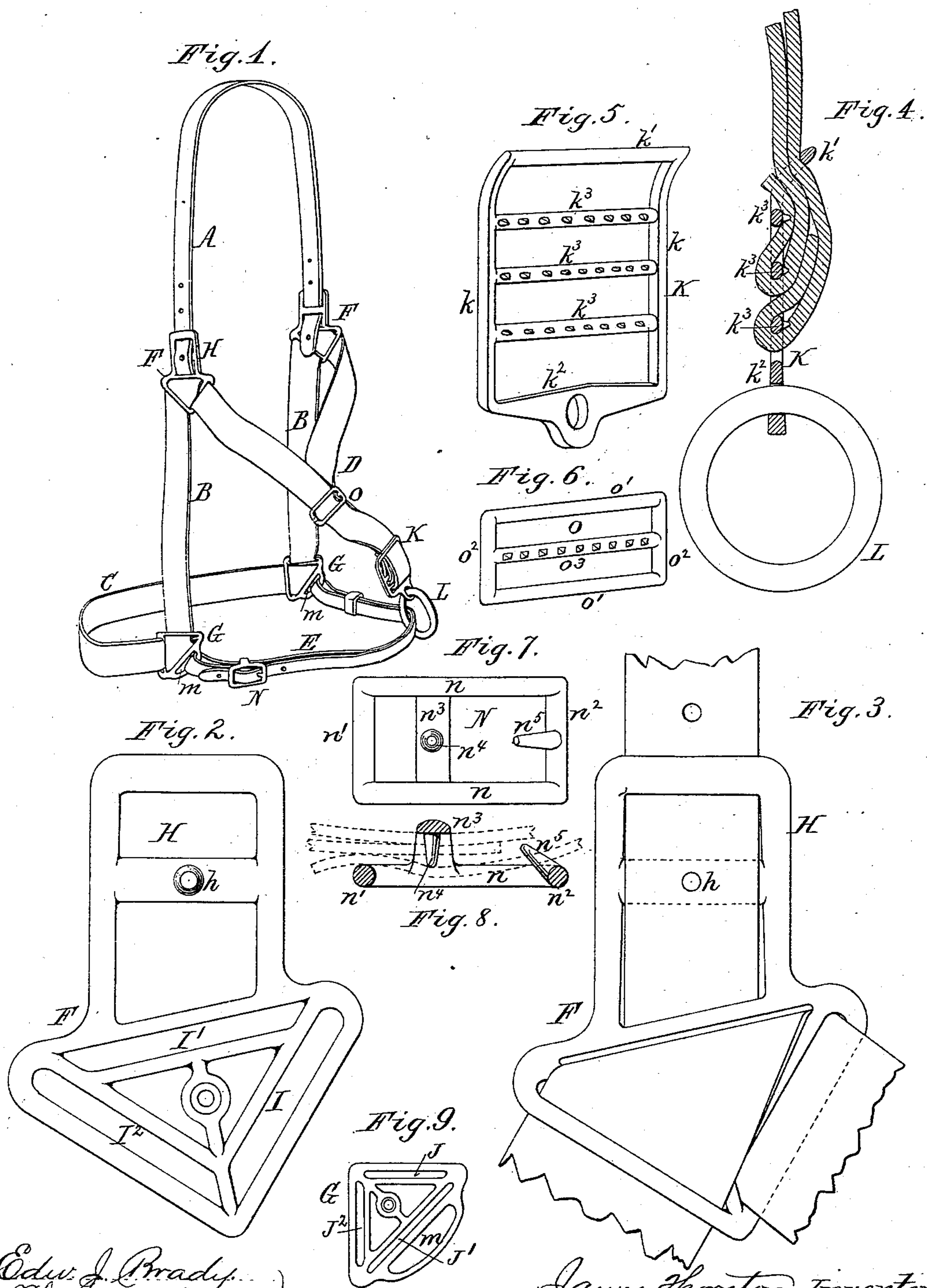

Edw. J. Brady
Theo. L. Popp

Witnesses.

James Thornton Inventor.
By Wilhelm Bonner
Attorneys.

UNITED STATES PATENT OFFICE.

JAMES THORNTON, OF WELLSVILLE, NEW YORK, ASSIGNOR OF ONE-FOURTH
TO HORACE G. DOBBINS, OF SAME PLACE.

HALTER.

SPECIFICATION forming part of Letters Patent No. 277,380, dated May 8, 1883.

Application filed December 19, 1882. (No model.)

To all whom it may concern:

Be it known that I, JAMES THORNTON, of
Wellsville, in the county of Allegany and State
of New York, have invented new and useful
5 Improvements in Halters, of which the follow-
ing is a specification.

This invention relates to that class of hal-
ters in which several of the straps composing
the halter are constructed of a single piece of
10 webbing or other similar pliable material, and
has reference more particularly to the con-
struction of a five-ring halter in which the
cheek-strap, nose-strap, and the throat-latch
are composed of a single piece of webbing.

15 Heretofore five-ring halters have been con-
structed of eight different pieces or straps
stitched or riveted at each end, which neces-
sitated the stitching or riveting of thirteen
laps.

20 The object of my invention is to simplify the
construction of such halters, to reduce the
amount of material necessary for their con-
struction, to increase the adjustability of the
halter, and to render the halter more conven-
25 ient in use; and my invention consists, to that
end, of the particular construction of the hal-
ter and of the peculiar construction of the parts
whereby the straps of the halter are secured
together, as will be hereinafter fully described,
30 and pointed out in the claims.

In the accompanying drawings, Figure 1 is
a perspective view of my improved halter.
Fig. 2 is a detached view of the trimming
which connects the top strap to the cheek-strap
35 and throat-latch. Fig. 3 is a similar view,
showing the straps applied to the trimming.
Fig. 4 is a sectional elevation of the buckle
which is attached to the chin-ring. Fig. 5 is
a perspective view of said buckle. Fig. 6 is a
40 perspective view of the buckle which connects
the two parts of the strap which constitutes
the throat-latch. Fig. 7 is a side elevation,
and Fig. 8 is a longitudinal section, of the
buckle whereby the chin-strap is secured in
45 place. Fig. 9 is an elevation of the trimming
which connects the top strap with the cheek-
straps and the throat-latch on a reduced scale.

Like letters of reference refer to like parts
in the several figures.

50 A represents the top strap; B B, the cheek-

straps; C, the nose-strap; D, the throat-latch,
and E the chin-strap.

F F represent the trimmings whereby the
top strap is connected with the cheek-straps
and throat-latch, and G G the trimmings where-
55 by the chin-strap is connected with the cheek-
straps and nose-strap. The trimmings F are
each provided with a buckle, H, whereby the
end of the top strap is adjustably secured to
the trimming. As shown in the drawings, this
60 buckle is provided with a fixed tongue, *h*; but
any other suitable construction may be adopt-
ed, if desired. Each trimming F is also pro-
vided with three slots, I I' I², arranged in the
form of a triangle, and having bars on their
65 outer and inner sides, the bars and slots form-
ing in each trimming three loops, through
which the webbing is drawn, and which retain
the parts of the webbing in their proper rela-
tive position. The slot I' is arranged in a hori-
70 zontal position, or nearly so, at the base of
the buckle H, and the slots I I² converge
downwardly, as clearly shown in Fig. 2.

The trimmings G are each provided with
three slots, J J' J², arranged in the form of a
75 triangle, the slot J being arranged in a hori-
zontal position, or nearly so, the slot J² in a
vertical position, and the slot J' in a diagonal
position, as clearly shown in Fig. 9, the slots
being made of the same size as those of the
80 trimmings F. The cheek-straps, the nose-strap,
and the throat-latch are all formed by a single
piece of webbing or similar pliable material,
which is drawn through the slots of the trim-
mings F and G in such manner that both ends
85 of the webbing are brought together and are
attached to a buckle, K, which is connected
or secured to the chin-ring L. As shown in
the drawings, the strip of webbing passes from
the buckle K upwardly to one of the trim-
90 mings F, in which it passes successively
through the slots I I' I², thence downwardly
to the trimming G, in which it passes succes-
sively through the slots J J' J², thence around
the nose of the horse, back to the other trim-
95 ming G, in which it passes successively
through the slots J² J' J, thence upwardly
to the other trimming F, in which it passes
successively through the slots I² I' I, and
thence back to the buckle K, to which both
100

ends of the webbing are firmly secured. The buckle K is composed of side bars, k , an upper raised cross-bar, k' , a lower cross-bar, k^2 , which is provided with an opening for the reception of the chin-ring L, or with which the chin-ring may be formed in one piece, and three intermediate cross-bars, k^3 , which are provided with spurs or suitable biting-edges, which impinge against the webbing drawn around these bars and firmly hold the same in any desired position.

The trimmings G are provided on their rear sides with loops or openings m , through which the chin strap is drawn. These loops or openings are arranged on the lower side of the bar which forms the outer side of the diagonal slot J'. The chin-strap E is drawn through the loops m of both trimmings G, and its ends are adjustably connected by a buckle, N. The buckle N is composed of side bars, n , end cross-bars, n' n^2 , and an intermediate depressed cross-bar, n^3 , which is provided with an outwardly-projecting tongue, n^4 . The rear cross-bar, n^2 , is provided with an inwardly and forwardly projecting fixed tongue, n^5 . One end of the chin-strap is attached to the fixed tongue n^4 , and the other end of the chin-strap is attached to the fixed tongue n^5 , as shown in Fig. 8.

o represents a buckle, whereby the two branches of the throat-latch are adjustably secured together intermediate between the buckle K and the trimming F, so that the two parts of the throat-latch lying between the buckles K and o will lie one upon the other and constitute a single strap of double thickness. The buckle o is composed of two side bars, o' , connected by end cross-bars, o^2 , and an intermediate depressed bed or cross-bar, o^3 , which is provided with teeth or any other suitable biting-edge, which impinges against the webbing drawn through the buckle and prevents the buckle from slipping on the webbing when tightened. By adjusting the buckle o upon the throat-latch the branches of the throat-latch leading to the trimmings F can be shortened or lengthened, as may be desired, and by drawing the webbing through the several trimmings the length of the cheek-straps and nose-strap can be increased or lessened, and the size of the halter generally can be increased or reduced by adjusting the webbing on the buckle K.

The material and labor required for the construction of my improved halter are much less than those required for ordinary five-ring halters. The halter is readily adjusted in all of its parts, as all stitching and riveting is avoided, and the halter is much neater in appearance and more pliable than ordinary halters, and does not chafe the head of the horse.

The slots in the trimmings F and G may be duplicated, if desired, in order to draw the webbing around two bars instead of one, and the trimmings may be provided on their outer sides, near the slots, with serrations or biting-edges, which impinge against the webbing and prevent the trimmings from slipping on the webbing after they have been adjusted. The trimmings F and G may also be applied to three-ring halters, if desired.

I claim as my invention—

1. The combination, in a halter, of a top strap, A, a chin-strap, E, side trimmings, F and G, and a nose-strap, C, cheek-straps B B, and a throat-latch, D, composed of a single continuous strip, and means whereby the latter is connected with the chin-ring, substantially as set forth.

2. The combination, in a halter, of a top strap, A, a chin-strap, E, trimmings F and G, a chin-ring, L, provided with a buckle, K, a nose-strap, C, cheek-straps B B, and a throat-latch, D, formed of a continuous strip of webbing, and a buckle, o , whereby the branches of the throat-latch are adjusted, substantially as set forth.

3. The trimming F, provided with three slots, I I' I², adapted to receive and hold the strip forming the throat-latch and cheek-strap, and a buckle, H, formed integral with the trimming, and adapted to receive the end of the top strap, substantially as set forth.

4. The combination, with the chin-ring L, of the buckle K, composed of side bars, k , and cross-bars k' k^2 , and three intermediate cross-bars, k^3 , the whole being adapted to receive and hold the two ends of the webbing and connect the same with the chin-strap, substantially as set forth.

JAMES THORNTON.

Witnesses:

W. E. MINNELLY,
W. T. THORNTON.