

(No Model.)

F. H. ROSSMAN.

MARKING GAGE.

No. 266,646.

Patented Oct. 31, 1882.

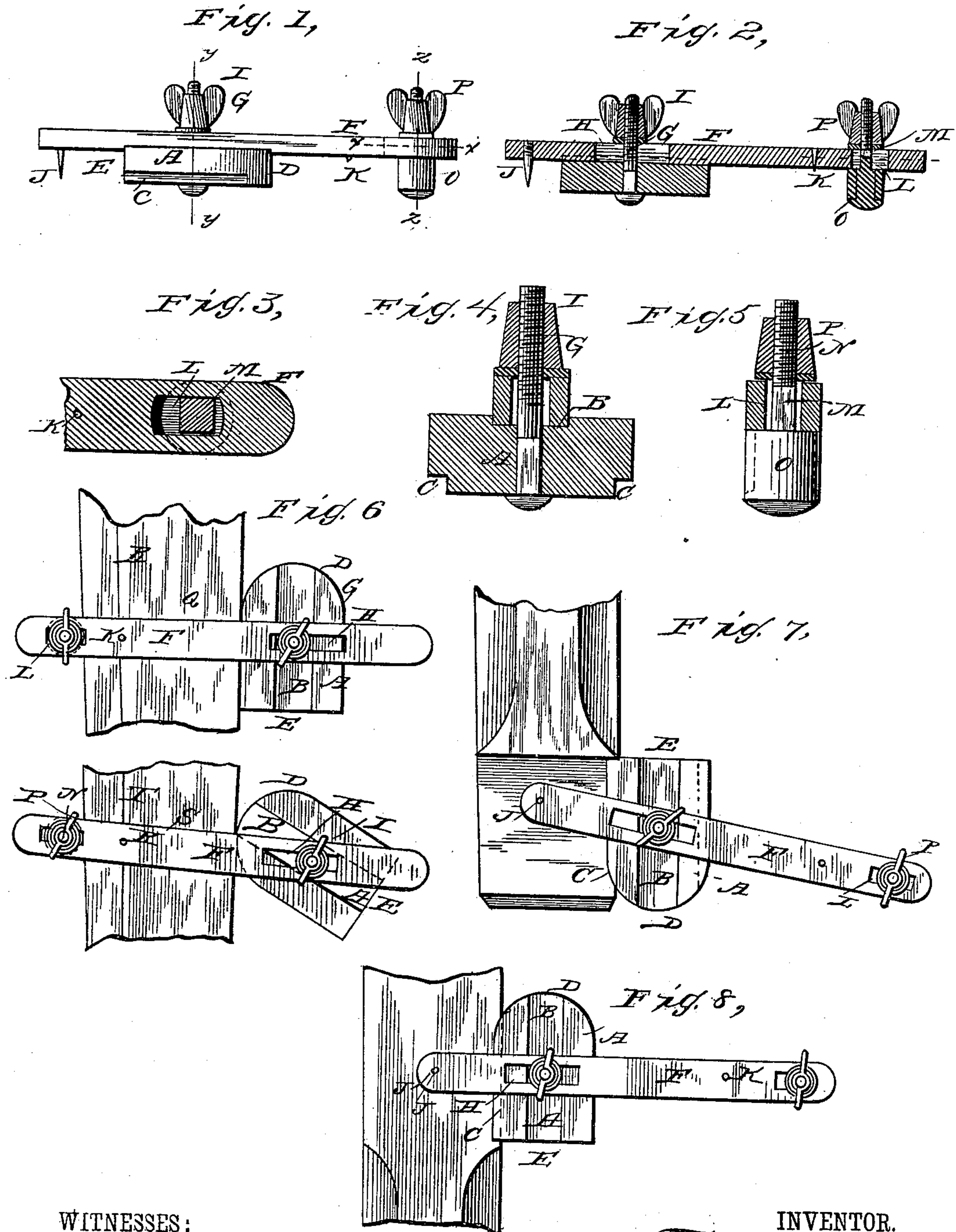

WITNESSES:

Wm. H. Dieterich
Charles H. Baker

INVENTOR.

Freeman H. Rossman
by *C. A. Snow & Co.*
ATTORNEYS.

UNITED STATES PATENT OFFICE.

FREEMAN H. ROSSMAN, OF WAPPINGER'S FALLS, NEW YORK.

MARKING-GAGE.

SPECIFICATION forming part of Letters Patent No. 266,646, dated October 31, 1882.

Application filed June 13, 1882. (No model.)

To all whom it may concern:

Be it known that I, FREEMAN H. ROSSMAN, of Wappinger's Falls, in the county of Dutchess and State of New York, have invented certain new and useful Improvements in Gages and Markers; and I do hereby declare that the following is a full, clear, and exact description of the invention, which will enable others skilled in the art to which it appertains to make and use the same, reference being had to the accompanying drawings, which form a part of this specification.

This invention relates to taper gages and draw-bore markers, and has for its object to provide a simple, inexpensive, and efficient device.

To this end it consists in certain improvements in the construction and operation of the same.

In the drawings, Figure 1 is a side view of the device; Fig. 2, a longitudinal vertical sectional view thereof; Fig. 3, a horizontal sectional view on the line *x x*, Fig. 1; Fig. 4, a transverse vertical sectional view on the line *y y*, Fig. 1; Fig. 5, a like view on the line *z z*, Fig. 1; and Figs. 6, 7, and 8, views illustrating the use of the device.

Referring by letter to the drawings, A designates a heel-plate, having a longitudinal groove or recess, B, in its top face and longitudinal shoulders C C at its lower edges, one end, D, being curved, and the other, E, straight, as shown.

F is an arm adapted to be received into groove B, and longitudinally adjustable therein by means of a screw-bolt, G, passing up through the heel-plate, and a longitudinal slot, H, in the arm, a thumb-nut, I, being provided on its end. The heel of arm F is provided with a long marking-pin, J, and near its toe with a smaller pin, K. At the latter end is also provided a longitudinal slot, L, through which passes the square shank M of a screw-bolt, N, having a cylindrical collar, O, at its headed end and a thumb-nut, P, at the opposite end. The part O forms the toe-plate, and may be longitudinally adjusted by means of the bolt and nut.

The operation and advantages of my inven-

tion will be readily understood. When drawn down a square taper stick with the arm at right angles to the stick, as at Q, Fig. 6, the pin K will make a line, R, parallel to the sides; but when the arm is placed diagonally, as at S, Fig. 6, the line will not be parallel to the sides, but perfectly straight, as at T. Then by reversing the position of the arm a line parallel to the straight line T can be formed. In these movements the curved edge of the heel-plate engages the edge of the stick and the lines are drawn toward the smaller end thereof.

For marking draw-bore holes in mortises, the device is placed in the position shown in Fig. 7, with one shoulder, C, engaging the edge of the stick at the mortise, and the mark is made by the pin J.

In marking draw-bore holes in tenons the shoulder C engages the edge of the tenon, with the square end of the heel-plate abutting against the shoulder of the tenon. The mark is made by pressing on pin J, all as shown in Fig. 8.

I claim and desire to secure by Letters Patent—

1. The combination, with a heel-plate having a longitudinal slot in its upper face and shoulders at its lower edges, one end being curved and the other straight, of a slotted arm longitudinally adjustable, and provided with a toe-marking pin and a longitudinally-adjustable cylindrical toe-plate, substantially as set forth.

2. The combination, with a heel-plate having shouldered edges and grooved, one end being curved and the other straight, and a securing-bolt and thumb-nut, of a slotted adjustable arm having a heel and toe marking pin, and provided with a toe-plate formed by a screw-bolt having a cylindrical shank, substantially as set forth.

In testimony that I claim the foregoing as my own I have hereto affixed my signature in presence of two witnesses.

FREEMAN HENRY ROSSMAN.

Witnesses:

ALLAN SMITH,
H. CLAY ABEL.