

(No Model.)

H. LOTH.
COMMODE.

No. 258,087.

Patented May 16, 1882.

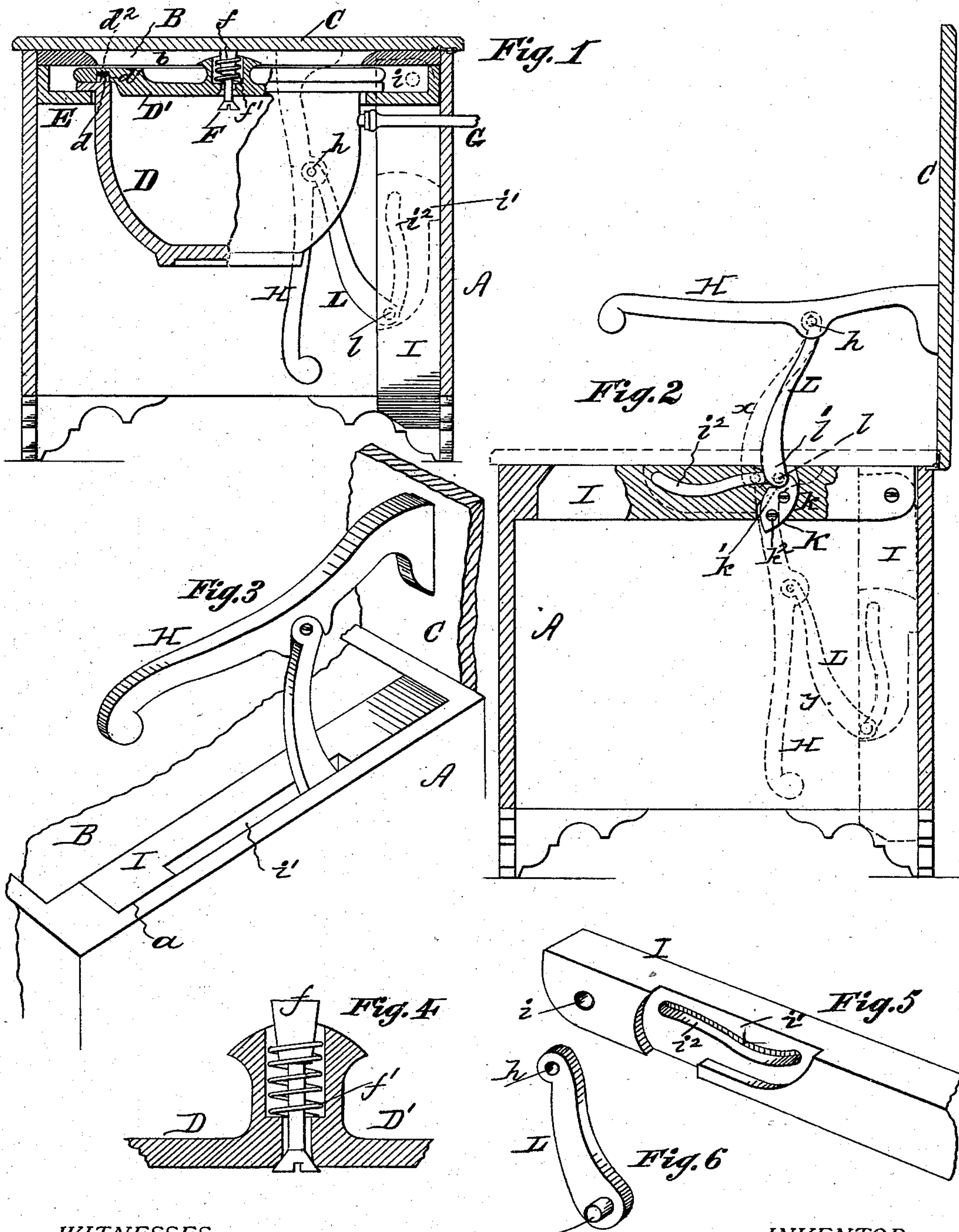

WITNESSES:

S. J. VanStavoren

Jos. B. Connolly

INVENTOR,

Henry Loth

by

Connolly Bros. ATTORNEYS

UNITED STATES PATENT OFFICE.

HENRY LOTH, OF PHILADELPHIA, PENNSYLVANIA.

COMMODE.

SPECIFICATION forming part of Letters Patent No. 258,087, dated May 16, 1882.

Application filed September 9, 1881. (No model.)

To all whom it may concern:

Be it known that I, HENRY LOTH, a citizen of the United States, residing at Philadelphia, in the county of Philadelphia and State of Pennsylvania, have invented certain new and useful Improvements in Commodes; and I do hereby declare the following to be a full, clear, and exact description of the invention, reference being had to the accompanying drawings, which form part of this specification, and in which—

Figures 1 and 2 are vertical sections of my improved commode, the former representing the commode closed and the latter opened. Fig. 3 is a perspective of one of the arms of the cover. Fig. 4 is a broken sectional view of pot-cover, showing the valve therein; and Figs. 5 and 6 are detail perspectives.

My invention has relation to commodes, and has for its object to provide improved means for ventilating the pot and improved arms and means for supporting and locking the same and the cover of the commode when raised.

A further object of my invention is to provide means for closing the arm-openings when the cover is raised.

My improvements consist, first, in the combination, with the pot-lid, of a valve therein which automatically closes, but is opened by the pressure of the commode-cover when the latter is down; and, second, in the combination, with the commode-cover and commode-body, of arms rigidly secured to said cover, and connected by pivoted braces with swinging guide-levers and supporting-buttons secured to said body, as hereinafter more fully described; third, in the provision of means for closing the arm-openings on either side of the "hole" in the seat when the commode-cover is raised.

Referring to the accompanying drawings, A designates the commode-body; B, the seat, having a hole, *b*, and C the hinged cover.

D is the pot, which rests in or upon a diaphragm, E, below the seat B, and is provided with a lid, D'. The rim or edge of said pot has an annular tongue or bead, *d*, which enters a corresponding groove, *d'*, in the lid D'. In this groove is a rubber gasket or ring, *d*², against which the bead *d* presses, thereby forming a tight joint.

F represents a valve in the center of the lid D', whose stem *f* has a spring, *f'*, the tendency of which is to keep said valve constantly closed. Said stem, however, projects above the pot-lid D' so far that it is met by the cover when the latter is down, whereby the valve is opened. The object of this is to give admission for atmospheric pressure to promote ventilation of the pot by exhausting odors and gases through a ventilating-pipe, G, which is designed to pass from said pot through an opening in the commode-body to a chimney or flue.

H H represent arms rigidly secured to the commode-cover and projecting therefrom, as shown. When the cover is turned down said arms pass down into openings *a a* on either side of the hole in the seat B. When said cover is raised it is desired to support said arms and to close said openings. To effect this I provide levers I I, which are pivoted at *i i*, at the inner end of said openings, to the sides of the commode-body. Said levers have elongated recesses *i'* *i'* on their outer sides and curved grooves *i*² *i*², as shown.

K K are buttons, of the peculiar shape shown, having curved or convex outer sides or edges, *k*, and depressions or sockets *k'* on their upper sides. These buttons are secured to the commode-sides by screws *k*².

L are braces which are pivoted or hinged to the arms H at *h*, and have at their opposite ends lateral studs *l*, which enter the grooves *i*² in the levers I. When the cover C is down the parts occupy the relative positions shown in Fig. 1, the levers I being depressed, the arms H in the openings *a*, and the studs *l* at the outer or lower extremities of the grooves *i*². As the cover C is raised the arms H come up with it, lifting the levers I into a horizontal plane, so as to close the openings *a*. The studs *l* at the same time traverse the grooves *i*² until the ends *l'* of the braces L come over the buttons K, when said ends drop into the sockets or depressions *k'* therein. This produces an automatic lock, so that downward pressure on the arms will not move the latter nor the cover. To shut down said cover the pivoted braces must first be drawn forward sufficiently to clear the buttons, as shown in dotted lines *x*, Fig. 2, whereupon said cover, with the arms

and levers, will descend to occupy the position shown in dotted lines *y*, Fig. 2.

What I claim as my invention is as follows:

1. The pot-lid having a self-closing valve, 5 F, with stem *f* projecting above said lid, whereby said valve is adapted to be opened by the pressure or impact on its stem of the commode-cover, substantially as shown and described.

10 2. The combination of a pot having a lid with self-closing valve F with a commode having a cover, which, when down or closed, opens said valve to admit air to the pot, substantially as shown and described.

15 3. The combination, with the commode-body A, having buttons K and pivoted levers I, with recesses *i'* and grooves *i*², of cover C, having arms H and pivoted braces L, said parts be-

ing constructed and combined for operation substantially as shown and described. 20

4. In a commode having openings on either side of the hole or seat-opening for the passage of the arms when the lid or cover is turned down or closed, the combination, with said openings, of hinged bars for closing up or 25 occupying said side openings when said lid or cover is raised, substantially as shown and described.

In testimony that I claim the foregoing I have hereunto set my hand this 8th day of 30 September, 1881.

HENRY LOTH.

Witnesses:

S. J. VAN STAVOREN,
JOHN W. STEWARD.