

(No Model.)

M. S. WEBB & R. L. MYRICK.
Hand Mirror Holder.

No. 231,126.

Patented Aug. 10, 1880.

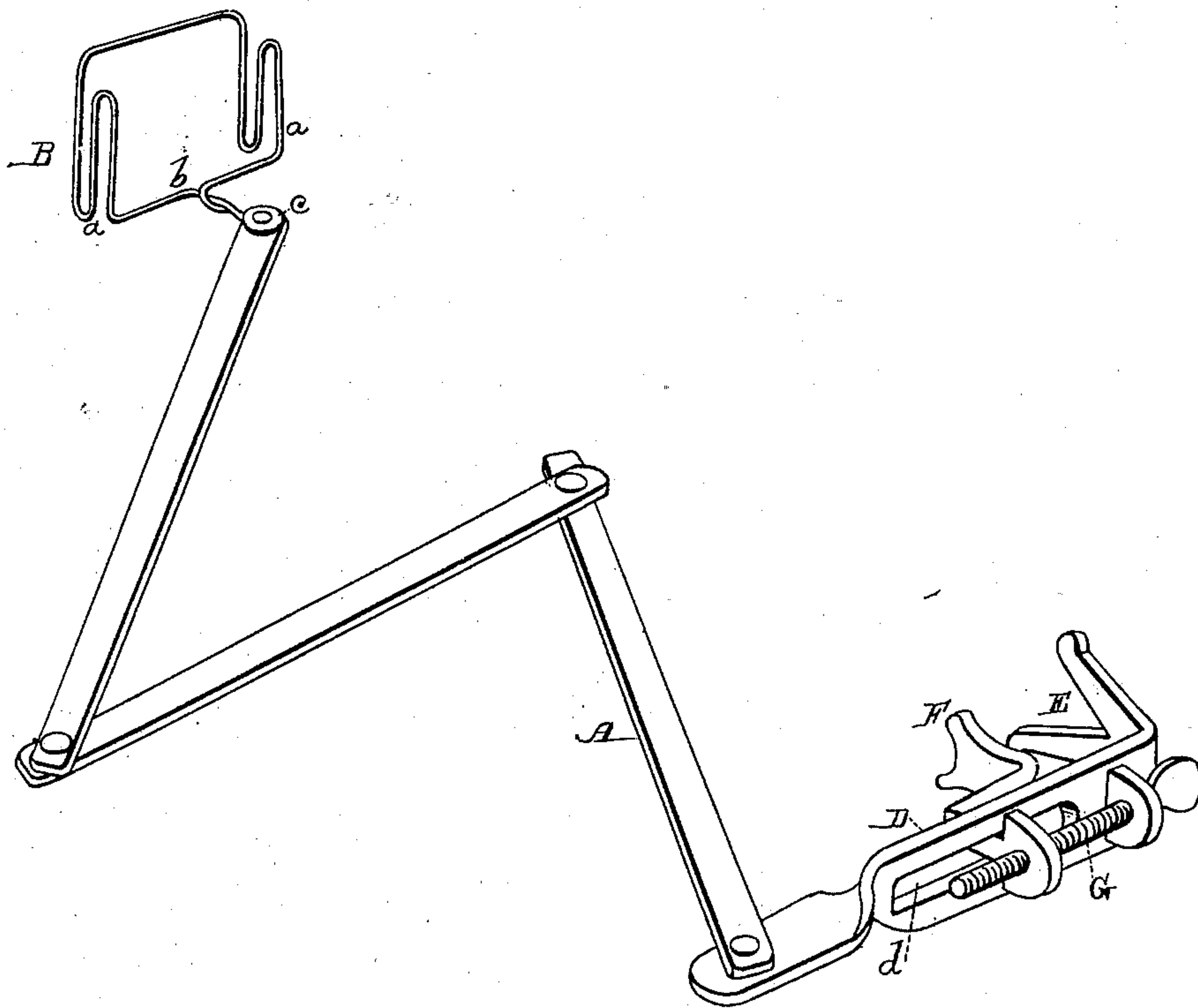

Witnesses

Frank A. Groves
H. F. Dexter

Inventors

Myron S. Webb
Robert L. Myrick
By Quincy
Atty.

UNITED STATES PATENT OFFICE.

MYRON S. WEBB AND ROBERT L. MYRICK, OF STOCKTON, CALIFORNIA.

HAND-MIRROR HOLDER.

SPECIFICATION forming part of Letters Patent No. 231,126, dated August 10, 1880.

Application filed May 22, 1880. (No model.)

To all whom it may concern:

Be it known that we, MYRON S. WEBB and ROBERT L. MYRICK, of Stockton, county of San Joaquin, and State of California, have invented a Hand-Mirror Holder; and we hereby declare the following to be a full, clear, and exact description thereof.

Our invention relates to a novel extension-arm for holding a hand-glass, in conjunction with a clamp, by which the same may be supported and adjusted with reference to a mirror-frame, so that the hand-glass may be held in any desired position with reference to the mirror for the purposes of the toilet, as will be more fully described by reference to the accompanying drawing, in which the figure is a perspective view of our device.

When ladies have their own toilet to make it is necessary to use a hand-glass in conjunction with the mirror, and it is difficult to hold the glass while performing the necessary operations. To remedy this difficulty a series of small permanently-fixed mirrors have been arranged with relation to each other so that a person might stand between them, but would have to leave their position after inspecting, in order to do anything, because of the contracted space.

Our invention is designed to hold any hand-glass firmly upon an extension-arm, which may be readily adjusted to any height upon the mirror-frame, and the hand-glass may be placed in any desired position with reference to the mirror, and at such a distance from it that the person may have a clear view and remain in their place until the operation has been completed.

A is the extension-arm of our device, which is formed of a series of short lengths so jointed together that they may be elongated or folded upon themselves, and they may be turned to form any curve or to stand at any point within the radius of their length, in a manner similar to gas-jet brackets.

At the end of the arm of the extension is fixed the glass-holder, B, which consists of a single piece of wire of sufficient strength and elasticity, bent upon itself so as to form a support for the glass across its back, and thence it is bent downward upon each side, then upward and downward again, as at *a*. The ends are then brought together in the center and extended horizontally, as at *b*, to a point, *c*, where they are pivoted to the end of the outer

arm of the extension. This forms an elastic holder, which will adapt itself to any form of hand-glass and hold it securely without obstructing its face. It also allows of its adjustment to any angle or position independent of the position of the extension-arm.

In order to secure this device to the mirror-frame and allow it to be adjusted to any height, we form a clamp, which consists of a plate, D, having one end horizontal and flat, so that the inner arm of the extension may be pivoted to it. The other end of the plate is forked, as at E, and bent at right angles, so that the two forked ends will pass behind the mirror-frame.

The other jaw, F, of the clamp has its width narrower than the distance between the forks E, so that when forced against the frame its pressure is exerted between the ends of the fork, and will thus cause it to be much firmer than if the jaws were plain and of equal size. These jaws may be lined with any soft fabric which will protect the mirror-frame from injury.

The jaw F has a stem which passes through a slot, *d*, in the plate D, and has a nut upon the opposite side, through which a screw, G, turns. By means of this screw the jaw F is set firmly up against the mirror-frame, and the device may be set at any point without injury to the frame.

The jointed arm allows the hand-glass to be firmly held in its elastic holder and set at any angle or point with reference to the mirror, while the person may stand between the two and perform the operations of the toilet without leaving her position.

Having thus described our invention, we do not claim, broadly, supporting or adjusting the position of a mirror, nor the extension-arm, nor a clamp, when used independently of each other; but

What we do claim as new, and desire to secure by Letters Patent, is—

The elastic hand-glass holder, consisting of the parts B *a b c*, when attached to the end of the jointed arm A, so as to be swiveled to any position independent of the arm, substantially as herein described.

In witness whereof we have hereunto set our hands.

MYRON S. WEBB.
ROBERT L. MYRICK.

Witnesses:

W. G. CURTIS,
THOS. McMAHON,