

H. GALE.
Plow.

No. 200,861.

Patented March 5, 1878.

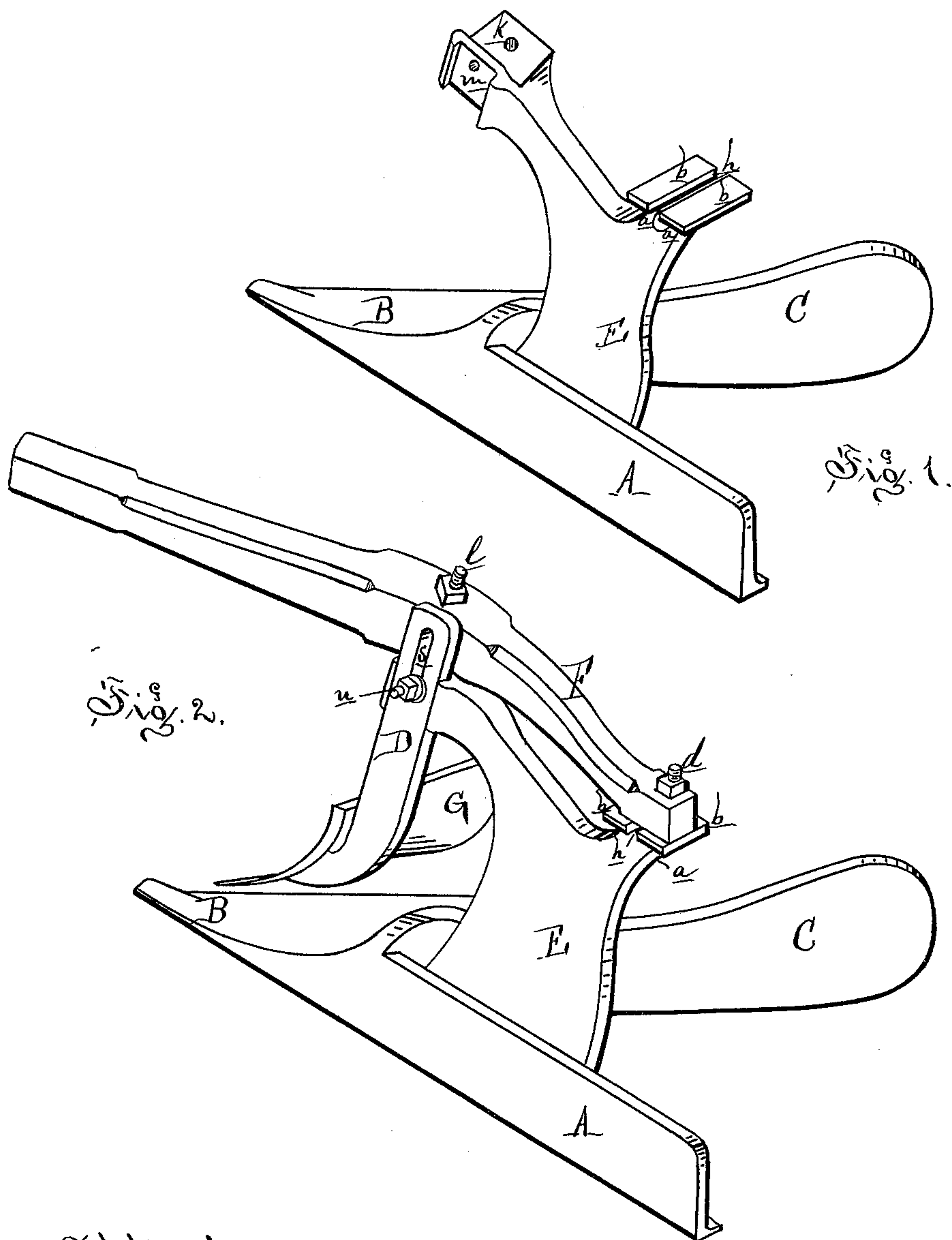

Attest:
S. L. Aylls
Notary Public.

Inventor:
H. Gale
By Atty
Thos. D. Sprague

UNITED STATES PATENT OFFICE.

HORATIO GALE, OF ALBION, MICHIGAN, ASSIGNOR TO GALE MANUFACTURING COMPANY, OF SAME PLACE.

IMPROVEMENT IN PLOWS.

Specification forming part of Letters Patent No. **200,861**, dated March 5, 1878; application filed December 31, 1877.

To all whom it may concern:

Be it known that I, HORATIO GALE, of Albion, in the county of Calhoun and State of Michigan, have invented a new and useful Improvement in Plows; and I do declare that the following is a true and accurate description thereof, reference being had to the accompanying drawings, and to the letters of reference marked thereon, and being a part of this specification.

The nature of my invention relates to a new and useful method of attaching a jointer, or smaller plow, to the larger plow, so that, no matter what the position of the beam, the point and land-side of the jointer will be in the same vertical plane of the larger plow to which it is attached.

The invention consists in the construction of the plow-standard and the manner in which the jointer is attached thereto, and its combination with an adjustable plow-beam.

Figure 1 is a perspective view of a plow, showing my improvements in part, and with the beam and jointer removed. Fig. 2 is a like view, with the beam and jointer attached in place.

Like letters indicate like parts in each figure.

In the drawings, A represents the land-side, B the point, and C the mold-board, of any of the usual forms, and secured together and to the standard E in the ordinary manner. The standard, however, differs from the ordinary standards in the following particulars: The upper end curves slightly to the rear, as shown, where it is transversely bifurcated, each arm *a* terminating in the flanged tops *b*, so that the bolt *d*, which secures the rear end of the

adjustable beam F, passes upward through the transverse space *h*, between the arms *a*, and through the beam, where it is secured by a nut, while the head of said bolt engages with the under faces of flanged tops *b*. Lowering the nut will allow this end of the beam to be transversely adjusted at will. The upper end of the standard also curves to the front, as shown, terminating in a flat bearing-surface, *k*, through which a bolt, *l*, passes to secure the beam to said surface, and to act as a pivot in the lateral adjustment of the beam. On the land-side side of this standard is cast, or otherwise conveniently secured, the recessed flange *m*, through which passes the bolt *n*, by means of which the jointer-arm D is secured between the nearly vertical sides of the recess in the flange. This arm D is vertically adjustable on the bolt *n* by means of the slot *s*, and the jointer G is secured to the lower extremity of this arm, care being taken that the point and land-side be in vertical line with the point and land-side of the larger plow.

What I claim as my invention, and desire to secure by Letters Patent, is—

In a plow, the standard E, curved to the front and rear, and having the vertical flanged recess *m* on the extreme forward and upper part of the front projection of the standard for receiving a jointer-arm, D, in combination with an adjustable beam, F, pivoted to the forward projection of the plow-standard, substantially as described and shown.

HORATIO GALE.

Witnesses:

CHAS. THURMAN,
H. S. SPRAGUE.