

D. WALTHER.
Stove-Leg.

No. 199,763.

Patented Jan. 29, 1878.

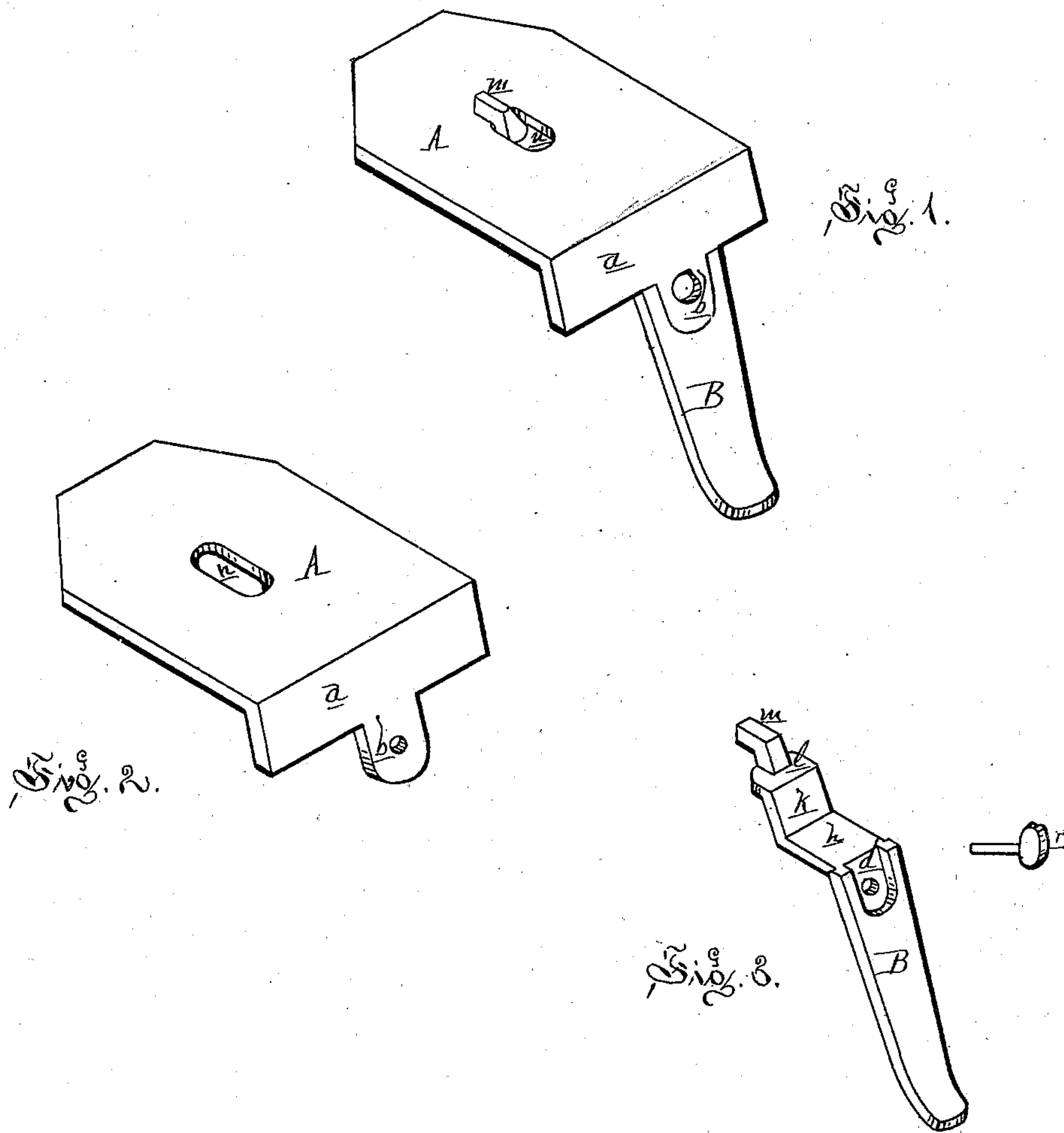

Attest:
H. L. Ault
Chas. Hurman.

Inventor:
D. Walther
By atty
Jas. S. Sprague

UNITED STATES PATENT OFFICE.

DANIEL WALTHER, OF DETROIT, MICHIGAN.

IMPROVEMENT IN STOVE-LEGS.

Specification forming part of Letters Patent No. **199,763**, dated January 29, 1878; application filed November 22, 1877.

To all whom it may concern:

Be it known that I, DANIEL WALTHER, of Detroit, in the county of Wayne and State of Michigan, have invented a new and useful Improvement in Stove-Legs; and I do declare that the following is a true and accurate description thereof, reference being had to the accompanying drawings, and to the letters of reference marked thereon, and being a part of this specification, in which—

Figure 1 is a perspective view of a section of a stove-bottom with leg attached. Fig. 2 is a like view of a section of a stove-bottom with the leg detached. Fig. 3 is a like view of the stove-leg detached.

Like letters refer to like parts in each figure.

The nature of my invention relates to a new and novel construction of a stove-leg, and manner of attaching the same to a stove-bottom, so that it will not be liable to become detached accidentally.

In the drawings, A represents a section of a stove-bottom, provided with a downwardly-projecting flange, *a*, which, in turn, is provided with a perforated projecting lip, *b*.

The leg B is made substantially of the form shown, with its front provided with a recess, *d*, of the form and size of the lip *b*, and with a perforation, coincident when the parts are in juxtaposition with the perforation in the lip *b*.

The top of the leg, which is designed to allow the flange *a* to rest upon it, is provided with rearwardly and upwardly projecting flanges *h*, *k*, and *l*, and the latter terminates in an upwardly and rearwardly projecting lug, *m*, which is designed to pass through the slot *n* in the stove-bottom from below and hook upon the upper surface of said bottom when the leg is in place.

A plain screw or a thumb-screw, *r*, is employed to hold the leg in place, the screw entering the perforations in the lip and recess of the leg, one or both of which are threaded for that purpose.

I am aware of the patent granted February 3, 1874, to J. Ziegler, and hereby disclaim the same; but

What I claim as my invention, and desire to secure by Letters Patent, is—

The combination, with the stove-bottom A, having the slot *n* and depending lip *b*, of the leg B, provided with the recess *d*, flanges *h* *k* *l*, and lug *m*, all constructed and arranged substantially as described and shown.

DANIEL WALTHER.

Witnesses:

H. S. SPRAGUE,
CHAS. THURMAN.