

E. PINCUS & C. A. HART.

FLAG-STAFF HOLDER.

No. 173,055.

Patented Feb. 1, 1876.

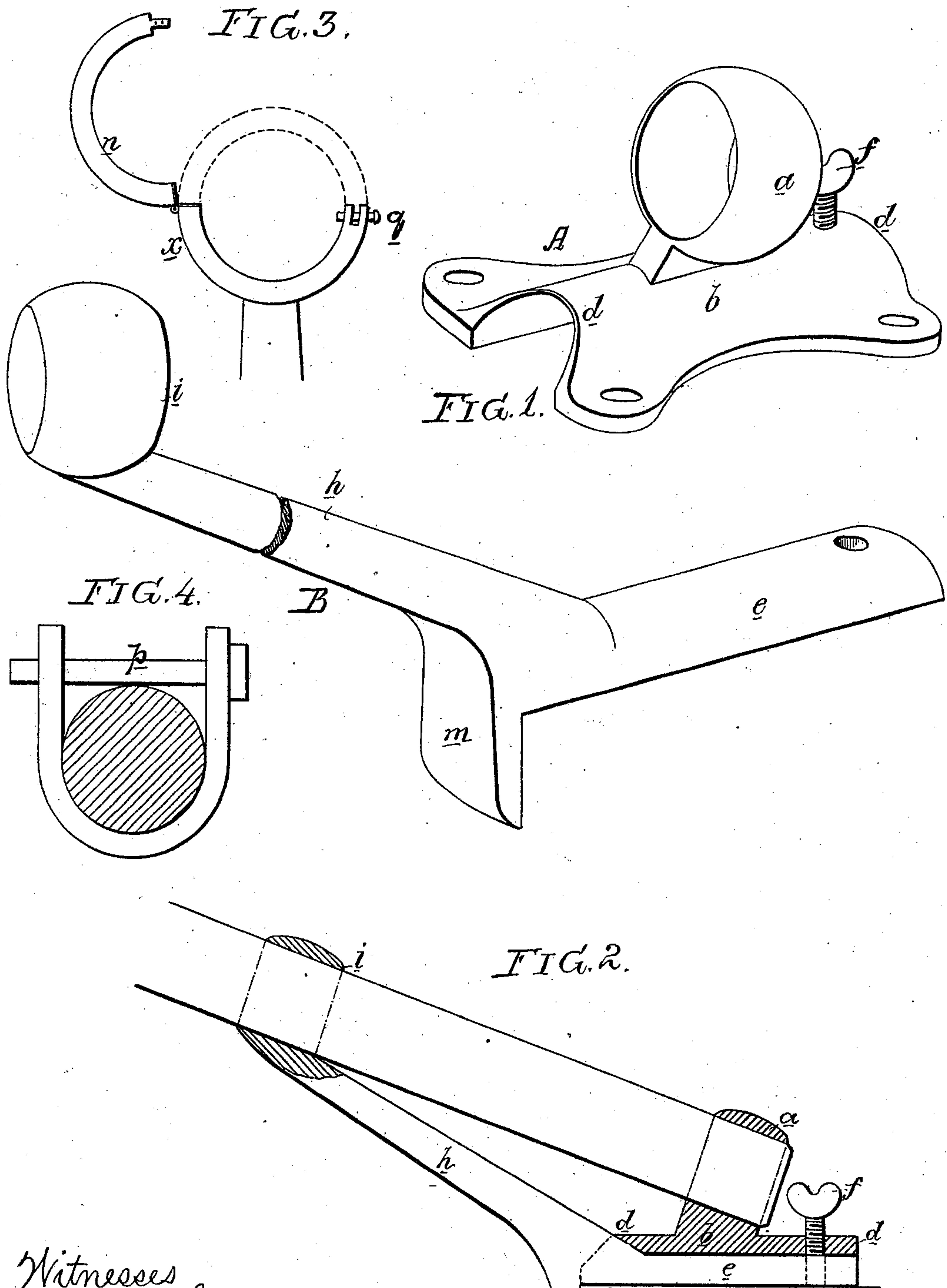

Witnesses
Harry Houson & Co
Harry Smith

Edward Pincus
and Clarence A. Hart
by their Attorneys
Houson and Son

UNITED STATES PATENT OFFICE.

EDWARD PINCUS AND CLARENCE A. HART, OF PHILADELPHIA, PA.

IMPROVEMENT IN FLAG-STAFF HOLDERS.

Specification forming part of Letters Patent No. **173,055**, dated February 1, 1876; application filed January 21, 1876.

To all whom it may concern:

Be it known that we, EDWARD PINCUS and CLARENCE A. HART, of Philadelphia, Pennsylvania, have invented an Improved Flag-Pole Holder, of which the following is a specification:

Our invention relates to an improvement in holders through the medium of which flag-poles may be attached to window-sills; and the main object of our invention is to construct a holder for the ready removal and replacing of the pole.

This object we attain in the manner which we will now proceed to describe, reference being had to the accompanying drawing, in which—

Figure 1 represents the two main parts of the holder detached from each other; Fig. 2, a sectional view, showing the two parts of the holder connected together; and Figs. 3 and 4, different devices for retaining and releasing the pole.

Our improved holder consists of two main parts, A and B, the former of which has a ring or socket, *a*, for receiving the inner end of the flag-pole, this ring projecting from and forming a part of a plate, *b*, through lugs on which pass screws into the window-sill. Between a central raised portion, *d*, of this plate *b* and the window-sill, there is a recess for the reception of the projection *e* of the part B, the said projection being secured in its place by a set-screw, *f*, or other suitable fastening. The arm *h* of the portion B of the holder has, at its outer end, a ring or bearing, *i*, for receiving the flag-pole, and at or near the point where the arm meets the projection there is a lip, *m*, bearing against the sill of the window.

The ring *i* may be continuous, as shown in Fig. 1; but we prefer to make it with a loose segment, *n*, hinged at one side to the permanent segment, which forms a part of the arm, and connected at the opposite side to the same permanent segment by a pin, *q*, or other fastening, on the withdrawal of which the loose segment can be thrown back, as shown in Fig. 3, releasing the pole, which can be de-

tached by a slight outward movement from the ring *a*, instead of the extended movement which would be required if the pole had to be drawn outward through a continuous ring on the end of the arm.

Another advantage of this mode of construction is, that the lower segment of the ring *i* forms a support for the pole when the latter is being placed in position, thereby greatly lessening the labor of extending the same.

The retaining device shown in Fig. 4 may be substituted for the hinged segment. In this modification all that is necessary is to withdraw the pin *p* in order to release the pole from the end of the arm.

The portion A of the holder is so formed that it will occupy a position on the window-sill outside the sash, so as not to interfere with the movements of the same, or the closing of the shutters, the plate with its ring or socket forming a permanent fixture on the sill, from which the portion B may be withdrawn when the display of a flag is not required.

We claim as our invention—

1. The within-described flag-pole holder, consisting of the portion A and its ring or socket *a*, constructed for attachment to the window-sill, as set forth, and the part B, having its outer end constructed for the reception of the pole, and its inner end for attachment to and detachment from the portion A, all substantially as specified.

2. The portion B of the holder, in combination with a socket or bearing for the pole, and a device for permitting the direct vertical insertion or withdrawal of the pole from the said bearing or socket, all substantially as described.

In testimony whereof we have signed our names to this specification in the presence of two subscribing witnesses.

ED. PINCUS.

CLARENCE A. HART.

Witnesses:

HARRY HOWSON, Jr.,

HARRY SMITH.