

T. SCHOFIELD.

Needle-Threaders for Sewing-Machines.

No. 143,098.

Patented September 23, 1873.

Fig. 1

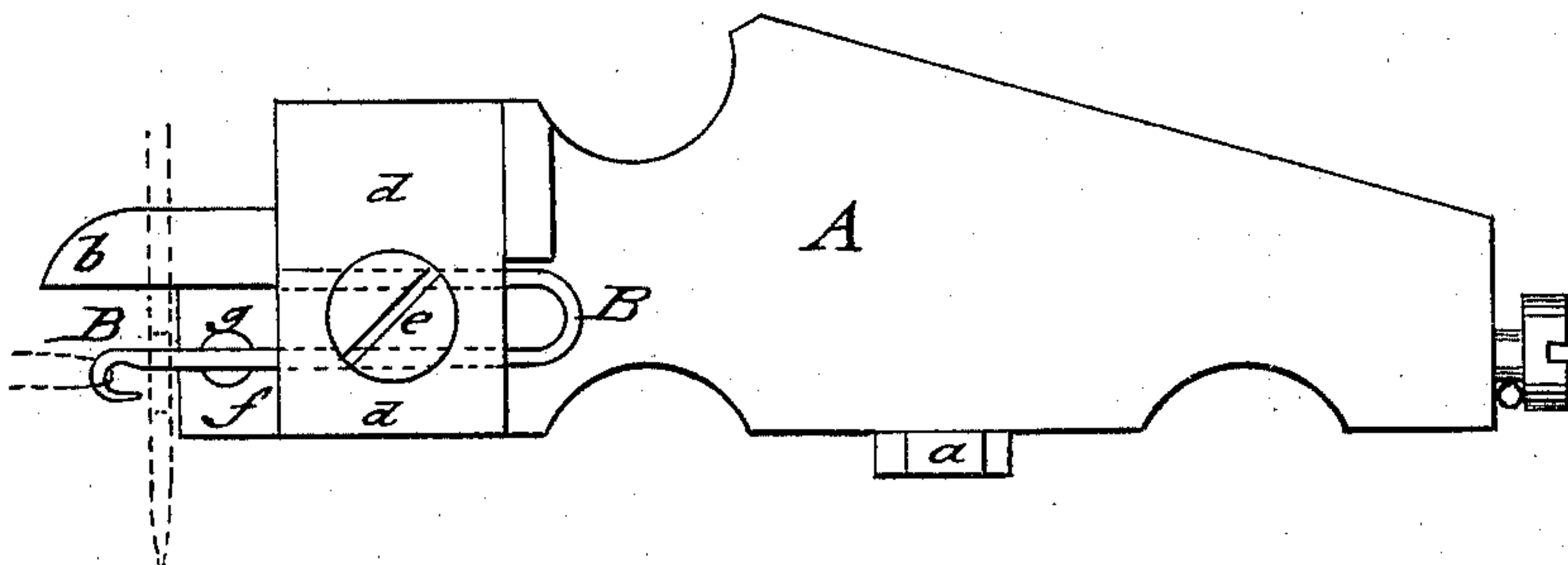

Fig. 2.

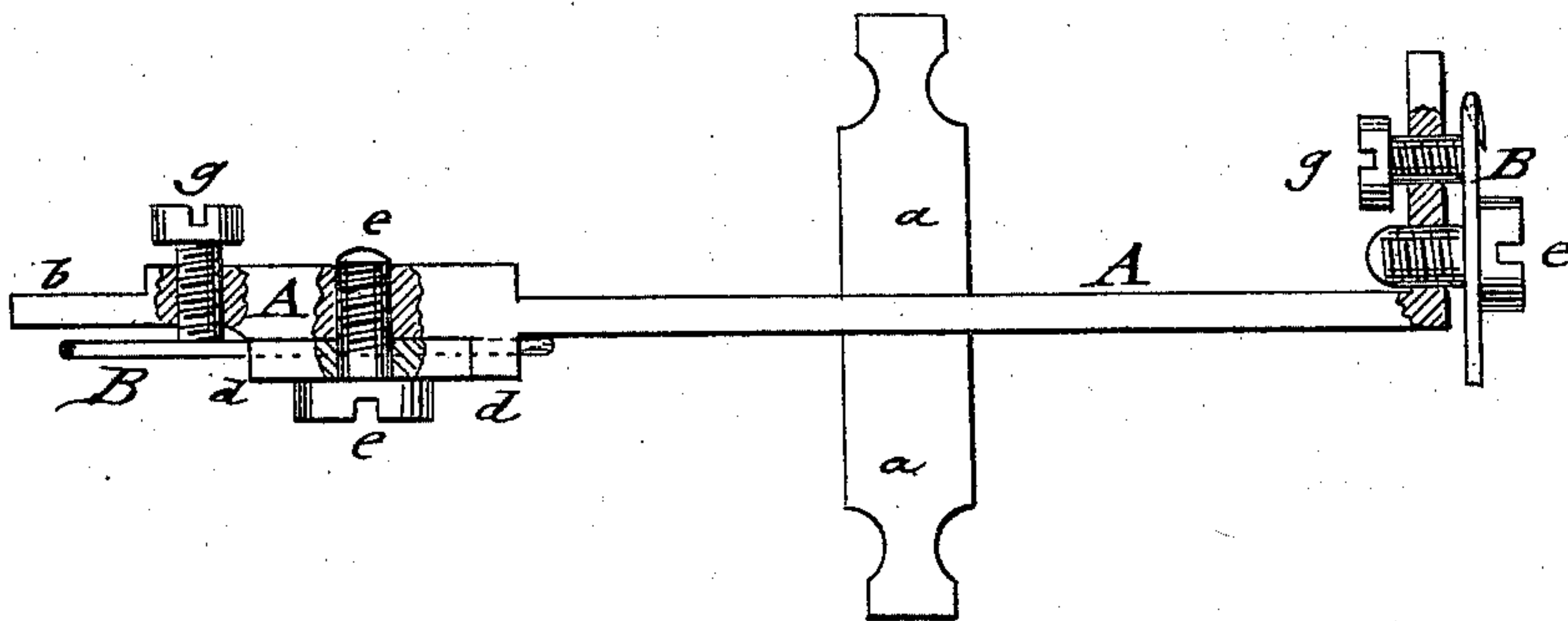
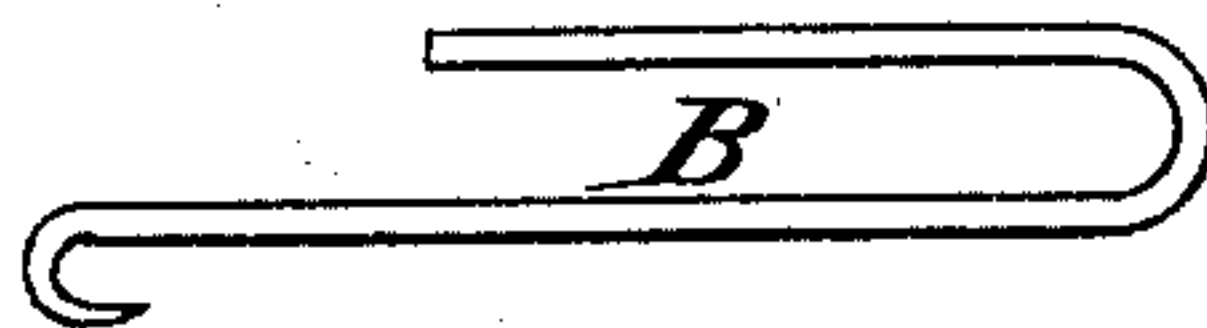

Fig. 3.



Witnesses.

E. Wolff.
Sedgwick

Inventor.

T. Schofield
Per *Munn & Co.*
Attorneys.

UNITED STATES PATENT OFFICE.

THOMAS SCHOFIELD, OF GRASS VALLEY, CALIFORNIA.

IMPROVEMENT IN NEEDLE-THREADERS FOR SEWING-MACHINES.

Specification forming part of Letters Patent No. **143,098**, dated September 23, 1873; application filed June 7, 1873.

To all whom it may concern:

Be it known that I, THOMAS SCHOFIELD, of Grass Valley, in the county of Nevada and State of California, have invented a new and Improved Needle-Threader, of which the following is a specification:

In the accompanying drawing, Figure 1 represents a side view of my needle-threader. Fig. 2 is a plan view of the same, partly in section; and Fig. 3, a detail side view of the hook for drawing the thread through the eye of the needle.

Similar letters of reference indicate corresponding parts.

The invention consists in the improvement of needle-threaders, as hereinafter fully described and pointed out in the claim.

In the drawing, A represents the body or handle part of the needle-threader, of thin sheet metal, or other suitable material. Its lower edge is provided with a lateral foot, *a*, on which the instrument may be placed in an upright position. At one end of the handle A is a forward-projecting guide-piece, *b*, which passes up and down along the side of the needle, until the hook B, which is placed in the same direction, but slightly to the side of guide B, strikes the eye of the needle and enters

through it. The hook B has a curved end of very small size, and is made preferably of steel. It takes up the thread and draws the same back through the eye of the needle. The rear part of the hook B is bent in U shape, and held in a groove in handle A by means of plate *d* and screw *e*, or by the head of the clamp-screw *e* alone, as desired. A projecting plate, *f*, of handle A, below guide-piece *b*, carries a small set-screw, *g*, which bears against the hook, and regulates the distance of the same from guide-piece *b*, to be adjusted to needles of different thicknesses. At the other end of handle A, a hook and needle-guide are placed in similar manner, but under a right angle to the body of the handle, so that needles may be threaded from the sides, back, or front.

Having thus described my invention, I claim as new and desire to secure by Letters Patent—

The screw *g*, plate *f*, and guide, combined with handle A and hook B, as and for the purpose described.

THOMAS SCHOFIELD.

Witnesses:

A. B. DIBBLE,
JAS. K. BYRNE.