

D. H. NATION & E. C. LITTLE.

Reservoir Cooking-Stoves.

No. 142,932.

Patented September 16, 1873.

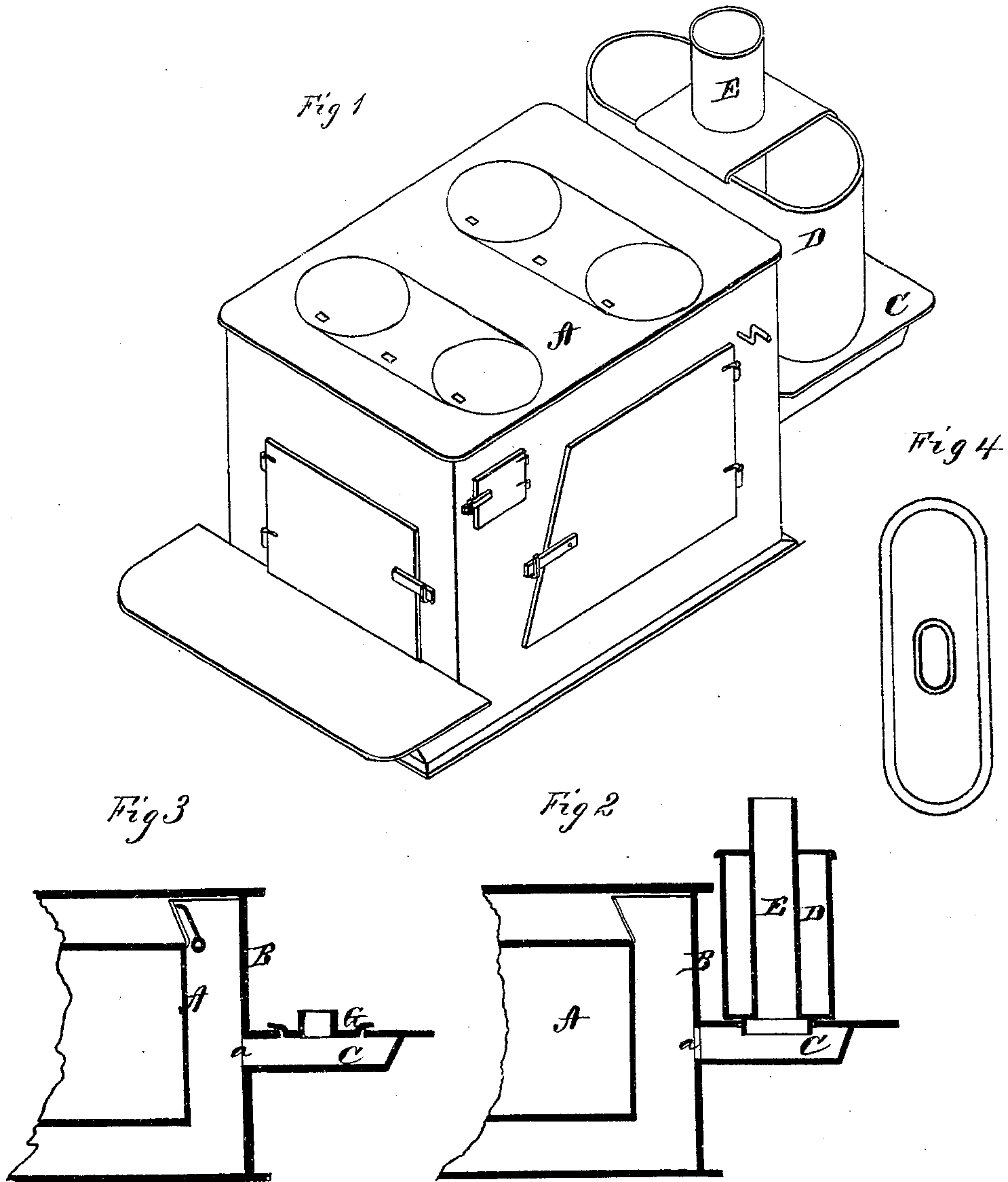

Witness:
Frank L. Curand
C. L. Ewert

Inventor,
David H. Nation.
Ezekiel C. Little.
per *Handy Mason*
Attorneys.

UNITED STATES PATENT OFFICE

DAVID H. NATION AND EZEKIEL C. LITTLE, OF ST. LOUIS, MISSOURI.

IMPROVEMENT IN RESERVOIR COOKING-STOVES.

Specification forming part of Letters Patent No. **142,932**, dated September 16, 1873; application filed February 21, 1873.

To all whom it may concern:

Be it known that we, DAVID H. NATION and EZEKIEL C. LITTLE, of St. Louis, in the county of St. Louis and in the State of Missouri, have invented certain new and useful Improvements in Reservoir Cooking-Stove; and do hereby declare that the following is a full, clear, and exact description thereof, reference being had to the accompanying drawings and to the letters of reference marked thereon making a part of this specification.

Our invention relates to that class of cooking-stoves in which a reservoir is placed on the rear of the back-plate; and it consists in a base-pan extended rearward from the back-plate and at a point about midway between the top and bottom plates, said base-pan being provided with a broad flue communicating with the central stove-flue and delivering the products of combustion to the exit-pipe. A water-reservoir may be placed in the aperture of the upper plate of the base-pan, and when removed the aperture is covered by a suitable lid, all as more fully hereinafter set forth.

In order to enable others skilled in the art to which our invention appertains to make and use the same, we will now proceed to describe its construction and operation, referring to the annexed drawing, in which—

Figure 1 is a perspective view of a cooking-stove embodying our invention. Fig. 2 is a longitudinal vertical section of the rear part of the same, and Fig. 3 is a similar section, showing the reservoir removed from the stove. Fig. 4 represents a plan view of the detachable plate used upon the base-pan.

A represents an ordinary three-flue cooking-stove, upon the back-plate B of which is formed a base-pan, C, a suitable distance below the top plate of the stove. In the top of this base-pan is an opening large enough to receive the water-reservoir D, the pan extending under the whole of the bottom of the reservoir. In the center of the back-plate B is an aperture, *a*, connecting the back center-flue with the pan. Through the center

of the reservoir D passes the exit-flue pipe E, as shown.

It will be seen that the base-pan C is arranged at a point about midway between the top and bottom plates of the stove. By thus arranging this pan we are enabled to receive the direct draft or products of combustion of the stove under and through the boiler, as well as the reverse draft or products of combustion that pass around the oven and through the center flue of the stove and boiler also, so that all of the heated products of combustion pass directly under and through the boiler. This arrangement of the base-pan also enables us to provide for a warming-closet under the pan, and when the boiler or reservoir is applied its top is on, or about on, a line with the top plate of the stove. By passing the pipe directly through the reservoir we avoid the necessity of extending the base-pan too far rearward, and also communicate additional heat to the water in the boiler.

When the reservoir is used in this form we propose to make it of copper, though it may be made of cast-iron, and it may be made portable, or otherwise, as desired.

When the reservoir is removed from the base-pan a cover, G, is used, as shown in Fig. 3, having the exit-flue opening in the center or other suitable part of the same. The advantage of this cover is that, in case the reservoir should, from any cause, become damaged or broken, it can be taken off for repairs, and, by the use of the plate-cover, the operation of the stove is nevertheless perfect.

We do not claim under this patent the arrangement of an air-chamber communicating at the top with the air in the room between the stove-back and reservoir-front; nor do we claim the sheet-flue under the reservoir-bottom, as herein shown, as these features are the subject-matter of a separate application for Letters Patent applied for by us.

Having thus fully described our invention, what we claim as new, and desire to secure by Letters Patent, is—

The combination, with a cooking-stove, of a base-pan, C, extended rearward from a point about midway between the top and bottom plates of the stove, containing the broad flue and sustaining the reservoir D and exit-flue, substantially as set forth.

In testimony that we claim the foregoing

we have hereunto set our hands this 1st day of February, 1873.

DAVID H. NATION.
EZEKIEL C. LITTLE.

Witnesses:

BENJAMIN S. BUCK,
ARTHUR L. PIERCE.