

R. P. TICKLE.
Stereotype-Block.

No. 128,826.

Patented July 9, 1872.

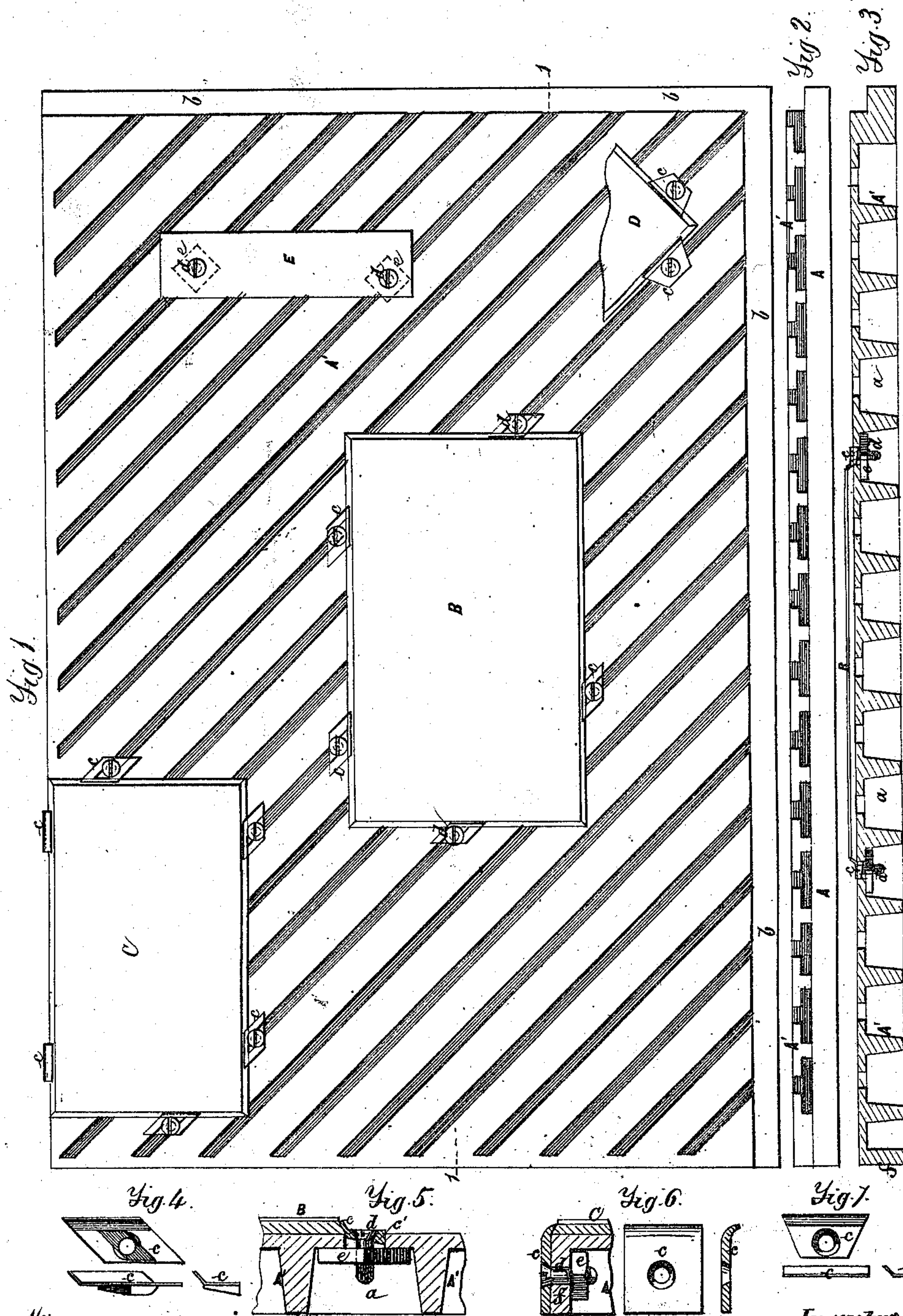

Witnesses
for O. Dewey,
53 Chancery Lane, London.
H. Lash

Inventor
Robert P. Tickle

UNITED STATES PATENT OFFICE.

ROBERT P. TICKLE, OF LONDON, ENGLAND, ASSIGNOR TO GEORGE HOLT MASON, OF SAME PLACE.

IMPROVEMENT IN STEREOTYPE-BLOCKS.

Specification forming part of Letters Patent No. 128,826, dated July 9, 1872.

SPECIFICATION.

To all whom it may concern:

Be it known that I, ROBERT PURDY TICKLE, of Sherborne Street, Blandford Square, London, county of Middlesex, England, have invented "Improvements in Mounting and Securing Stereotype and other Plates in the required position for Printing;" and I do hereby declare that the following is a full, clear, and exact description thereof, which will enable others skilled in the art to make and use the same, reference being had to the accompanying drawing, forming part of this specification, in which—

Figure 1 is a plan view of my improved bed. Fig. 2 is an edge view of the same. Fig. 3 is a section on line 1 1, Fig. 1. Figs. 4, 5, 6 and 7 are detached views, on a larger scale, of some of the parts hereinafter described.

My invention relates to an improved means of mounting and securing stereotype and other plates in a printing-press, whereby a great saving of time and labor is effected, inasmuch as by my invention I am enabled to dispense with the ordinary chases, leads, and other pieces technically called "furniture," used for fixing the plates when the same are mounted on the ordinary blocks.

The bed consists of a rectangular frame, A, crossed by a number of obliquely-placed bars, A', of T-form, in cross-section, with a groove or space, *a*, between the bars to receive the fastenings which hold the stereotype or other plates on the bed. These bars A' are preferably inclined at an angle of forty-five degrees to the side of the bed. The bed A, with its cross-bars A', is preferably cast in one piece, in iron or other suitable metal, and its top and bottom surfaces (that is to say, the top and bottom surfaces of the cross-bars A') are planed smooth and level, so that each bar of the bed will rest fairly on the coffin of the press and be enabled to sustain any degree of pressure. B C D E are stereotype-plates, attached to bed A to show the various fastenings which may be employed. The plate B is secured by clips *c*, shown separately on an enlarged scale. (Fig. 4.) For this purpose the edges of the

stereotype-plate are beveled and the clip is also bent upward, as shown, so as to grip the edge of the plate B and hold it securely in position. A stud, *c'*, is raised at the back of clip *c* by punching, the said stud *c'* being intended to fit between the bars A' so as to allow clip *c* to slide along the groove from or toward the stereotype-plate B, with its raised edge always parallel to the edge of plate B. The clip *c* is fixed by a screw, *d*, passing through it and between the flanges of bars A' into a nut, *e*, in the groove *a* at back. (See detached view, Fig. 5, drawn on a larger scale.) The nut *e* is free to slide up and down said groove, but cannot turn therein, so that the nut will be held while the screw *d* is tightened up. A rabbet, *b*, is planed along one side and end of the bed A to open the ends of all the grooves *a* to permit the insertion of the clip with the screw and nut attached without lifting or moving the bed A from the press. By making the grooves in the bed oblique or diagonal I am enabled to shift the stereotype or other plate in any direction. D is a portion of a plate attached by a clip *c*, shown separately in Fig. 7, made plain without any stud at back to admit of its being turned in any direction to fix a plate whose edge is not parallel with the edge of the bed A. I may also dispense with clip *c*, and pass the screw *d* through the stereotype or other plate, as when the latter is screwed on to wood. Plate E is shown attached in this manner. The screws pass between the bars of the bed into a nut sliding in the groove *a* at back, as before. This method, however, affords less facility of adjusting the position of the plate. The sides *f* of the bed which are plain are made narrower than the other two sides in which the rabbet *b* is made, and four similar beds A may be combined with their edges *f* together so as to form a bed for a plate of larger dimensions. The bed A is fixed in the coffin of the press by means of a side-stick and quoin, or other device, in the ordinary manner of fixing the chase hitherto employed, and similarly when several beds are combined.

Having thus described my invention, I claim

as new and desire to secure by Letters Patent—

The bed A, provided with oblique bars A' and intervening grooves a, in combination with screw-clips c d and nuts e, (or equivalents,) substantially as and for the purpose set forth.

The above specification of my invention,

signed by me this eighteenth day of March, 1872.

ROBERT PURDY TICKLE.

Witnesses:

J. B. WYNN,

24 *Royal Exchange.*

JAS. O. DEWEY,

53 *Chancery Lane, London.*