

WATSON SANFORD.

Improvement in Fire Place Ranges.

No. 115,644.

Patented June 6, 1871.

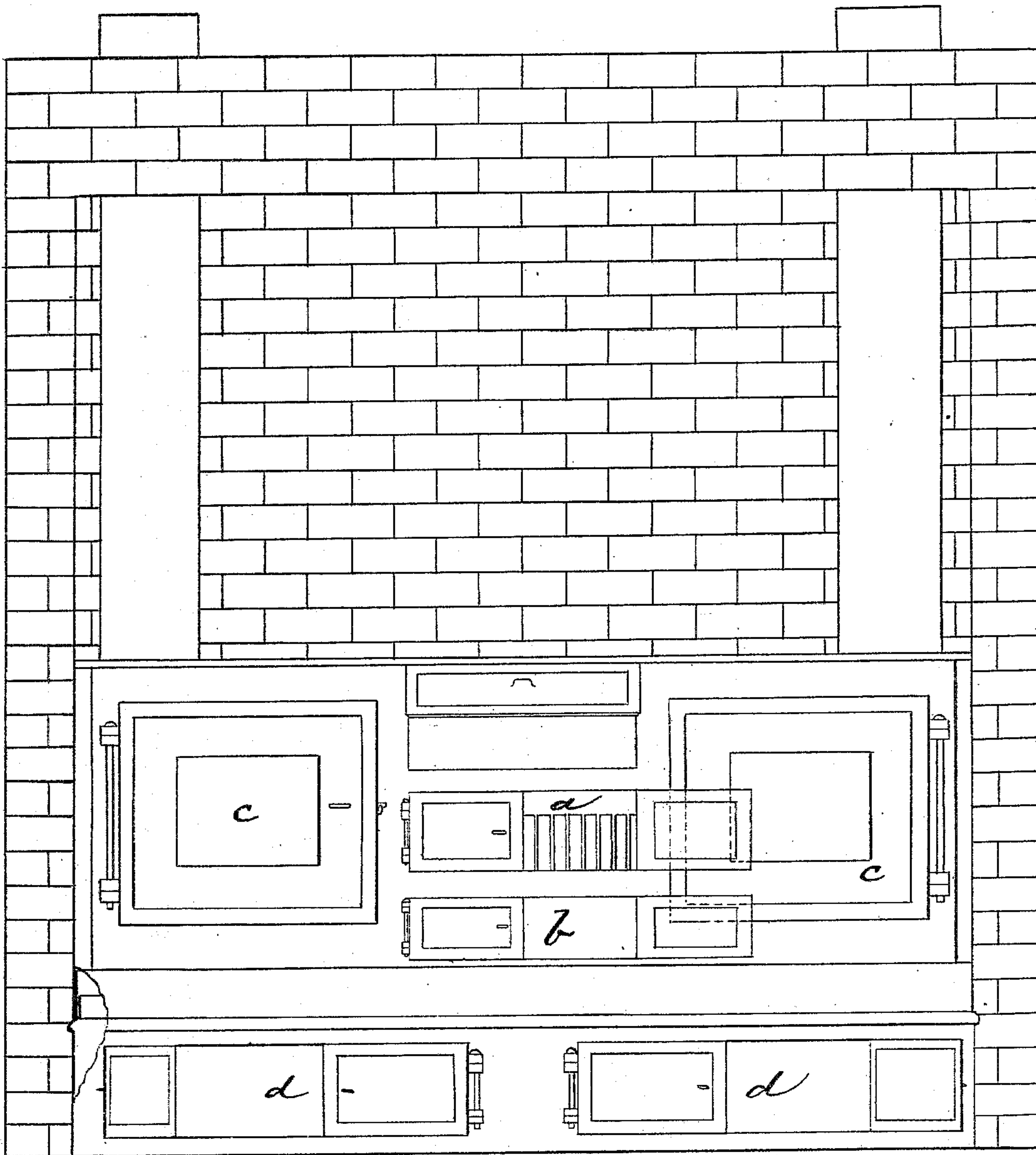

Witnesses
A. B. Maccomson
James H. Hunter

Inventor
Watson, Sanford

UNITED STATES PATENT OFFICE.

WATSON SANFORD, OF BROOKLYN, NEW YORK.

IMPROVEMENT IN FIRE-PLACE RANGES.

Specification forming part of Letters Patent No. 115,644 dated June 6, 1871.

To all whom it may concern:

Be it known that I, WATSON SANFORD, of the city of Brooklyn, county of Kings and State of New York, have invented a new and useful Improvement in Fire-Place Ranges; and I do hereby declare that the following is a clear and exact description of the same.

My improvement consists in the application, to a fire-place range, of a warming-closet, said closet being arranged beneath the base of the range.

In the accompanying drawing, *a* is the fire-place; *b*, the ash-pit; *c c*, the ovens for roasting or baking; and *d*, a closet for holding cooked food, dishes, &c., situated directly beneath the ovens, flues thereof, and ash-pit. This arrangement and location of warming-closet are superior to any other by reason of the heat being equalized therein by the joint action or effect of the flues of the main ovens

and the ash-pit. The cooked food, dishes, &c., desired to be kept warm can be very conveniently run into or out of such closet by reason of its forming the base of the range and being on a level with the hearth. The range is also, by such arrangement of warming-closet, elevated, and thereby rendered more convenient for cooking and baking operations.

This warming-closet may, if desired, be made in more than one compartment, and extend, more or less, beneath the base of the range.

What I claim as new is—

A warming-closet in a fire-place range, when said closet is arranged directly beneath the baking-ovens, flues, and ash-pit, and at the base of the range, substantially as described.

WATSON SANFORD.

Witnesses:

A. B. MALCOMSON, JR.,
JAMES H. HUNTER.