

## Green Corn Sheller.

No. 96,658.

Patented Nov. 9, 1869.

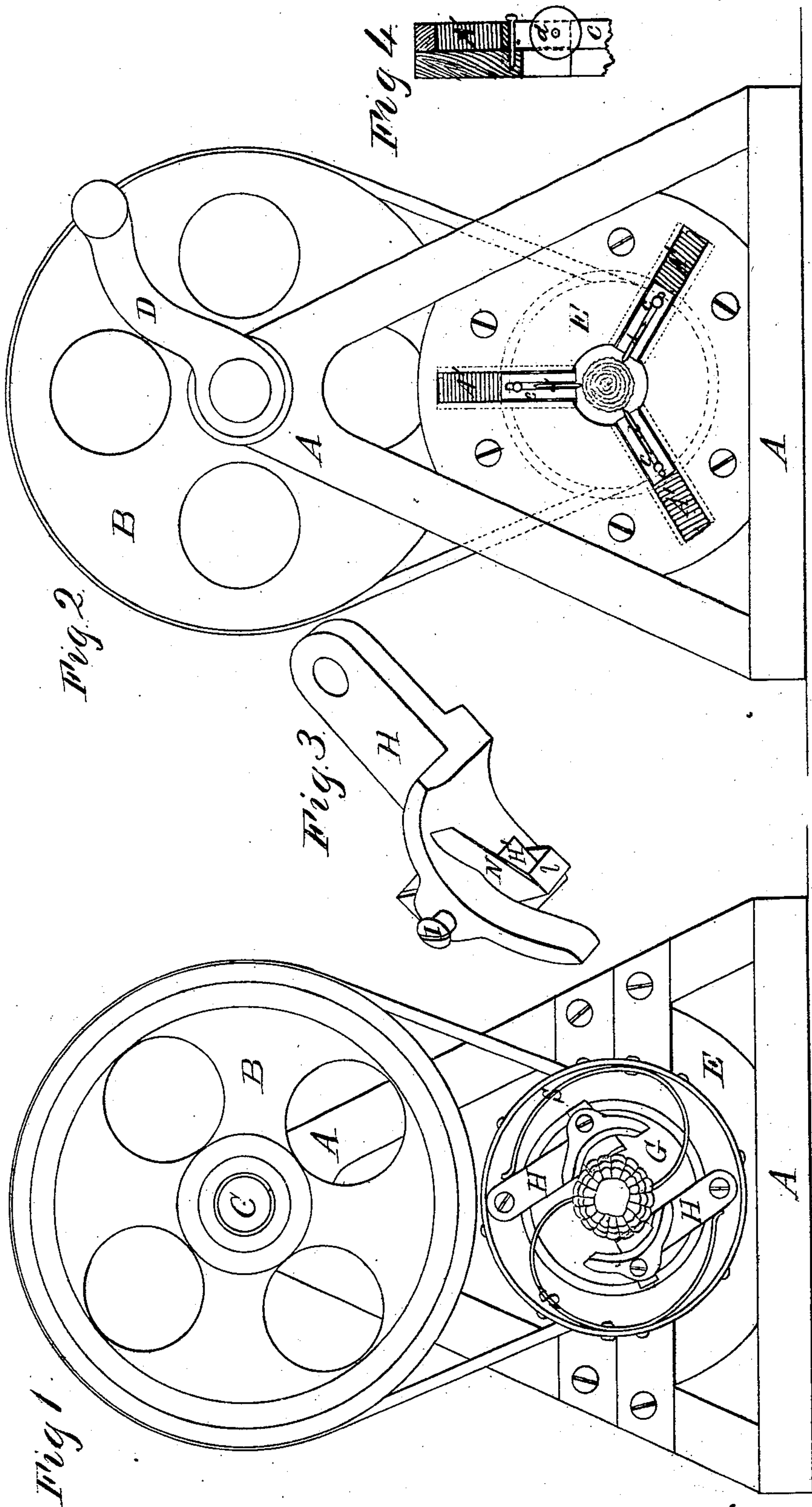

Witnesses;  
E W Anderson  
H. H. Kane

*Inventor;*  
*Volney Barker*  
*Chipman Hoosmer & Co*  
*Attorneys*



# United States Patent Office.

VOLNEY BARKER, OF OTISFIELD, MAINE.

Letters Patent No. 96,658, dated November 9, 1869.

## IMPROVED GREEN-CORN SHELLER.

The Schedule referred to in these Letters Patent and making part of the same.

*To all whom it may concern:*

Be it known that I, VOLNEY BARKER, of Otisfield, in the county of Cumberland, and State of Maine, have invented a new and valuable Improvement in Green-Corn Shellers; and I do hereby declare that the following is a full, clear, and exact description of the construction and operation of the same, reference being had to the annexed drawings, making a part of this specification, and to the letters and figures of reference marked thereon.

Figure 1 of the drawings is a front external view of my device;

Figure 2 is a rear external view; and

Figures 3 and 4 are details.

My invention relates to means for separating green corn from the cob; and

It consists, mainly, in a novel arrangement of devices intended to accomplish said result, in a more efficient and expeditious manner than has been possible by the green-corn shellers heretofore in use.

The letter A of the drawings represents a frame, usually consisting of a base-board and two upright posts, united at their tops, so as to form a triangle. But frames constructed in a different form may be used to advantage.

The letter B represents a band or belt-wheel, applied upon the shaft O; and letter D, a crank, connected with the opposite end of said shaft, in the manner shown.

In the triangle formed by the posts of the frame, and properly secured to the insides of said posts, and upon the base-board of the frame, I arrange the slotted block marked E on the drawings.

In the slots of this block, I arrange springs A' and the sliding blocks c, attached to said springs, respectively.

I also affix small wheel d in slots cut in blocks c, and arrange them to rotate therein.

The blocks c are dovetail in form, and fit and move back and forth in dovetailed slots in the block E.

The letter G represents a wheel, attached to the end of a shaft, which has its bearings in a cross-bar of the frame, and which is rotated by means of a band or belt-wheel in its rear, and by a band or belt connecting it with the wheel B.

The periphery of the wheel G consists of a metallic band or hoop, properly secured.

The letters H represent two swinging arms, pivoted to the wheel G, in the manner shown, and having enlarged and circular-shaped heads, adapted to receive the devices next mentioned.

The letter H' represents an adjustable block, arranged in a mortise in the head of arms H, and letter I, a set-screw, arranged for operating the same.

Around this block, and movable up or down therewith, is the knife l, made in the form of a staple, the knife or cutting-part being the lower transverse portion shown on fig. 3.

The letters N represent knives, set in a diagonal position upon the arms H, in the manner shown.

The letters S represent volute springs, arranged in the wheel G, in such manner, that while one end thereof serves as a spring to aid in the operations of arms H, their centres, respectively, rest against the inside of the band of the wheel, while their other ends, being sharpened, are passed over the heads of arms H, respectively, and serve as additional knives or cutters for the machine.

To operate my device, I turn the crank with my right hand, and, with my left, thrust the ear of corn between the knives N, the small end foremost. The corn passes between the knives and cutters above described, and the cob is passed out on the opposite side, between the wheels on the sliding blocks c.

By this process, both the kernels and the pulp on the cob are effectually removed.

The small wheels d d are employed to prevent the cob from turning, while they permit it to be forced along through by the feeding-knives N N.

I do not desire to confine myself to the use of the belt-wheel B and block E, sometimes preferring to attach the pulley of the wheel G to steam-shafting, using both hands to the corn-ear.

What I claim as my invention, and desire to secure by Letters Patent, is—

1. The adjustable knives l, in their connection with arms H, in combination with the springs and cutters S, when arranged within the disk G, substantially as shown and described.

2. The green-corn-cutting machine, as described, having frame A, crank D, driving-wheels B and O, and knives l and N, arms H, and springs S, in combination with the devices for holding the cob A', c, and d, arranged in holder E, as specified.

In testimony that I claim the above, I have hereunto subscribed my name, in the presence of two witnesses.

VOLNEY BARKER.

Witnesses:

S. D. ANDREWS,  
K. G. SCRIBNER.