

*O. D. Lombard,*

*Picker Strap*

*Nº 94,760.*

*Patented Sep. 14. 1869.*

*Fig. 1.*

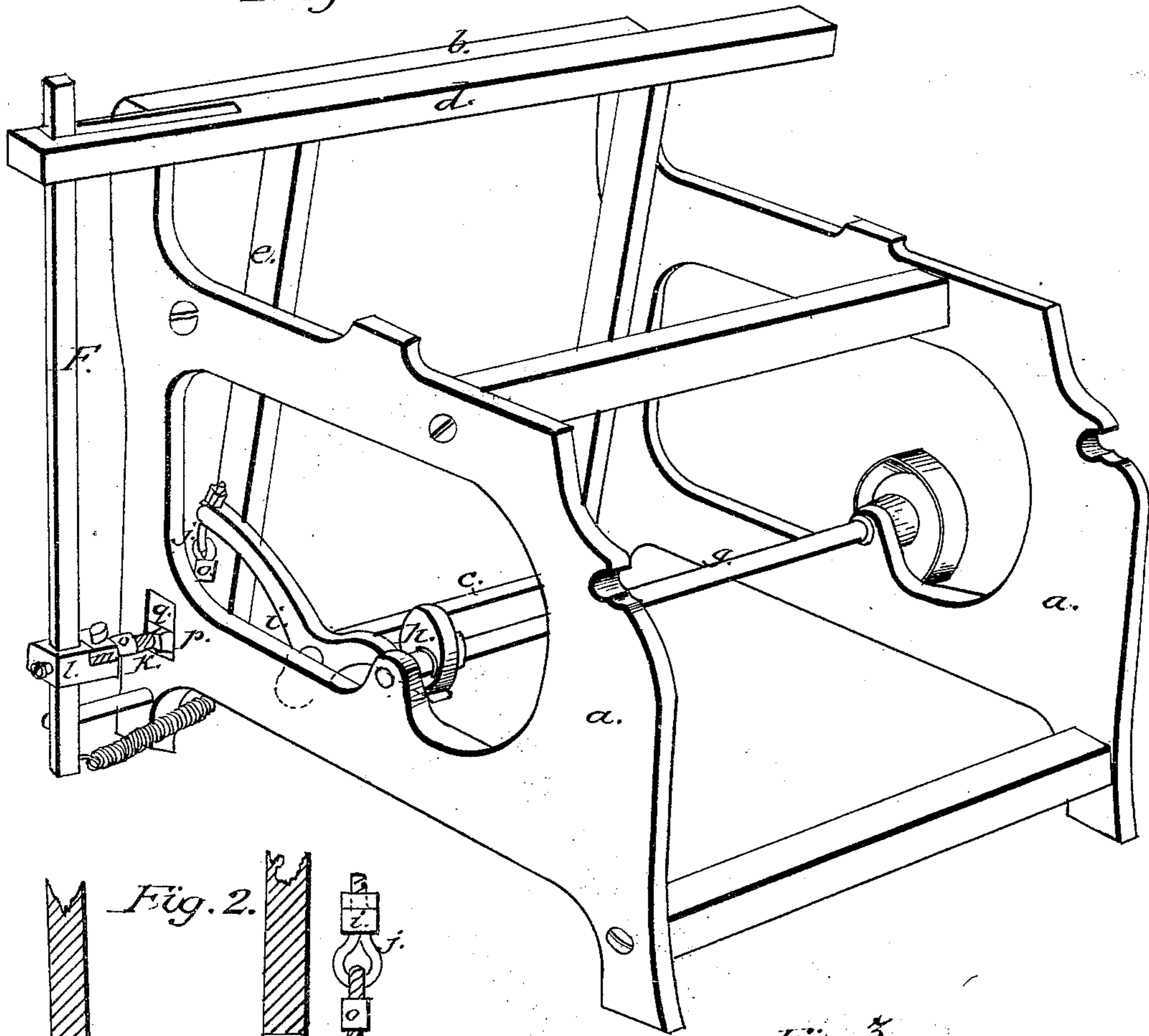

*Fig. 2.*

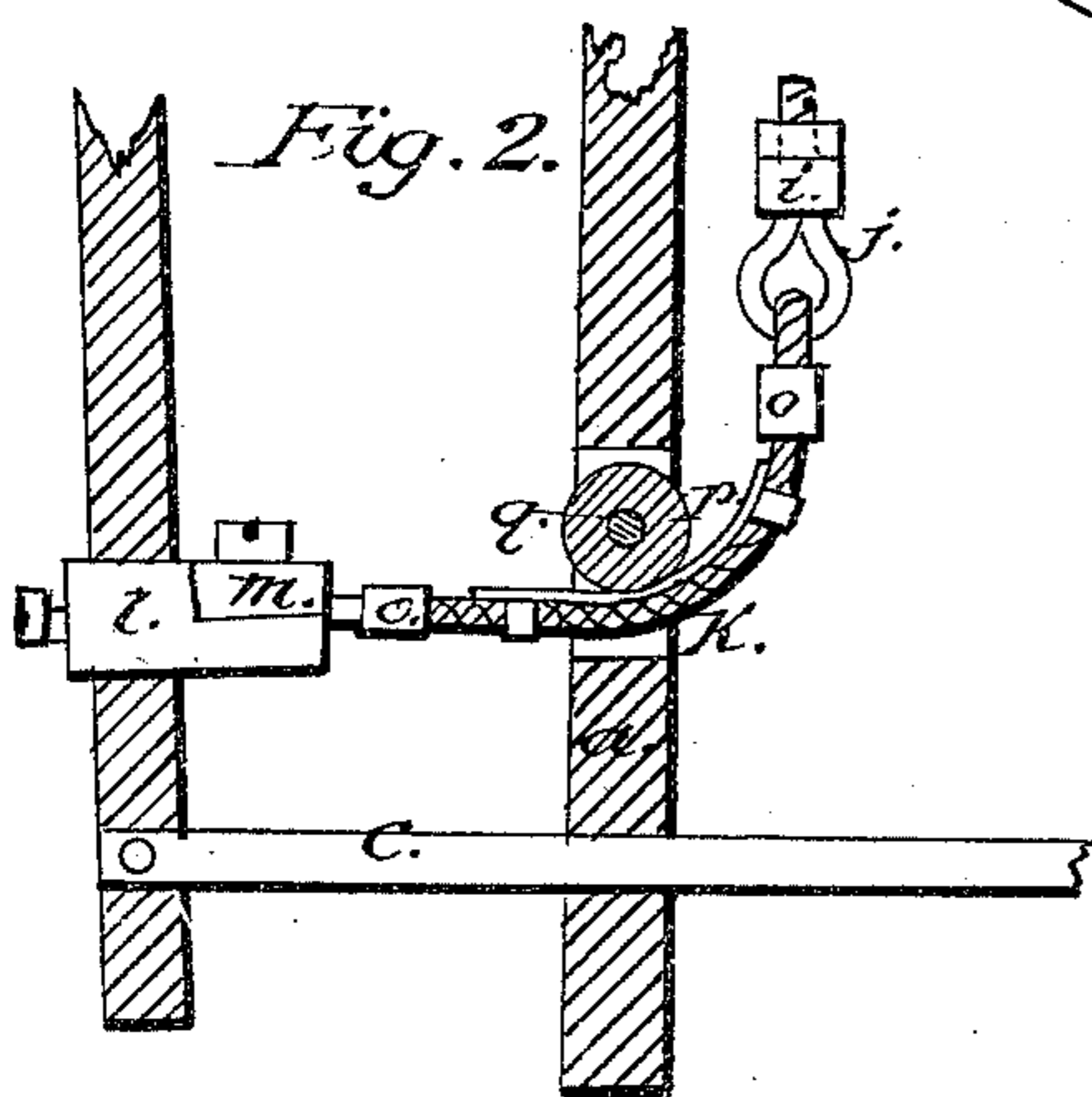

*Fig. 3.*

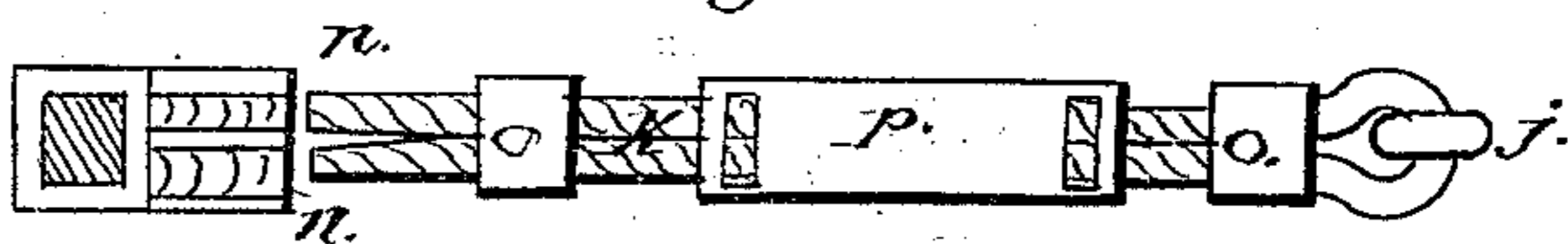

*Inventor*  
*Oliver D. Lombard*

*Witnesses;*  
*Geo. E. Perry.*

# United States Patent Office.

OLIVER D. LOMBARD, OF LOWELL, MASSACHUSETTS.

Letters Patent No. 94,760, dated September 14, 1869.

## IMPROVEMENT IN PICKING-MECHANISM FOR LOOMS.

The Schedule referred to in these Letters Patent and making part of the same.

*To all whom it may concern:*

Be it known that I, OLIVER D. LOMBARD, of Lowell, in the county of Middlesex, and State of Massachusetts, have invented new and useful Improvements in a Combination Picker-Strap for Looms; and I do hereby declare that the following is a full and exact description thereof, reference being had to the accompanying drawings, and to the letters of reference marked thereon.

The nature of my invention consists in the arrangement of the picker-strap, formed of cord, its working parts being covered or protected with leather, in combination with the fastenings by which it is secured to the picker-staff and lever.

To enable others skilled in the art to make and use my invention, I will proceed to describe its construction and operation.

Figure 1 represents a perspective view of the frame-part of the loom, with my improvements attached.

Figure 2 represents sectional parts of the loom, showing my improvements more clearly.

Figure 3 represents a plan of my improved device.

Similar letters in the different figures indicate corresponding parts.

In the construction of my improved device, *a a* represent the loom-sides, which are connected together by suitable girts and the breast-beam *b*.

Located near the bottom and front part of the frame is the lathe-shaft *c*, to which is secured the lathe *d*, by means of the swords *e e*.

The picker-levers *f* pass through the top of the lathe *d* at each end, and are pivoted, near the bottom, to the frame *a*.

*g* is the cam-shaft, which operates in bearings formed in the frame-sides *a a*.

Secured to this shaft *g* are the cams *h*, which operate the picker-levers *i*, said levers being pivoted to the inside of the frame *a a*.

Each of said levers is provided at its outer end with an eye-bolt, *j*, through which passes a suitable cord, *k*, which is then doubled, passed through the side frame, and connected to the adjustable slide *l*, by means of the cap *m*, provided with teeth, as shown in fig. 3 of the drawings.

The double cord *k* is provided with metallic clasps *o o*, which serve to keep the strands together, and with a leather cap or covering, *p*, which, when in use, protects the cord *k* from wearing at the point where the friction-roll *q* comes in contact with it.

### Operation.

Picker-straps heretofore commonly used become saturated, after a short time, with oil and dirt, and where they pass around the staff become worn and weak.

The cord *k*, in this my improvement, is secured to the picker-staff *f* and lever *i*, by means of the adjustable slide *l* and eye-bolt *j*, which prevent unnecessary wear at these points.

The cord *k* being double, and the strands secured together by means of the clamps or clasps *o o*, give it double strength.

And also the cord *k*, being provided with and protected at the point where the most wear comes on the same, by means of the leather cap *p*, serves to protect and keep the rope *k* perfectly clean.

What I claim as my invention, and desire to secure by Letters Patent, is—

The combination, with the picking-lever and staff, of the cord *k*, cap *p*, slide *l*, toothed cap *m*, and eye-bolt *j*, all constructed, arranged, and operating as described.

OLIVER D. LOMBARD.

Witnesses:

P. T. RAWSON,  
GEO. E. PEVEY.