

WASHING MACHINE

Levi S. Enos.

PATENTED

FEB 25 1868

74902

Fig. 1

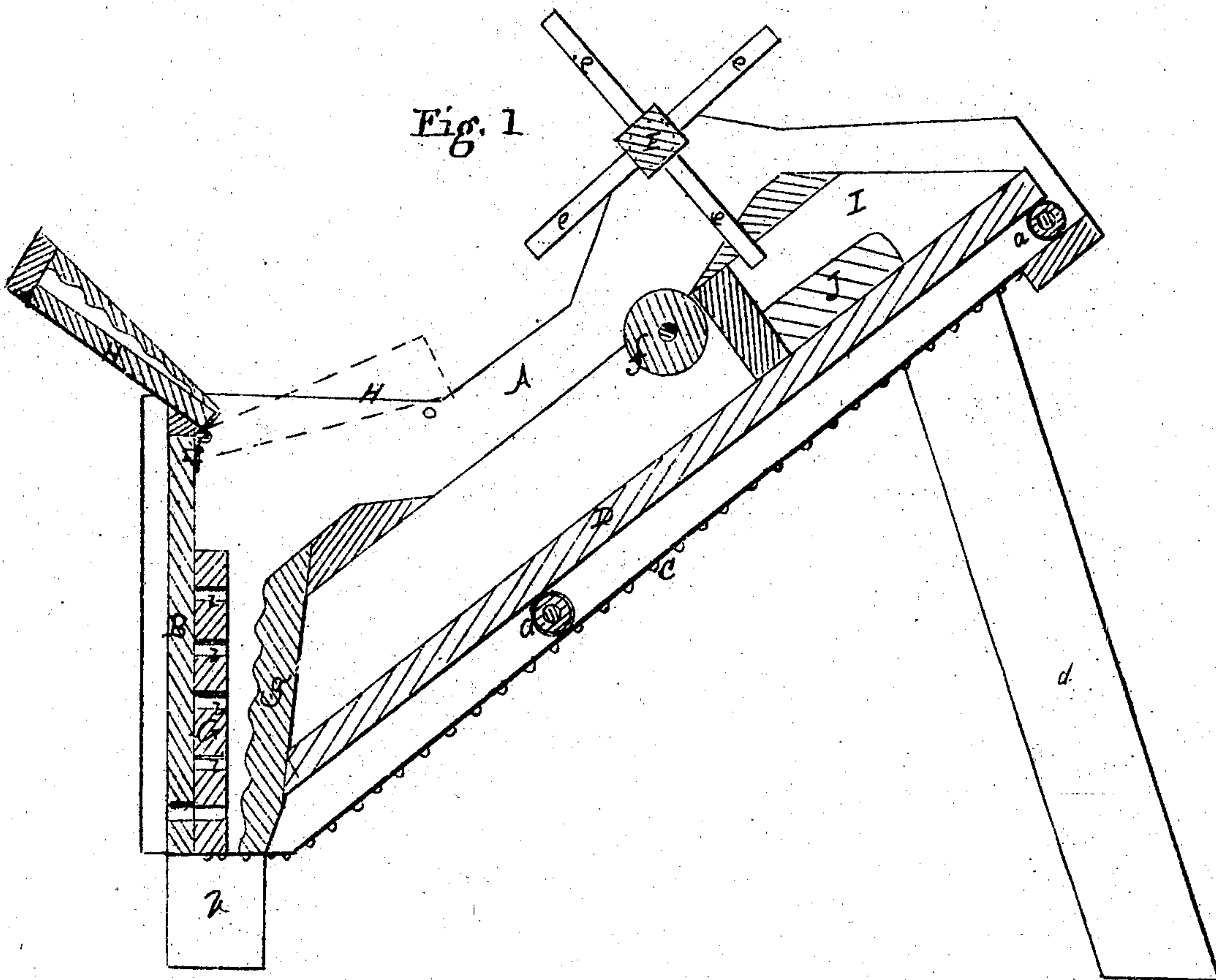
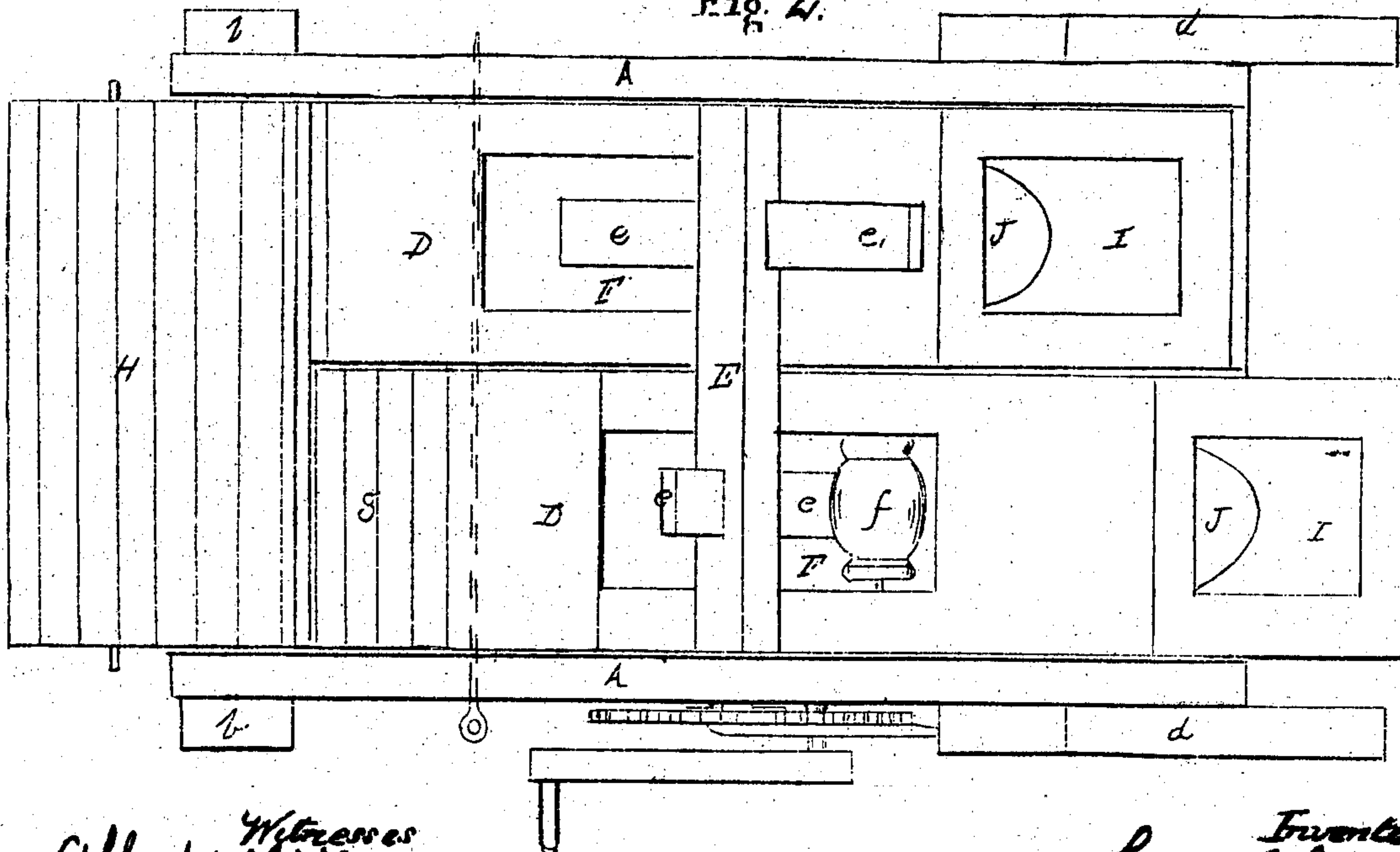

Fig. 2.



Witnesses
Alfred Hill
Geo. C. Green

Inventor
Levi S. Enos
Attorney J. B. Woodruff

United States Patent Office.

LEVI S. ENOS, OF ALMOND, NEW YORK.

Letters Patent No. 74,902, dated February 25, 1868.

IMPROVED WASHING-MACHINE.

The Schedule referred to in these Letters Patent and making part of the same.

TO ALL WHOM IT MAY CONCERN:

Be it known that I, LEVI S. ENOS, of the town of Almond, in the county of Allegany, in the State of New York, have invented certain new and useful Improvements in Washing-Machines; and the following is a full, clear, and exact description of the same, reference being had to the accompanying drawings, making a part of this specification, in which—

Figure 1 represents a section, through a side elevation, of the working parts of the machine.

Figure 2 shows a plan or top view of the wash-board and beaters, and mode of operating them.

The object of my invention is the production of a good practical and efficient washing-machine; and it consists in the construction of the washing or suds-box; the construction of the beaters so that they may be weighted, the same working on friction-rollers, so as to operate easily; and the arrangement of mechanism for working the beaters; the corrugated hinged cover or hand-washing board, for soaping and partly washing the more soiled portions of garments.

To enable others to make and use my invention, I will describe it more fully, referring to the drawings, and to the letters marked thereon.

The frames which form the sides of the suds-box A A, are made of boards, cut in the proper form, so that the end-board B when fitted in, is in a vertical position. The bottom, C, may be of sheet zinc, galvanized iron, or any other suitable material, so secured to the end-board B and the sides A A, that the washing-box will not become leaky when it is dry; the box being supported on legs *b b* at the lower end, and long bracing legs *d d* at the upper end, so that the bottom, C, is at an incline of about forty-five degrees. Inside of the box, placed near the bottom, C, are friction-rollers *a a*, on which the under sides of the pounders D D rest, so that they are moved very easily by the action of the lifting-arms *e e*, in the rotating-shaft E, which works in the openings F F against the friction-rollers *f f*, to alternately lift the pounders D D; the lower ends *g g* being grooved or corrugated in the form of a common wash-board, where they come in contact with the clothes, and press or pound them against a stationary board, G, having several series of holes *i i i i* in it. Above the place where the pounders D D operate on the clothes, there is hinged a lid or cover, H, the under side, when closed, being corrugated in the manner of the common wash-board, which prevents any slopping over of the suds, and the raising up of the clothes, by the action of the pounders, when the machine is in operation. When the lid H is opened, and rests back on the end-board B, it is in the position for use as a wash-board, for soaping and rubbing out the most soiled portions of clothes, such as collars, wristbands, &c., by hand in the usual manner. In the top ends of the pounders D D are boxes I I, in which to place weights J J, so that any desired force may be brought to bear on the clothes, to pound and compress them between the pounder-faces *g g* and the board G. The machine may be geared and operated by a crank, either by hand or other power.

What I claim as my invention, and desire to secure by Letters Patent, is—

The pounders D D, as constructed and arranged, for receiving weights J J in combination with the friction-rollers *a a*, vertical stationary board G having series of holes *i i i i*, and corrugated hinged lid or cover H, substantially as and for the purposes herein set forth.

In testimony whereof, I hereunto subscribe my name in the presence of—

LEVI S. ENOS.

Witnesses:

SIMEON WAGNER,

CHARLES A. STRAIGHT.