

Johnson R. Pierson's Safe Door Bolt.

71410

Fig: 1

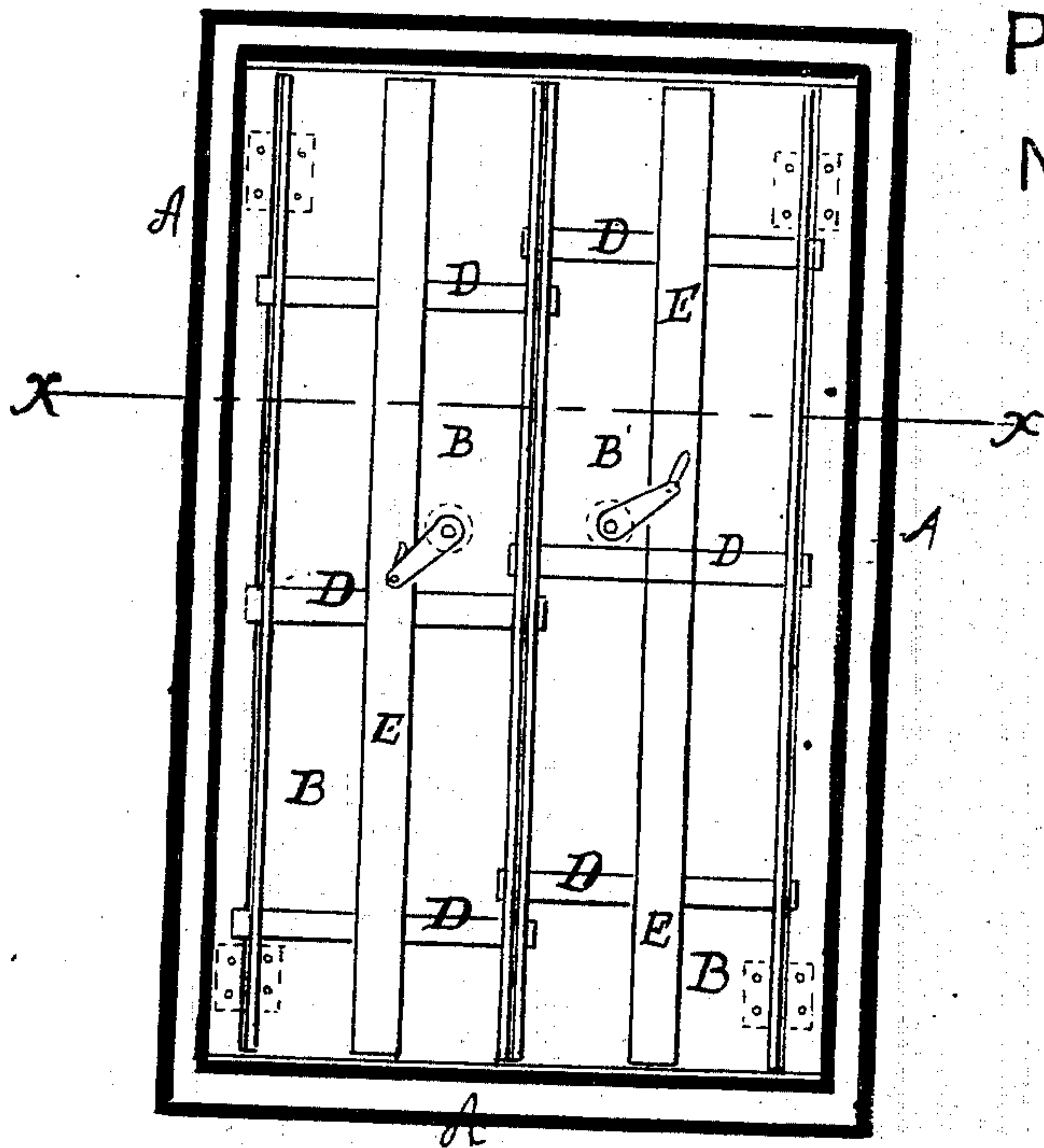

PATENTED
NOV 26 1867

Fig: 2.

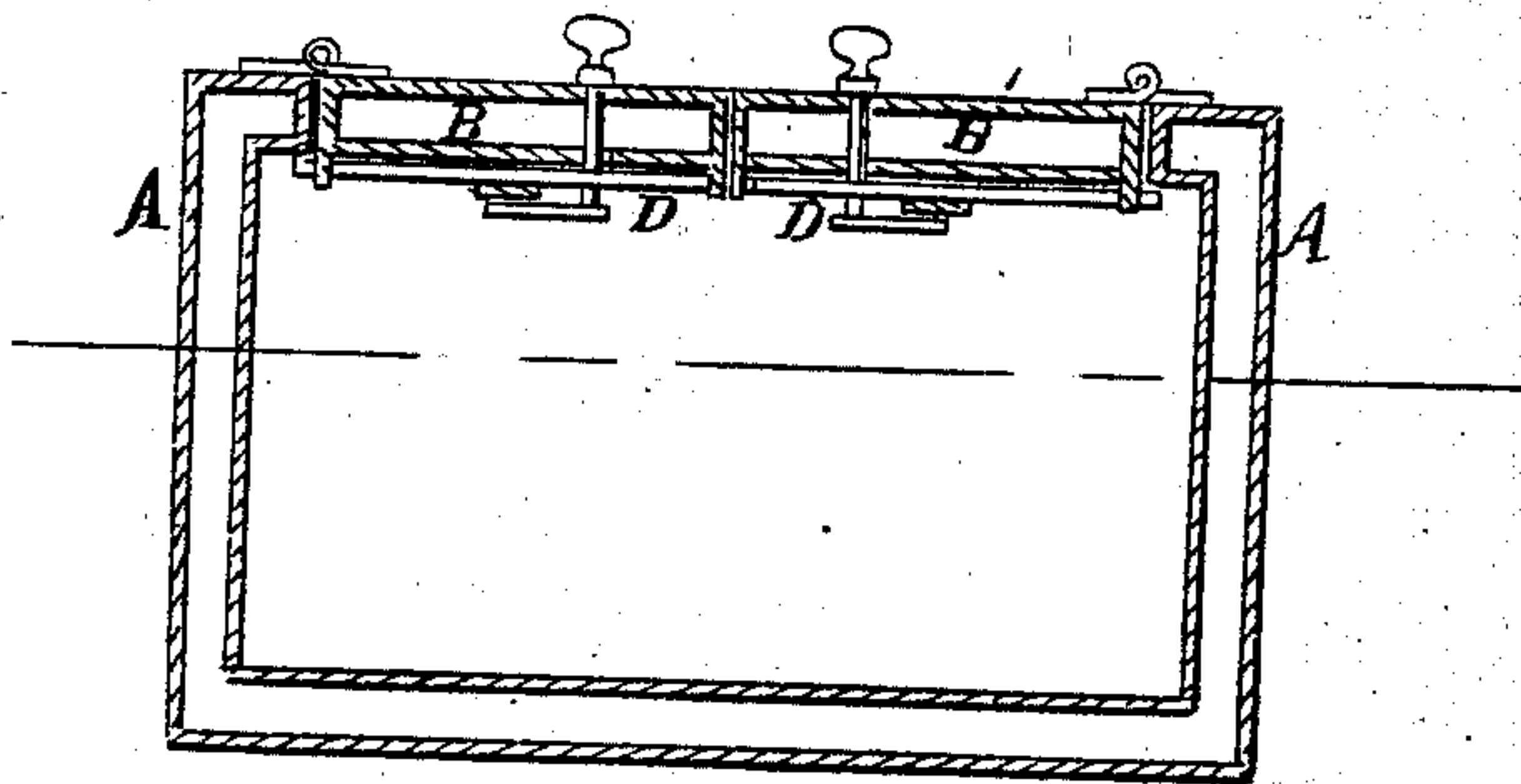

Witnesses,
Thos. Insehe
Wm. Truwin

Inventor.
J. R. Pierson
Per Heunich
Attorney

United States Patent Office.

JOHN R. PIERSON, OF NEWARK, NEW JERSEY.

Letters Patent No. 71,410, dated November 26, 1867.

IMPROVEMENT IN SAFE-DOOR BOLTS.

The Schedule referred to in these Letters Patent and making part of the same.

TO ALL WHOM IT MAY CONCERN:

Be it known that I, JOHN R. PIERSON, of Newark, in the county of Essex, and State of New Jersey, have invented an improved Safe-Door Bolt; and I do hereby declare that the following is a full, clear, and exact description thereof, which will enable others skilled in the art to make and use the same, reference being had to the accompanying drawings, forming part of this specification.

Figure 1 represents an inside elevation of safe-doors provided with my improved bolts.

Figure 2 is a horizontal sectional view of the same, the plane of section being indicated by the line *xx*, fig. 1. Similar letters of reference indicate corresponding parts.

This invention relates to a new manner of locking safe-doors so that the same cannot be opened by the insertion of wedges or by blasting, but only when all the bolts are withdrawn.

The invention consists in the arrangement, in safes having two doors, of two or more horizontal bolts in each door, which are connected so as to be operated from the lock, each bolt extending entirely across the whole door, so as to lock into the other door and into the casing on the side of the hinges.

A represents the casing of the safe; B and B are the doors, hinged to the casing in the ordinary manner by suitable hinges. D D are two or more horizontal bolts arranged on the inner side of each door, and connected by an upright bar, E, or otherwise, so that all the bolts on each door can be locked at the same time from the lock, as is indicated in fig. 1. The bolts are longer than the door, so that they project from both ends of the same into the other door and into the casing, as shown in fig. 1. When both doors are thus locked, it will be impossible to open them by a wedge or by blasting, and both doors are still firmly locked as long as one single bolt holds. When the doors are to be opened the bolts must be drawn out of the opposite door into or behind the casing. They will then be out of the way, and will not prevent the doors from being opened.

I claim as new, and desire to secure by Letters Patent—

Arranging the bolts in safes having double doors so that they extend across the door, and can be locked at once into the opposite door and into the casing, two or more bolts being provided in each door, and operated at once from the lock, substantially as and for the purpose herein shown and described.

JOHN R. PIERSON.

Witnesses:

WM. F. McNAMARA,
C. L. TOPLIFF.