

F. B. FANCHER.

Garden-Tile.

No. 68,971.

Patented Sept. 17, 1867.

Fig 1

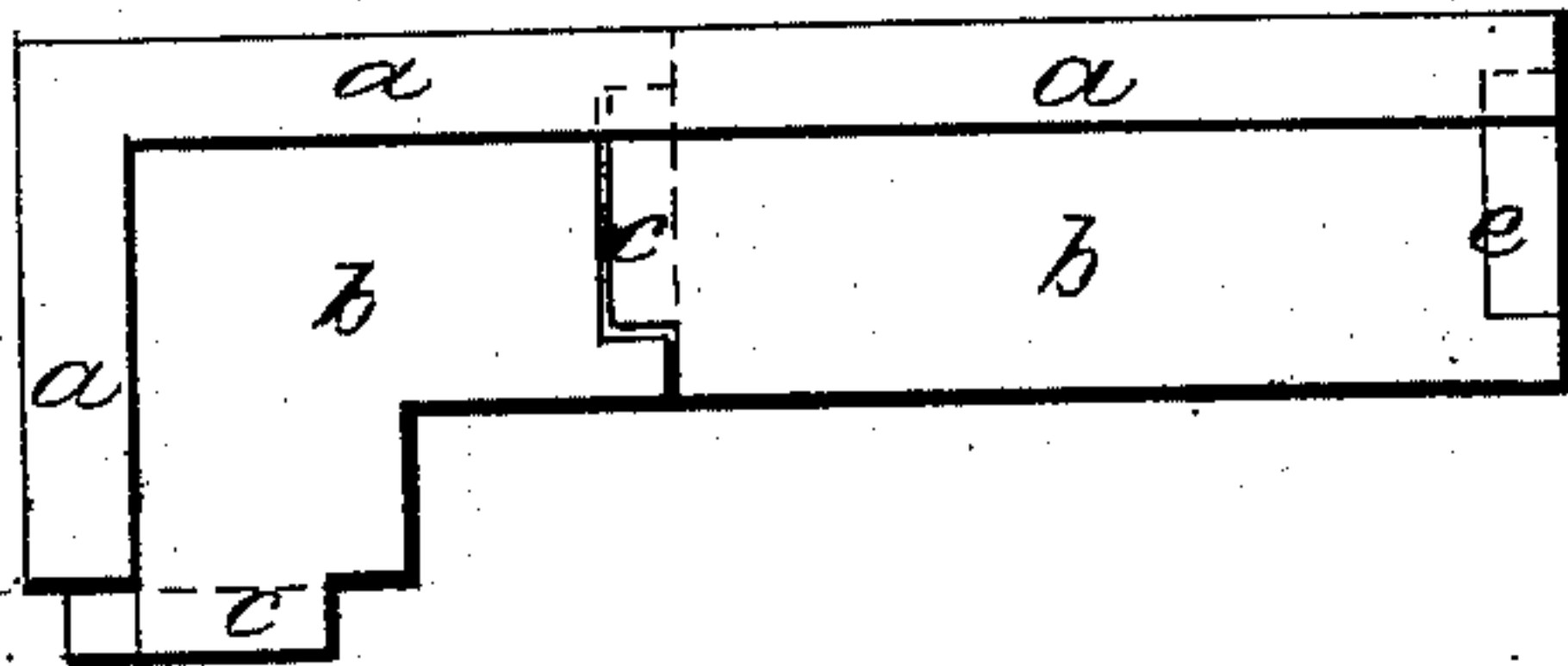

Fig 2

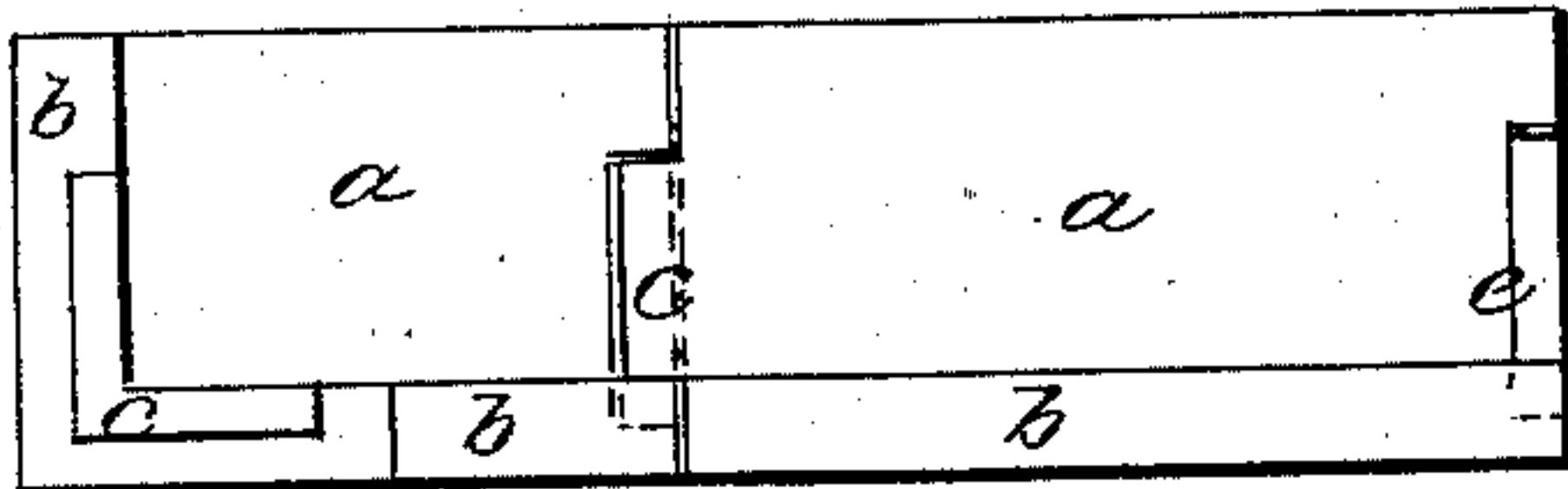

Fig 3

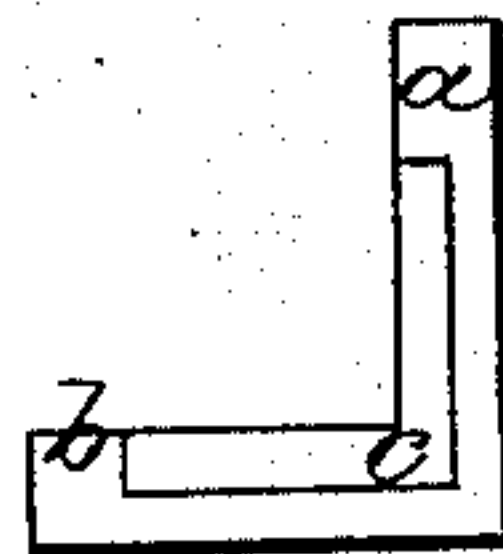

Fig 4

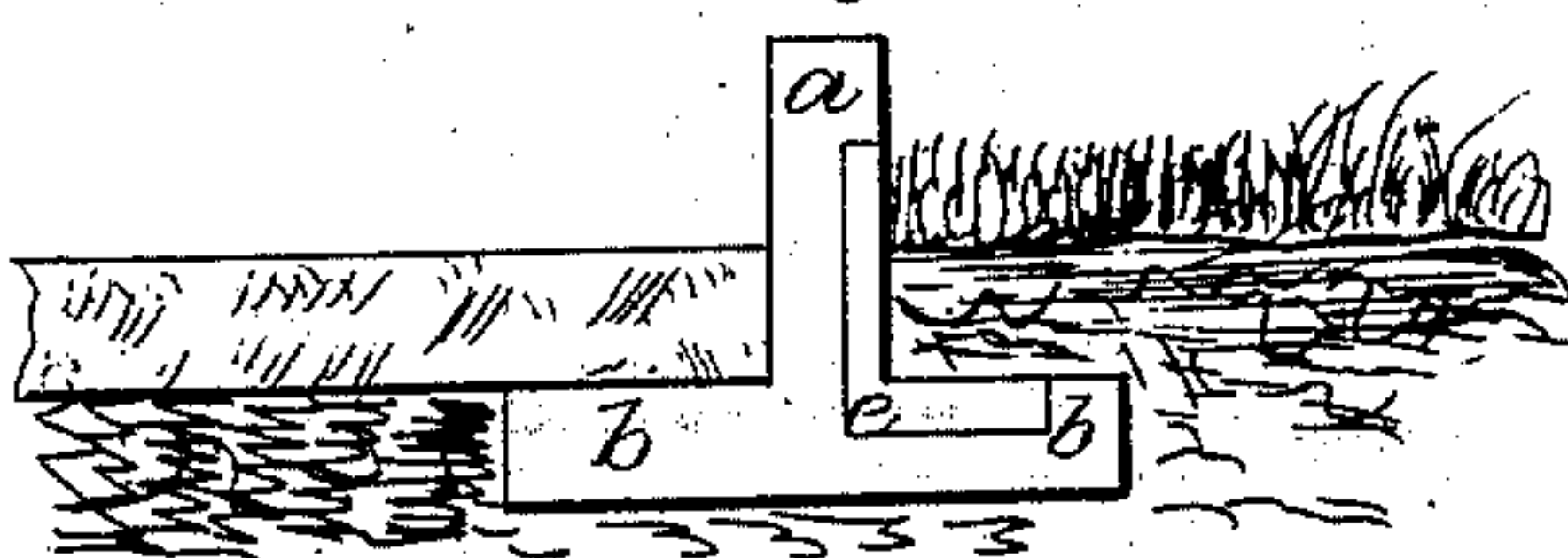
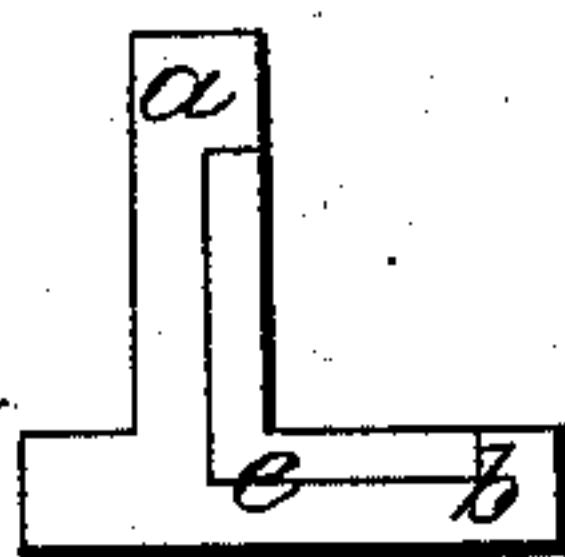

Fig 5



Witnesses:
Thos. G. Busche
Wm. F. Frewin

Inventor
F. B. Fancher
Per Munnell & Co
Attorneys

United States Patent Office.

FRANCIS B. FANCHER, OF LANSINGBURGH, NEW YORK.

Letters Patent No. 68,971, dated September 17, 1867.

IMPROVEMENT IN GARDEN-TILE FOR BORDERING.

The Schedule referred to in these Letters Patent and making part of the same.

TO ALL WHOM IT MAY CONCERN:

Be it known that I, FRANCIS B. FANCHER, of Lansingburgh, in the county of Rensselaer, and State of New York, have invented a new and improved Garden-Tile for Bordering; and I do hereby declare that the following is a full, clear, and exact description thereof, which will enable others skilled in the art to make and use the same, reference being had to the accompanying drawings, forming part of this specification, in which—

Figure 1 is a top view of two sections of my improved garden-tile connected at a corner.

Figure 2, a side view of the same.

Figure 3, an end view of the same.

Figure 4, a modification showing the method of employing my improved garden-tile for the borders of walks and flower-beds, &c.

Figure 5, a modification of the same.

Similar letters of reference indicate like parts.

This invention relates to an improvement in the construction of tiles for the edges of walks, flower-beds, and grass-plots in gardens and other ornamental grounds, and consists in forming the tile with a right-angled wing or wings on one or both sides, and locking the tiles together with lap-joints or tongue and groove in such a manner that they may be set in the ground with one edge projecting above the surface to divide a flower-bed or grass-plot from a walk, or to enclose a border on both sides. The tile is set in a firm and permanent position, in which it is held by a wing or wings lying horizontally under the flagging of a walk or the surface of the ground deep enough to give a good foundation. These tile can be made in various shapes so as to be put together and form circles, ovals, or curves and angles of any kind that may be desired. They may be made of baked clay, cast iron, or other suitable material, and will form a neat, cheap, and permanent self-supporting border or edging in gardens or other ornamental grounds.

The tiles are made in sections twelve or more inches in length, and five or more inches in depth, and as thick as will give requisite strength, and the top edges may be straight, rounded, or scalloped, according to fancy. The side *a* and the bottom wing *b* set at right angles to each other, and are connected by tongue and groove at their ends, or by a lap, *c*, on the end of one section fitting in a corresponding recess, *c*, in the end of another section, as shown in the drawings. The lap *c* joint is made in the side *a*, which is placed vertically, and also in the ring *w*, which is buried under the surface of the ground in a bed or the flagging of a walk, as shown in fig. 4. The tile may be formed with one wing on one side or with two wings projecting on both sides, as shown in the drawings.

By this construction and arrangement of the tile they have a firm bottom or foundation on the wings, which prevent them from settling, and the lap-joints hold them in line, so that they will retain their position on the border of a walk or flower-bed permanently.

Having described my invention, I claim as new, and desire to secure by Letters Patent—

Constructing garden-tile for borders with right-angled wings united by lap-joints or tongue and groove, substantially as and for the purpose herein shown and described.

FRANCIS B. FANCHER.

Witnesses:

EUGENE HYATT,
TRAVIS RANSOM.