

W. B. BURWELL.

Refrigerator.

No. 66,674

Patented July 16, 1867.

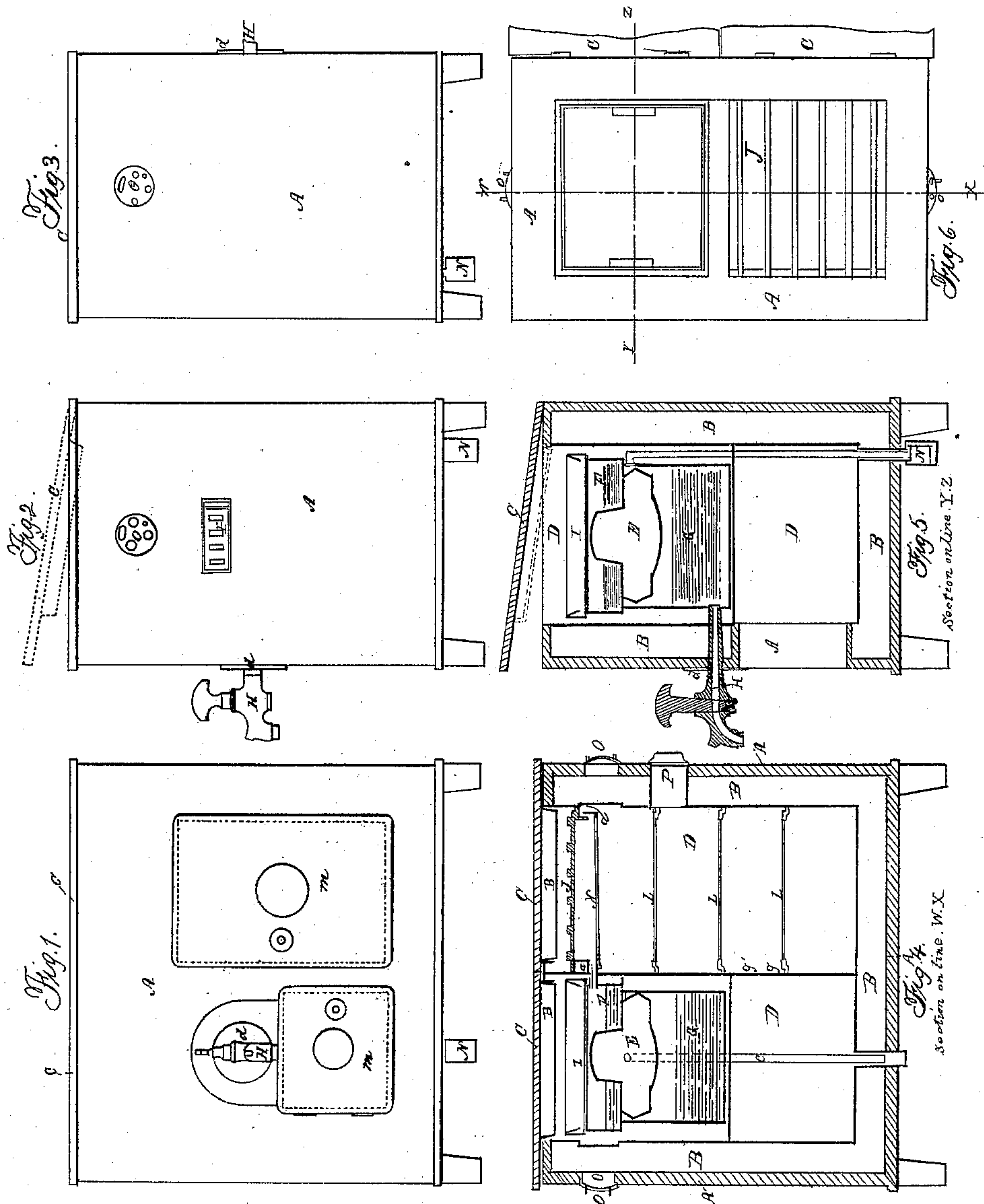

Witnesses.
E. Burtlett.

Inventor
W. B. Burwell

United States Patent Office.

WILLIAM B. BURWELL, OF CHICAGO, ILLINOIS.

Letters Patent No. 66,674, dated July 16, 1867.

IMPROVED REFRIGERATOR, COOLER, AND FILTER.

The Schedule referred to in these Letters Patent and making part of the same.

TO ALL WHOM IT MAY CONCERN:

Be it known that I, WILLIAM B. BURWELL, of the city of Chicago, in the county of Cook, and State of Illinois, have invented certain new and useful Improvements in Refrigerators, Filters, and Water-Coolers; and I do hereby declare that the following is a full, clear, and exact description thereof, reference being had to the accompanying drawings, making a part of this specification, in which—

Figure 1 is a front elevation.

Figure 2 an end elevation.

Figure 3 an end elevation of opposite end.

Figure 4, a longitudinal vertical section.

Figure 5, a transverse vertical section; and

Figure 6, a top view with lids open.

Like letters refer to the same parts in all of the figures.

The nature and object of my invention consist in providing the filling of a refrigerator with ventilation, so as to prevent its moulding and its secreting an odor which permeates the contents and in time becomes offensive; in providing the draw-cock with an adjustable collar; and in the combinations hereinafter claimed as new.

To enable others skilled in the art to make and use my invention, I will describe its construction and operation. It will be obvious that as refrigerators are made of a variety of sizes and styles of finish, no directions as to dimensions and manner of putting together will need to be given.

The outer case or frame A is made of wood, and the inner case or lining D of zinc, tin, or other suitable material, and the space B between them filled with pulverized charcoal. K is the bottom of the ice-chamber, and should be made of some suitable metal. J is a rack of wood on which the ice is to be placed, and the rack can be placed on or near the bottom of the ice-chamber. *a a* are air-passages from the ice-chamber to the cooling-chamber below. L are racks in the cooling-chamber, to be used as shelves, *b* is a passage through which water from the ice-chamber passes into the filter F. E is filtering material arranged in any convenient manner. G is a reservoir for holding filtered water, below which is another cooling-chamber, communicating with the larger chamber by means of the air-passages *g*. *c* is a tube through which the surplus water from the filter passes. On the end of the tube is the cap N, which being filled with water prevents air-currents into the filter. P is a ventilator for the cooling-chamber, and may be closed by a register. At each end of my refrigerator, and at O, I place openings into the filling for the purpose of ventilating the same. By this means the filling is prevented from moulding, and free from all offensive odors. These openings may be protected by a wire gauze, or may be closed by means of a register, as shown in the drawing. C C are covers, and M M are doors arranged and made in the ordinary manner. I is a shallow cooling-pan placed over the filter. Water is drawn from the reservoir G for use by means of the cock H. *d* is a metal collar plate, provided with a central hole, which hole has a screw-thread fitting a like thread on the cock. When the cock has been placed in proper position it can be firmly secured and held in its place by screwing the plate *d* firmly against the side of the refrigerator, and the cock will be firmly secured even though the hole through the side of the refrigerator be somewhat larger than the cock, and by using this plate or collar *d*, as aforesaid, less care is required in fitting the opening through the case of the refrigerator through which the cock passes. It is not supposed that for family use the drippings from the ice will furnish sufficient water. Such quantity as may be desired can be put into the filter F. In ordinary sizes the filter will occupy only about one-third of the length of the refrigerator, instead of one-half, as shown in the drawing.

Economy in construction and use may be mentioned as one of the advantages of my refrigerator and filter over others, as the same can be constructed more cheaply than a refrigerator and filter separately, and the ice used is made to answer a double purpose.

Having fully described my invention, what I claim as new, and desire to secure by Letters Patent, is—

1. One or more ventilators O, for ventilating the filling of a refrigerator without communicating with the interior, substantially as and for the purposes specified.

2. In combination with the ventilators O I claim the arrangement of the ice-box K in one compartment, and the dripping-pan F, filter E, and reservoir G, provided with a draw-cock H in the other compartment, substantially as specified.

Witnesses:

E. A. WEST,

IRA BARTLETT.

W. B. BURWELL.