

W. C. Marshall,

Shutter Fastener

N<sup>o</sup> 62,656.

Patented Mar. 5, 1867.

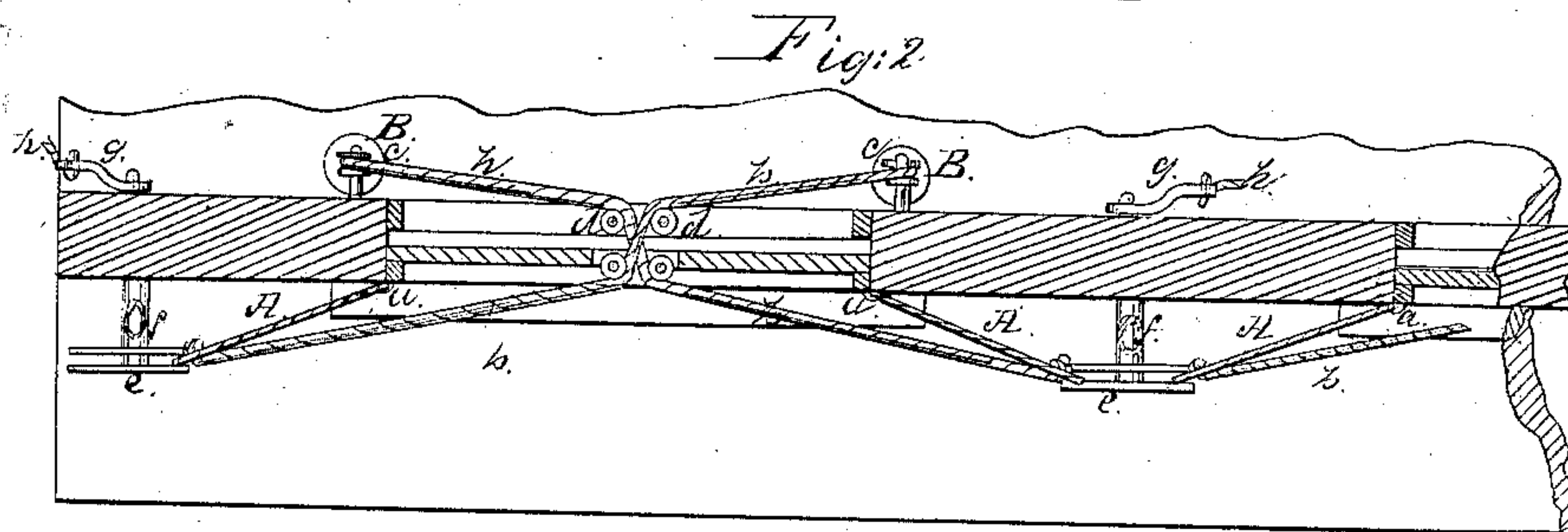
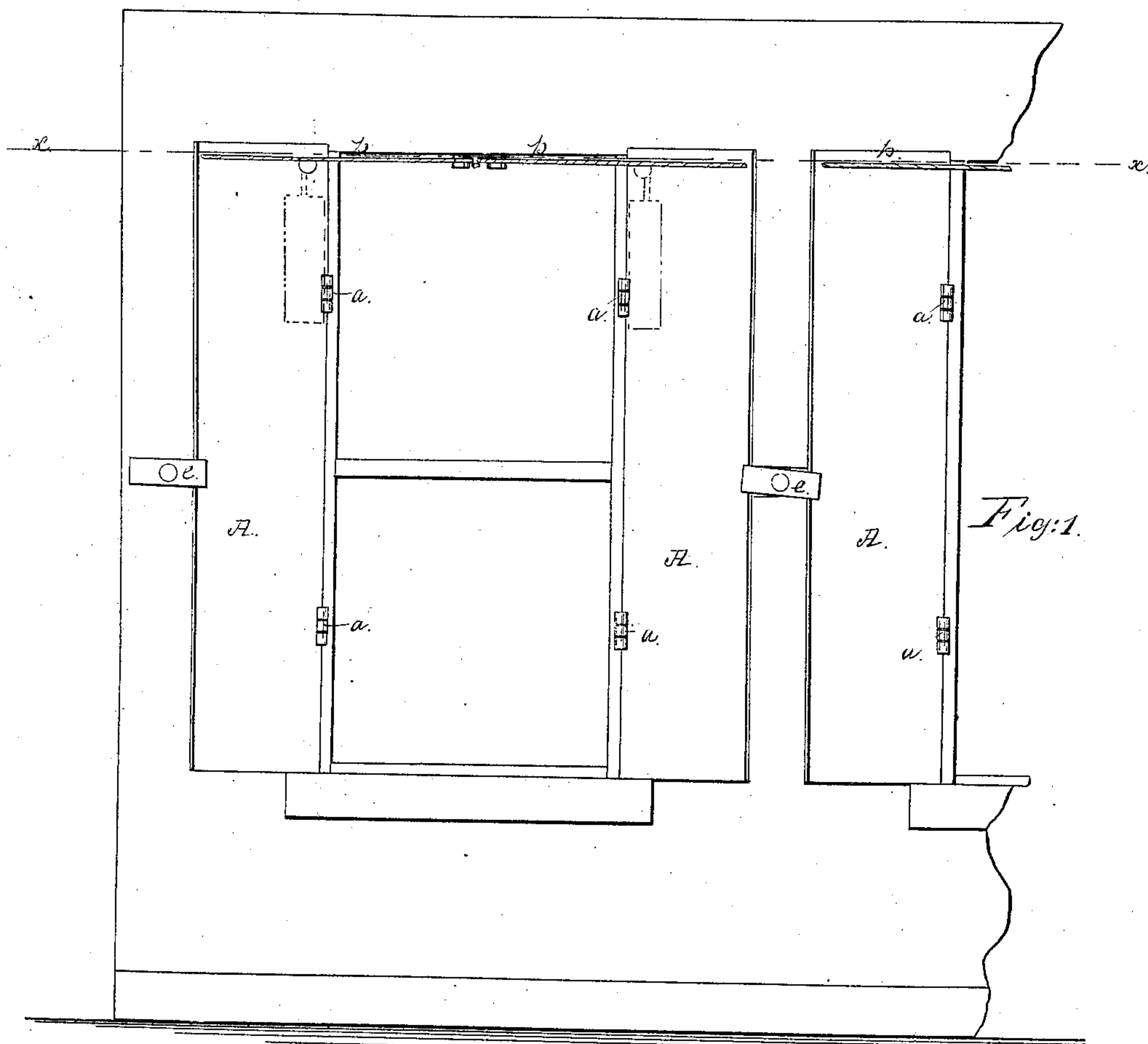

Witnesses:

Alex H. Roberts

Jos B. Langford

Inventor  
W. C. Marshall  
Per *[Signature]*  
Attorney

# United States Patent Office.

W. C. MARSHALL, OF NEW YORK, N. Y.

*Letters Patent No. 62,656, dated March 5, 1867.*

## IMPROVEMENT IN BLIND-FASTENINGS.

The Schedule referred to in these Letters Patent and making part of the same.

### TO ALL WHOM IT MAY CONCERN:

Be it known that I, W. C. MARSHALL, of the city, county, and State of New York, have invented a new and improved Self-Closing Attachment to Doors and Shutters; and I do hereby declare that the following is a full, clear, and exact description thereof, which will enable others skilled in the art to make and use the same, reference being had to the accompanying drawings, forming part of this specification, in which—

Figure 1 represents an outside elevation of a portion of a building provided with my self-closing attachment.

Figure 2 is a horizontal section of the same, taken in the plane indicated by the line *x x*, fig. 1.

Similar letters of reference indicate like parts.

This invention is intended to render a building fire-proof, for which purpose it is found necessary to exclude the external air. In ordinary buildings, provided they are furnished with shutters, no means are at hand to close said shutters and the doors except the ordinary hinges and hasps, which cannot be operated when the building is on fire. My invention consists in providing a self-closing shutter or door, which is held open by a suitable fastening connecting with a wire or rod which terminates outside the building, or at some point easily reached in case of fire, in such a manner that by moving said rod or wire the fastenings of the doors or shutters are relieved, and said doors or shutters are brought under the action of weights or springs, causing them to close automatically, so as to exclude the air.

A represents a shutter, which is hung on hinges, *a*, and subjected to the action of a weight, B, which is suspended from a cord, *b*, that runs over rollers, *c d*, (see fig. 1,) and connects with the shutter near its outer edge. Instead of this weight a spring or springs may be used to close the shutter, or springs and weights may be applied in conjunction. The shutter, instead of being hung on hinges, may be made to slide on bars; and the same devices are applicable to doors, whether the same are hung on hinges or made to slide back and forth. The shutter A is held open by a swivel button, *e*, which is secured to a rod, *f*, extending through the wall of the building, as shown. To the inside end of this rod is secured an arm, *g*, from which is suspended a rod or wire, *h*. By pulling this rod or wire the button is made to turn, and the shutter is relieved, so that the same is free to follow the action of the weights or springs, and to close automatically. Instead of the swivel button *e* any other suitable fastening may be applied. The rods or wires *h* of the several shutters in a building will be so arranged that the same can be conveniently reached from an easily accessible spot inside or outside the building, so that in case of a fire, by pulling said rods or wires all the doors and shutters can be closed at a moment's notice, and by excluding the air the fire is smothered.

What I claim as new, and desire to secure by Letters Patent, is—

The latch *e* and releasing lever *g*, in combination with the self-closing shutter A, constructed and operating substantially as and for the purpose described.

The above specification of my invention signed by me this      day of May, 1866.

W. C. MARSHALL.

Witnesses:

WM. F. McNAMARA,

W. HAUFF.