

W. P. GOOLMAN.

Straw Cutter.

No. 44,042.

Patented Aug. 30, 1864.

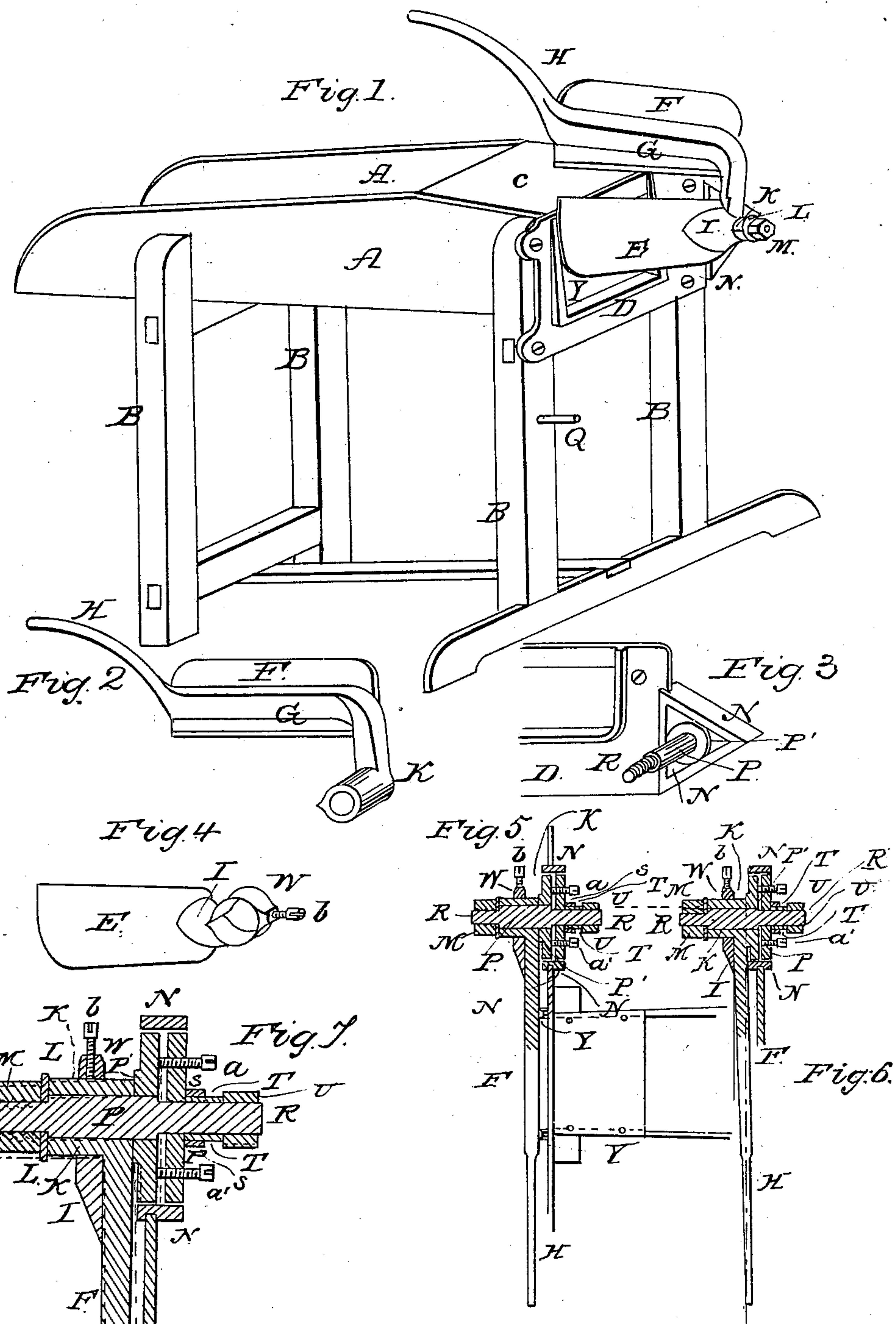

Witnesses
A. J. Morrison
Geo. E. Smith

Inventor
W. P. Goolman

UNITED STATES PATENT OFFICE.

W. P. GOOLMAN, OF INDIANAPOLIS, INDIANA, ASSIGNOR TO GOOLMAN,
MORRIS & CO., OF SAME PLACE.

STRAW-CUTTER.

Specification forming part of Letters Patent No. 44,042, dated August 30, 1864.

To all whom it may concern:

Be it known that I, W. P. GOOLMAN, of Indianapolis, Marion county, and State of Indiana, have invented a new and useful Machine for Cutting Straw, called "Goolman's Cutting-Box;" and I do hereby declare that the following is a full, clear, and exact description of the construction and operation of the same, reference being had to the annexed drawings, making a part of this specification, in which—

Figure 1 is a perspective view; Figs. 2, 3, and 4, details; and 5, 6, and 7 sections.

The nature of my invention consists in using a triangular box, N, through which passes the stud P. Attached to this stud is the lever F with knife G, the gage-plate E, which is fastened to the lever at K by means of the set-screw C.

P represents the stud, and P' the flanges of the same. 5, 6, and 7 represent the box N, and T the washer which presses upon the india-rubber packing X, between the box-ring S and the stud P.

W represents the ring of gage plate E, by means of which the plate is fastened to the lever at K.

R R represent the ends of stud, which are provided with a screw.

M and U are the nuts. L is the washer, and F is the lever, to which is attached the knife G.

D is the mouth-piece, with its projections Y, against which the knife G works in cutting the straw.

A A represent the box; C, the cover, and B B B the frame-work.

Q is the stop or check for the knife.

H is the handle of lever F.

X represents the india-rubber.

Operation: The tightening of the nut at the rearend of screw on stud P against the washer T and the rubber X causes the stud P to press against the three set-screws *a a a*, and permits any desired adjustment of the knife G to the mouth-piece D by changing any one or all the three screws.

I do not claim adjusting the knife by means of the set-screws *a a a*, for I am aware that this has been done before; but

What I claim, and desire to secure by Letters Patent of the United States, is—

The combination of the box N with the stud P and set-screws *a a a*, the elastic substance X, the washer T and nut U, all arranged and operating substantially as and for the purpose shown and described.

W. P. GOOLMAN.

Witnesses:

A. F. MORRISON,

JNO. L. SMITHMYER.