

S. G. Crane,
Convertible Chair.

N^o 32,822.

Patented July 16, 1861.

Fig: 1

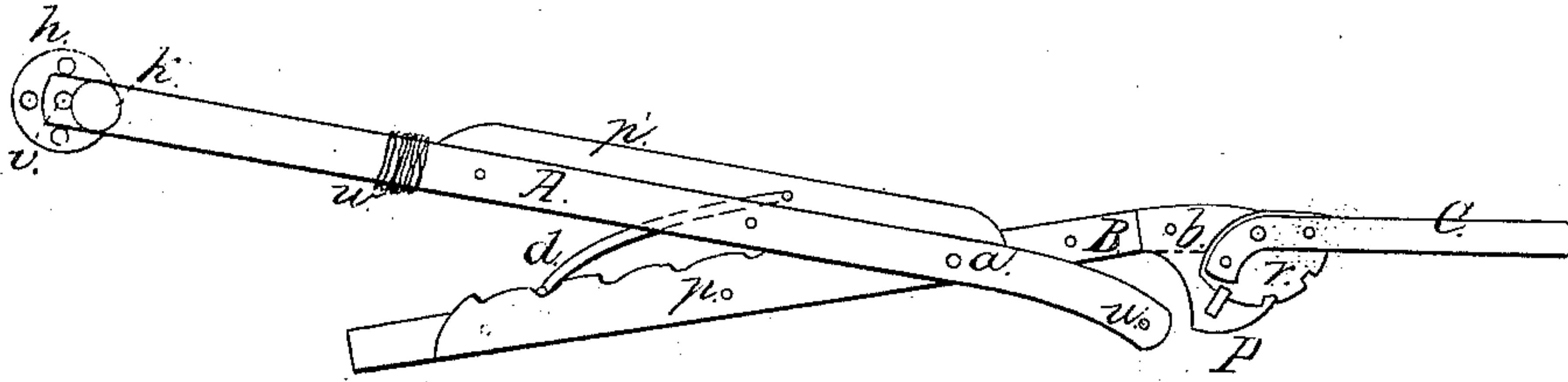

Fig: 2

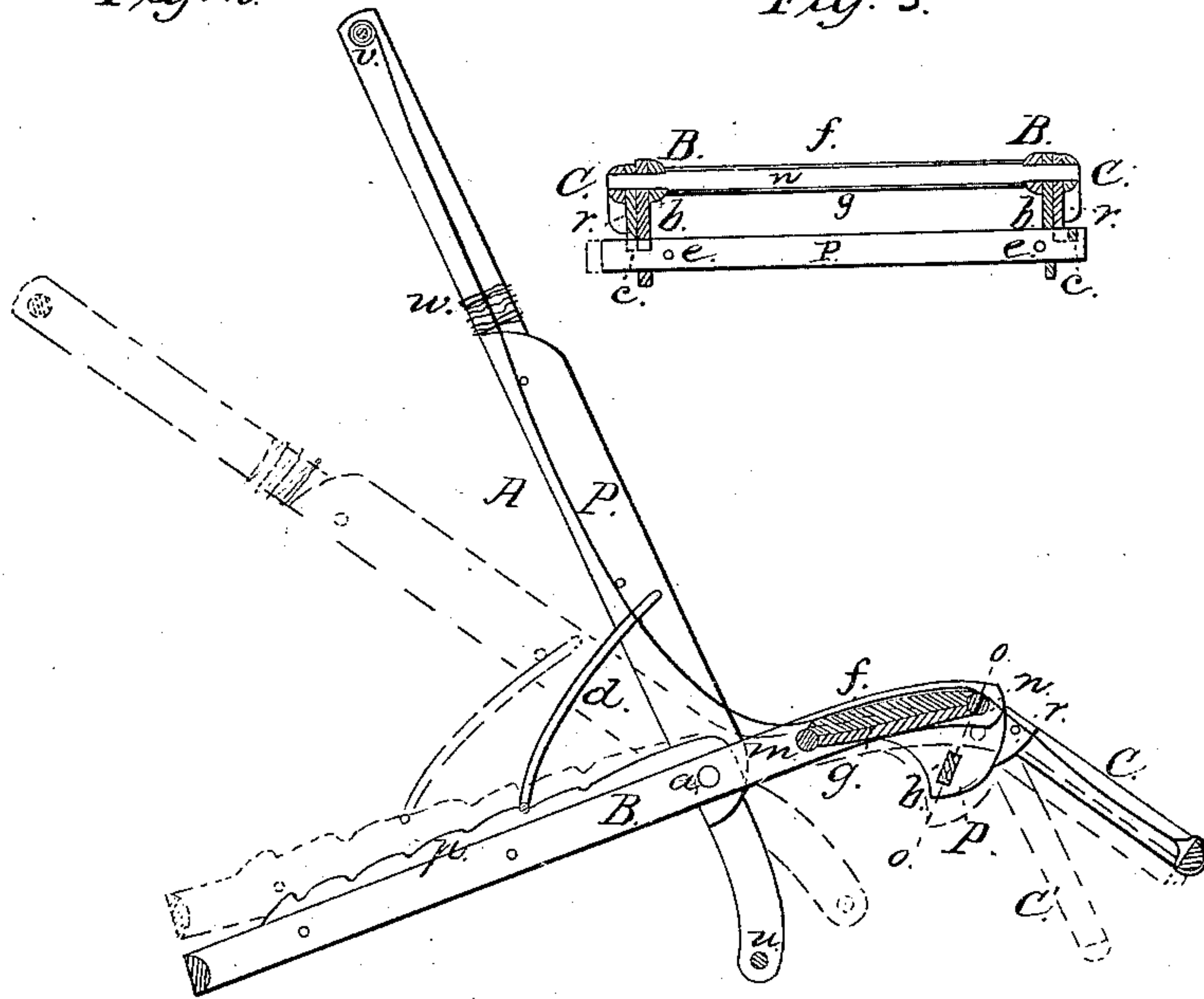

Fig: 3.



Witnesses:

S. J. Ellis
Wm. P. Loughborough

Inventor:

S. G. Crane

UNITED STATES PATENT OFFICE.

SAMUEL G. CRANE, OF ROCHESTER, NEW YORK.

COMBINATION CAMP BED AND CHAIR.

Specification of Letters Patent No. 32,822, dated July 16, 1861.

To all whom it may concern:

Be it known that I, SAMUEL G. CRANE, of Rochester, in the county of Monroe and State of New York, have invented a new and
5 useful Camp and Hospital Bed and Chair; and I do hereby declare that the following is a full, clear, and exact description thereof, reference being had to the accompanying drawings, making a part of this specifica-
10 tion, in which—

Figure 1, is a side elevation of the apparatus, in adjustment for a bed. Fig. 2, is a vertical, longitudinal, central section of the same, in adjustment for a chair. Fig. 3,
15 is a transverse section through the plane indicated by the red line *o*, in Fig. 2.

The nature of this invention will be understood by reference to the specification and drawings.

20 The frame is composed of two primary parts A, and B, (with their duplicates,) which are made of half round iron of suitable size, and are pivoted together at *a*, leaving the short leg of A, of sufficient
25 length to afford a proper elevation to the seat, (which is formed by the short leg of B, it being slightly curved,) when the apparatus is adjusted for a chair. A, and B, are strengthened to resist vertical strains, by
30 riveting onto their flat sides the plates *p* and *p'*. The sides A, are connected by the rods *u*, and *v*. The rod *v*, is encircled by a tube, to which the upper end of the canvas, (represented by the red curved line in Fig.
35 2,) is attached, the other end being connected to the cross-bar of the extension C. Said tube has a head *h*, on one end which is pierced with several holes to receive the key
40 *h*, the stem of which passes through the side A. By means of this roller and its key, the canvas may be drawn up to any degree of tension desired, or the slack may be taken up when the apparatus is adjusted for a chair.

45 *w*, is a cross-band, or support, of webbing, extending from one side of the frame to the other, and to which its ends are attached.

The sides B, are a continuation of the same bar, bent across at the foot, or lower end,

and they are "tied" at the upper end by the
50 rods *m*, and *n*, upon which the seat rests. Said seat is composed of two boards, *f*, and *g*, their edges partially overlapping the rods *m*, and *n*, where they are held by screws.

The adjustable extension, or foot and leg
55 rest C, is formed similar to the frame B, but of lighter iron, and it is pivoted to B, by the ends of the rod *n*, as seen in Fig. 3. The key P, slides in a mortise through each of the plates *b*, which are riveted to the
60 frame B. The plates *r*, are fixed to the sides of the extension C, and they have several notches in their circular edge, into any one of which the key P, may be put, to hold
65 the rest, or extension C, in any desired position. When a change is to be made, the key P, must be moved to the left, as shown by the dotted lines in Fig. 3, when the
70 notches *c*, will register to the plates *r*, and allow the rest to be elevated or depressed to any desired point, when the key must be moved back to its present position.

The frame A is firmly held in position by means of the cross-rod of the pawls *d*, resting in the notches of the plates *p*, the said
75 pawls being hinged to the plates *p'*.

In folding the apparatus for transportation, the frame A, should be let down to the last notch, and the rest, or extension C, folded over upon the seat, thus rendering
80 it extremely portable, and well adapted for general camp use, as a bed and chair combined; and on account of the various angles of adjustment, to which the several parts are adapted, it is rendered specially de-
85 sirable for hospital use.

What I claim as my invention and desire to secure by Letters Patent is—

The combination of the frames A and B with the pawls and cross rod *d*, the adjust-
90 able roller and head *h*, the graduated extension C, by the key P, and plates *r*, substantially as and for the purpose specified.

S. G. CRANE.

Witnesses:

S. J. ALLIS,

WM. S. LOUGHBOROUGH.