

J. G. CUMMINGS.

Plow.

No. 18,682.

Patented Nov. 24, 1857.

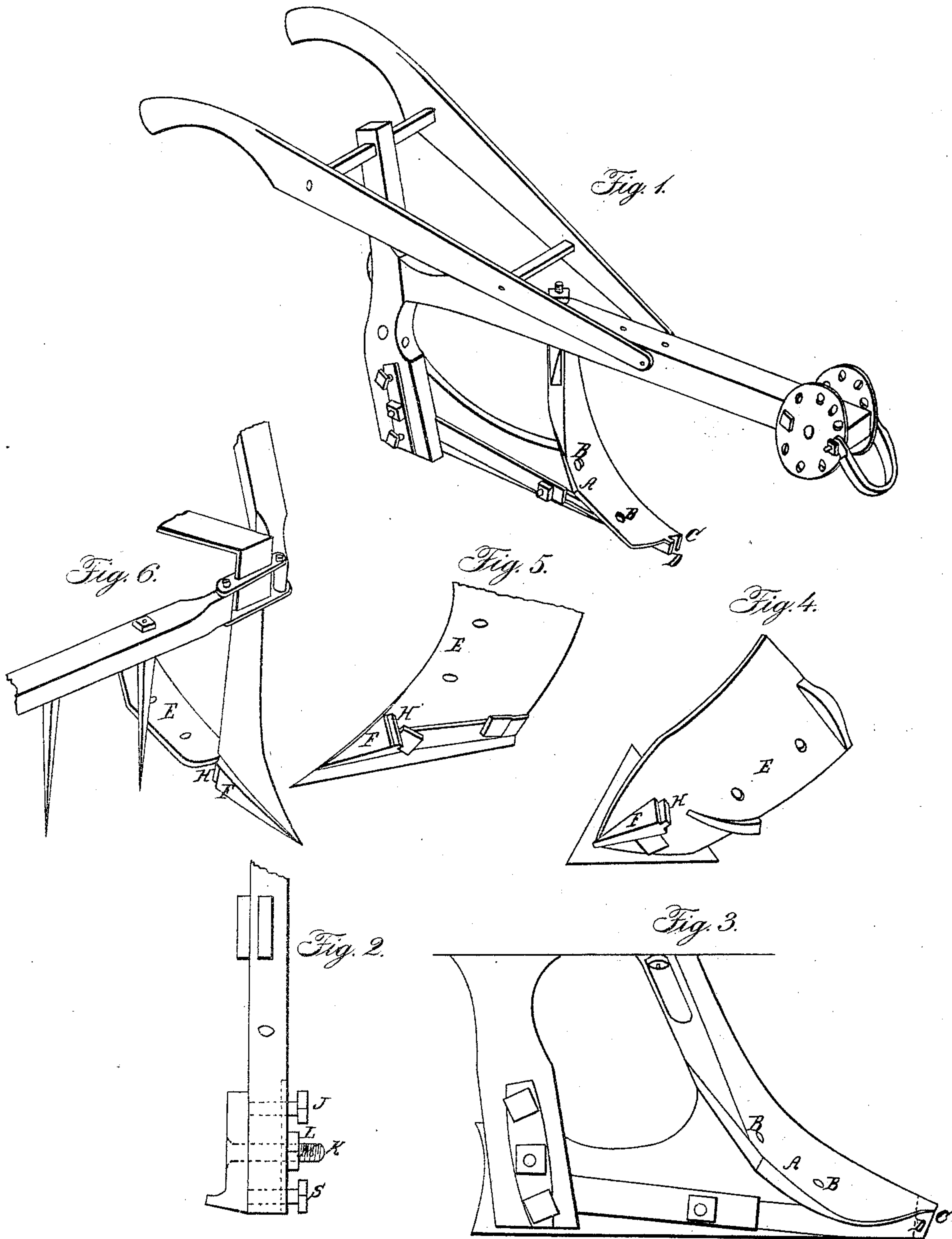

# UNITED STATES PATENT OFFICE.

JAMES G. CUMMINGS, OF COLUMBUS, MISSISSIPPI.

## IMPROVEMENT IN PLOWS.

Specification forming part of Letters Patent No. **18,682**, dated November 24, 1857.

*To all whom it may concern:*

Be it known that I, JAMES G. CUMMINGS, of Columbus, in the county of Lowndes and State of Mississippi, have invented an Improvement in Plows; and I do hereby declare that the following is a full, clear, and exact description of the principle or character which distinguishes it from all other things before known, and of the usual manner of making, modifying, and using the same, reference being had to the annexed drawings, of which—

Figure 1 represents a perspective view of the plow; Fig. 2, an end view, showing the manner of adjusting the mold-boards; Fig. 3, an enlarged view of the plow-body; Figs. 4, 5, and 6, views of the cutters to be attached.

The first part of my invention consists in a peculiar construction of a plow by which, in connection with a peculiar construction or adaptation of varieties of cutters and mold-boards, I am enabled to vary the construction and operation of the plow so as to save the necessity of using a number of different plows for different kinds of work. To effect this I make a lateral expansion, A, of the standard of the plow, provided with bolt-holes B, and this expansion of the standard is made solid with the landside. The nose C of the plow is provided with a vertical groove, D, and on each of the cutters and mold-boards to be attached there is a flange, E, with bolts and holes to correspond with the bolt-holes in the expansion A, and also a pro-

jection, F, provided with a tongue, H, which fits the groove D. By this arrangement one plow-frame may be made to answer for a variety of operations.

The second part of my invention consists in a mode of adjusting the mold-board so as to vary its angle, as follows: The heel of the landside is provided with a screw-bolt, K, which passes through the heel-post, and has a nut, L, on its projecting end M. Above and below the bolt are set-screws K J S, which pass through the heel-post, and their ends abut against the landside, and by varying the set of these three screws a variety of positions can be given to the landside, and thus alter the inclination of the mold-board to suit the various kinds of soil.

Figs. 4, 5, and 6 represent different kinds of cutters, with the flange and projecting piece, with the tongue attached.

What I claim as my improvement is—

1. The mode of making the plow-standard to carry the variety of cutters and mold-boards, the same consisting in the expansion of the standard at the point A, in combination with the groove in the nose of the plow, as set forth.

2. The compound adjustment of the mold-board by the three set-screws K J S, operating upon the heel of the landside, as set forth.

JAMES G. CUMMINGS.

Witnesses:

DAVID WOOD,  
JAMES L. LONG.